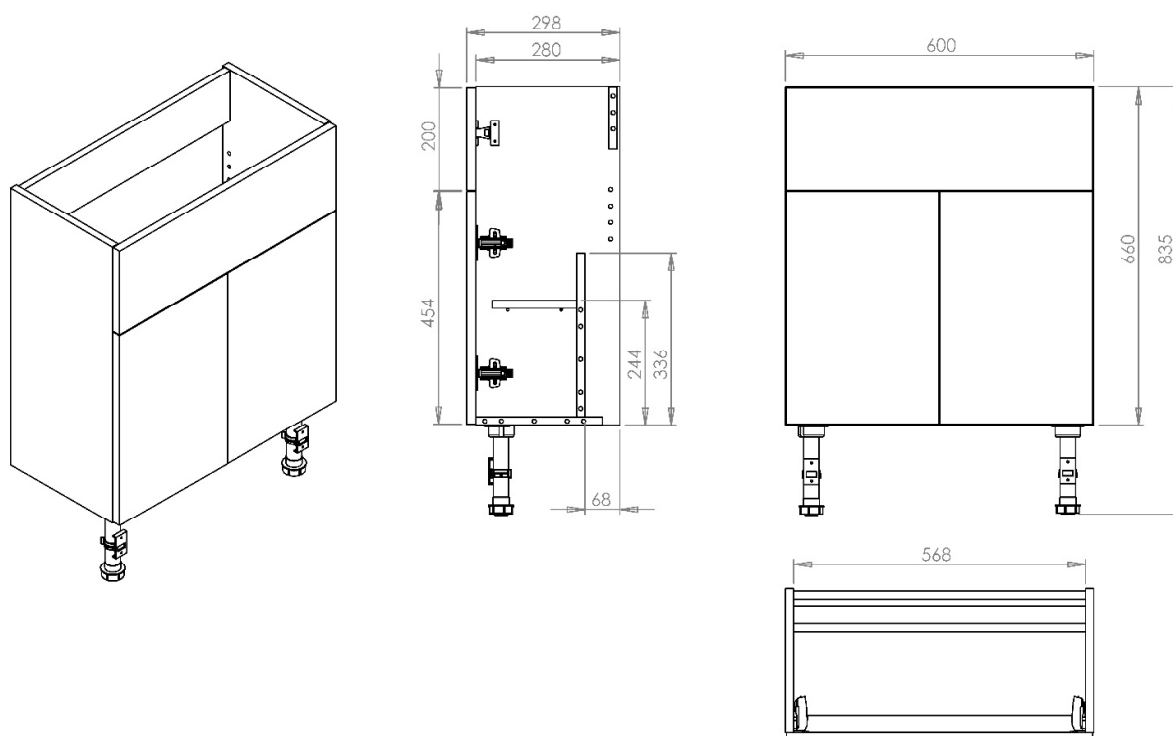

QUBE | QUBE EDGE FITTED – 600mm Standard Depth Washbasin**QBE605**, QBE606****

All dimension in mm. Please check dimensions prior to installation as they can vary due to manufacturing tolerances.

Product Details

Type:	Fitted Standard Depth Washbasin Unit
Width:	600
Depth:	298
Height:	835
Product Weight*:	20.5kg
Tolerances:	+/- 2mm
Guarantee Period:	5 Years (For Domestic Use) 1 Years (For Commercial Use)
Drawer Box Capacity:	N/A

Product Specification

Fascia Material:	18mm MFC
Carcass Material:	18mm MFC
Opening Mechanism:	Pull (Handle Sold Separately)
Trim Options:	N/A
Adjustable Legs:	Yes
Quantity of Shelves:	1 Plus Base
Shelving Type:	MFC
Handing:	N/A

*Product Weight includes packaging.

Features

- FSC Certified
- Soft Close
- Assembled

Additional Documentation

Additional Documentation available on our website www.utopiagroup.com

Every effort has been made to ensure that the information provided on this document is correct at the time of creation. Finally, Utopia Furniture Ltd reserve the right to alter materials and specifications in line with continuing programme of production and service development.

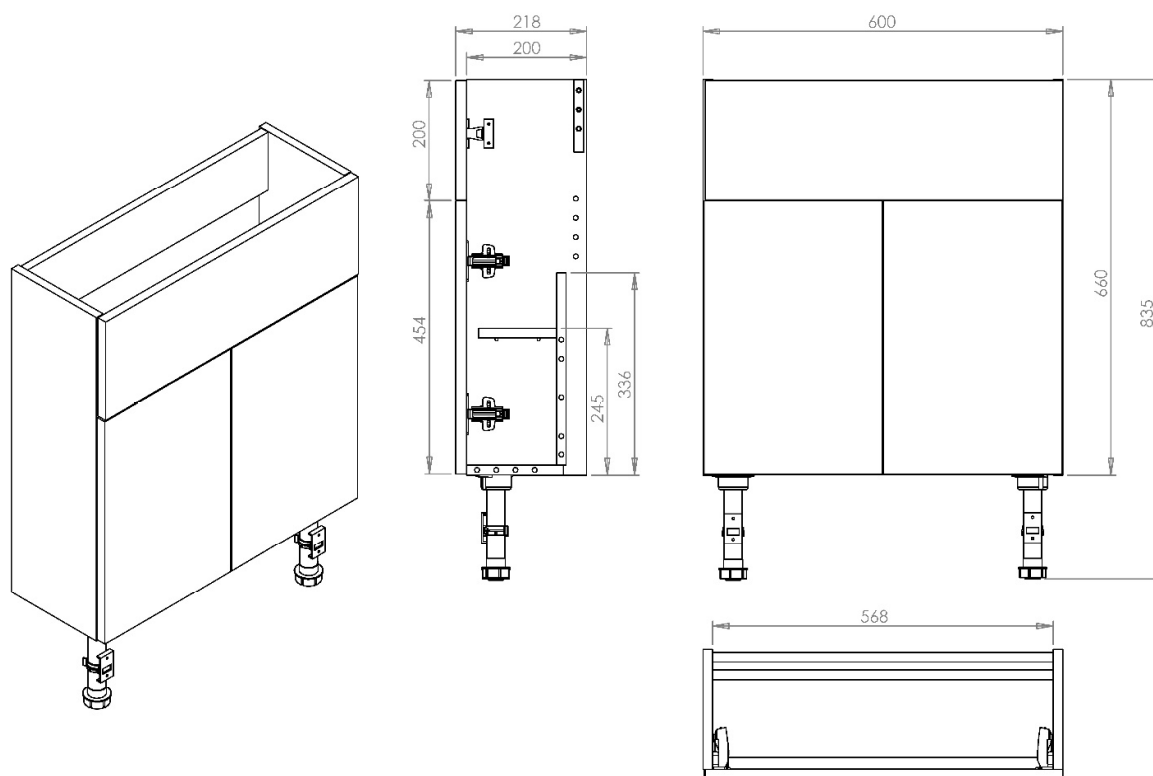
QUBE | QUBE EDGE FITTED – 600mm Reduced Depth Washbasin**QBE607**, QBE608****

All dimension in mm. Please check dimensions prior to installation as they can vary due to manufacturing tolerances.

Product Details

Type:	Fitted Reduced Depth Washbasin Unit
Width:	600
Depth:	218
Height:	835
Product Weight*:	20.5kg
Tolerances:	+/- 2mm
Guarantee Period:	5 Years (For Domestic Use) 1 Years (For Commercial Use)
Drawer Box Capacity:	N/A

Product Specification

Fascia Material:	18mm MFC
Carcass Material:	18mm MFC
Opening Mechanism:	Pull (Handle Sold Separately)
Trim Options:	N/A
Adjustable Legs:	Yes
Quantity of Shelves:	1 Plus Base
Shelving Type:	MFC
Handing:	N/A

*Product Weight includes packaging.

Features

- FSC Certified
- Soft Close
- Assembled

Additional Documentation

Additional Documentation available on our website www.utopiagroup.com

Every effort has been made to ensure that the information provided on this document is correct at the time of creation. Finally, Utopia Furniture Ltd reserve the right to alter materials and specifications in line with continuing programme of production and service development.

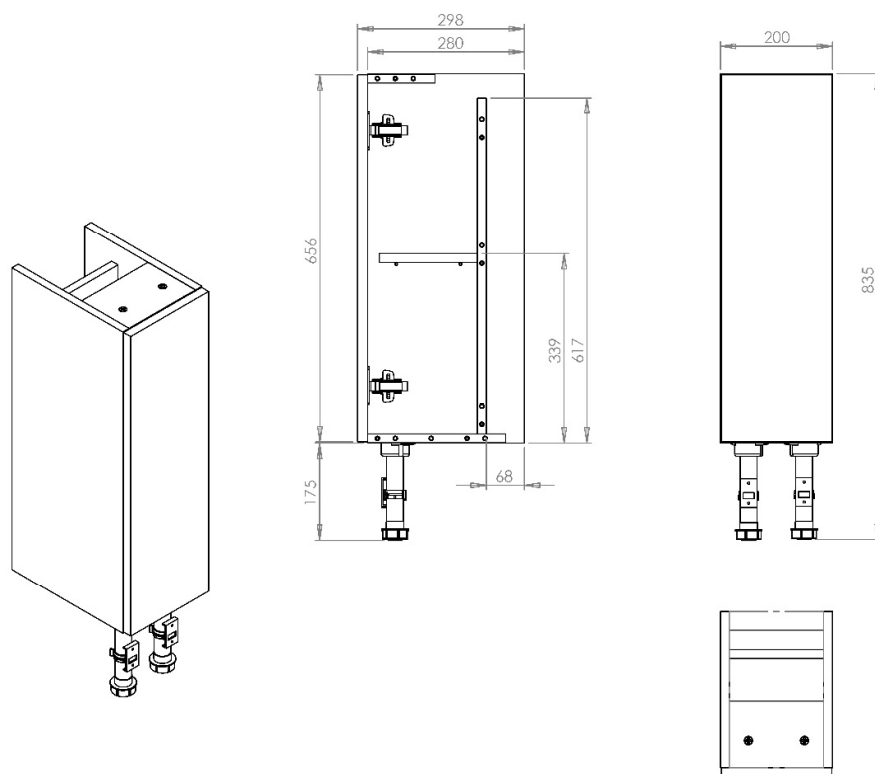
QUBE | QUBE EDGE FITTED- 200mm Standard Depth Washbasin**QBE609**, QBE613**, QBE610**, QBE614****

All dimension in mm. Please check dimensions prior to installation as they can vary due to manufacturing tolerances.

Product Details

Type:	Fitted Standard Depth Single Base Unit
Width:	200
Depth:	298
Height:	835
Product Weight*:	8kg
Tolerances:	+/- 2mm
Guarantee Period:	5 Years (For Domestic Use) 1 Years (For Commercial Use)
Drawer Box Capacity:	N/A

Product Specification

Fascia Material:	18mm MFC
Carcass Material:	18mm MFC
Opening Mechanism:	Pull (Handle Sold Separately)
Trim Options:	N/A
Adjustable Legs:	Yes
Quantity of Shelves:	1 Plus Base
Shelving Type:	MFC
Handing:	Available Left or Right Hand

*Product Weight includes packaging.

Features

- FSC Certified
- Soft Close
- Assembled

Additional Documentation

Additional Documentation available on our website www.utopiagroup.com

Every effort has been made to ensure that the information provided on this document is correct at the time of creation. Finally, Utopia Furniture Ltd reserve the right to alter materials and specifications in line with continuing programme of production and service development.

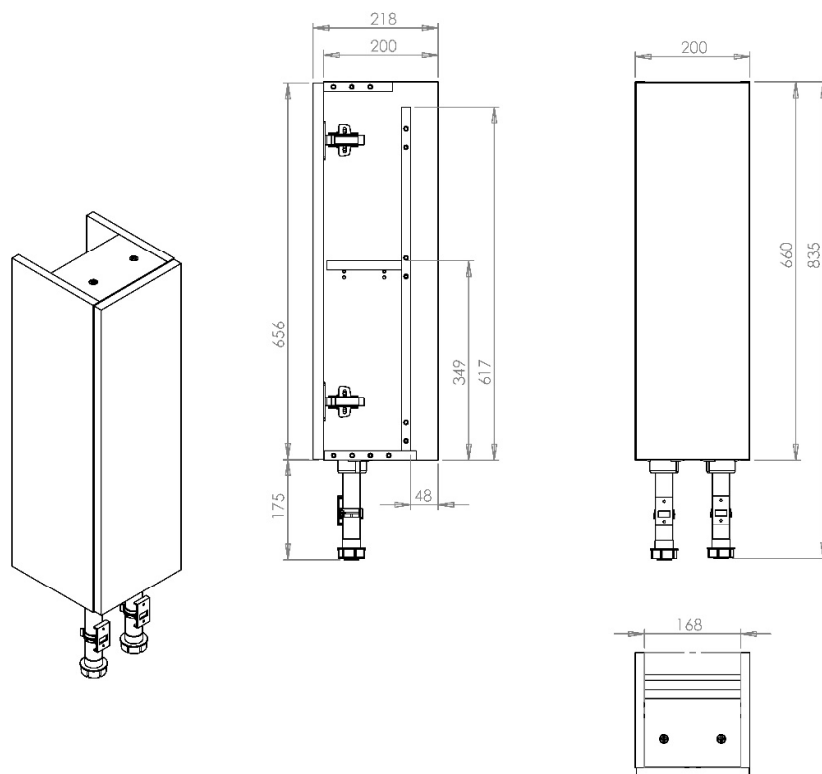
QUBE | QUBE EDGE FITTED – 200mm Reduced Depth Washbasin**QBE611**, QBE615**, QBE612**, QBE616****

All dimension in mm. Please check dimensions prior to installation as they can vary due to manufacturing tolerances.

Product Details

Type:	Fitted Reduced Depth Single Base Unit
Width:	200
Depth:	218
Height:	835
Product Weight*:	7.5kg
Tolerances:	+/- 2mm
Guarantee Period:	5 Years (For Domestic Use) 1 Years (For Commercial Use)
Drawer Box Capacity:	N/A

Product Specification

Fascia Material:	18mm MFC
Carcass Material:	18mm MFC
Opening Mechanism:	Pull (Handle Sold Separately)
Trim Options:	N/A
Adjustable Legs:	Yes
Quantity of Shelves:	1 Plus Base
Shelving Type:	MFC
Handing:	Available Left or Right Hand

*Product Weight includes packaging.

Features

- FSC Certified
- Soft Close
- Assembled

Additional Documentation

Additional Documentation available on our website www.utopiagroup.com

Every effort has been made to ensure that the information provided on this document is correct at the time of creation. Finally, Utopia Furniture Ltd reserve the right to alter materials and specifications in line with continuing programme of production and service development.

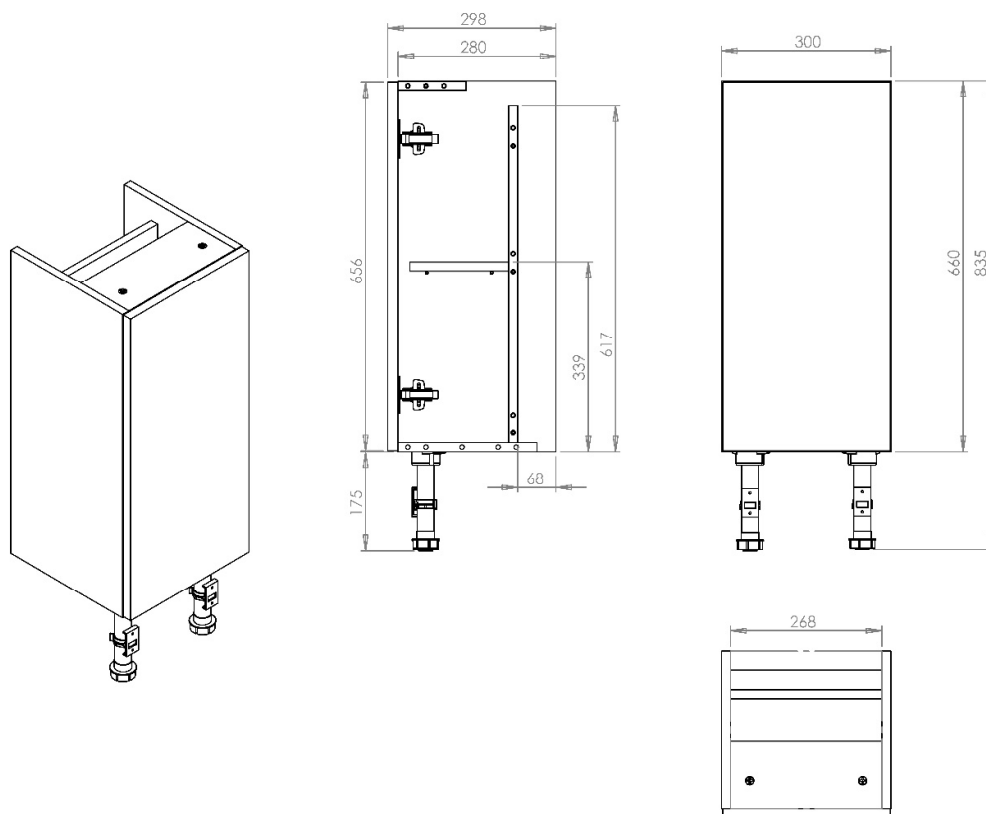
QUBE | QUBE EDGE FITTED- 300mm Standard Depth Washbasin**QBE617**, QBE621**, QBE618**, QBE622****

All dimension in mm. Please check dimensions prior to installation as they can vary due to manufacturing tolerances.

Product Details

Type:	Fitted Standard Depth Single Base Unit
Width:	300
Depth:	298
Height:	835
Product Weight*:	8kg
Tolerances:	+/- 2mm
Guarantee Period:	5 Years (For Domestic Use) 1 Years (For Commercial Use)
Drawer Box Capacity:	N/A

Product Specification

Fascia Material:	18mm MFC
Carcass Material:	18mm MFC
Opening Mechanism:	Pull (Handle Sold Separately)
Trim Options:	N/A
Adjustable Legs:	Yes
Quantity of Shelves:	1 Plus Base
Shelving Type:	MFC
Handing:	Available Left or Right Hand

*Product Weight includes packaging.

Features

- FSC Certified
- Soft Close
- Assembled

Additional Documentation

Additional Documentation available on our website www.utopiagroup.com

Every effort has been made to ensure that the information provided on this document is correct at the time of creation. Finally, Utopia Furniture Ltd reserve the right to alter materials and specifications in line with continuing programme of production and service development.

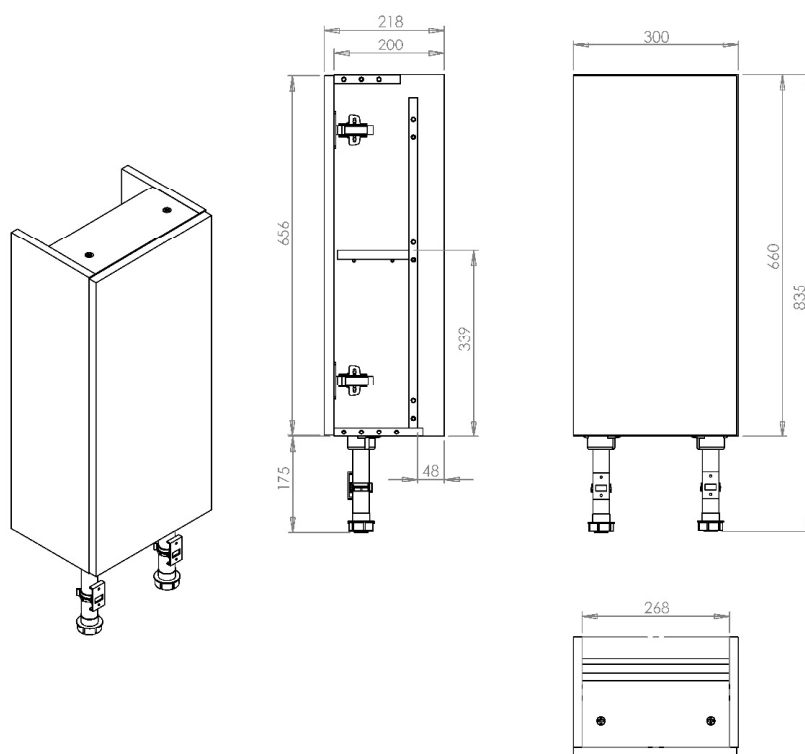
QUBE | QUBE EDGE FITTED – 300mm Reduced Depth Washbasin**QBE619**, QBE623**, QBE620**, QBE624****

All dimension in mm. Please check dimensions prior to installation as they can vary due to manufacturing tolerances.

Product Details

Type:	Fitted Reduced Depth Single Base Unit
Width:	300
Depth:	218
Height:	835
Product Weight*:	7.5kg
Tolerances:	+/- 2mm
Guarantee Period:	5 Years (For Domestic Use) 1 Years (For Commercial Use)
Drawer Box Capacity:	N/A

Product Specification

Fascia Material:	18mm MFC
Carcass Material:	18mm MFC
Opening Mechanism:	Pull (Handle Sold Separately)
Trim Options:	N/A
Adjustable Legs:	Yes
Quantity of Shelves:	1 Plus Base
Shelving Type:	MFC
Handing:	Available Left or Right Hand

*Product Weight includes packaging.

Features

- FSC Certified
- Soft Close
- Assembled

Additional Documentation

Additional Documentation available on our website www.utopiagroup.com

Every effort has been made to ensure that the information provided on this document is correct at the time of creation. Finally, Utopia Furniture Ltd reserve the right to alter materials and specifications in line with continuing programme of production and service development.

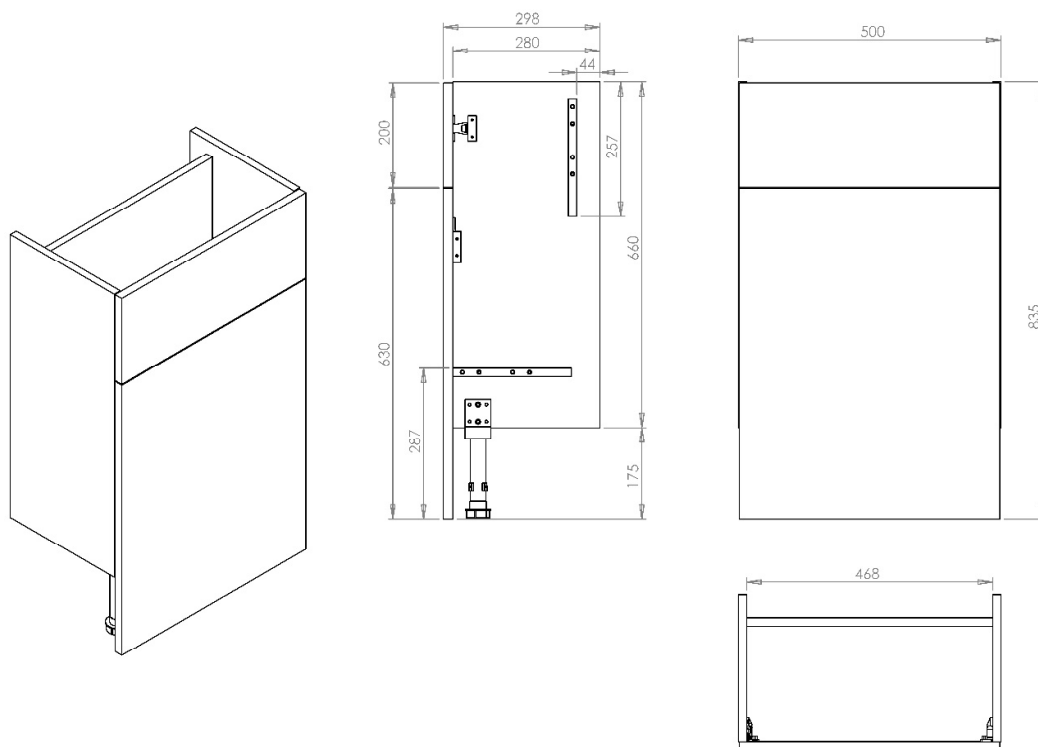
QUBE | QUBE EDGE FITTED- 500mm Standard Depth WC Unit**QBE625** (Exc Cistern), QBE626** (Exc Cistern), QBE627** (Inc Cistern), QBE628** (Inc Cistern)**

All dimension in mm. Please check dimensions prior to installation as they can vary due to manufacturing tolerances.

Product Details

Type:	Fitted Standard Depth WC Unit
Width:	500
Depth:	298
Height:	835
Product Weight*:	13kg (Exc Cistern), 14kg (Inc Cistern)
Tolerances:	+/- 2mm
Guarantee Period:	5 Years (For Domestic Use) 1 Years (For Commercial Use)
Drawer Box Capacity:	N/A

Product Specification

Fascia Material:	18mm MFC
Carcass Material:	18mm MFC
Opening Mechanism:	Pull (Handle Sold Separately)
Trim Options:	N/A
Adjustable Legs:	Yes
Quantity of Shelves:	N/A
Shelving Type:	N/A
Handing:	N/A

*Product Weight includes packaging.

Features

- FSC Certified
- Assembled

Additional Documentation

Additional Documentation available on our website www.utopiagroup.com

Every effort has been made to ensure that the information provided on this document is correct at the time of creation. Finally, Utopia Furniture Ltd reserve the right to alter materials and specifications in line with continuing programme of production and service development.

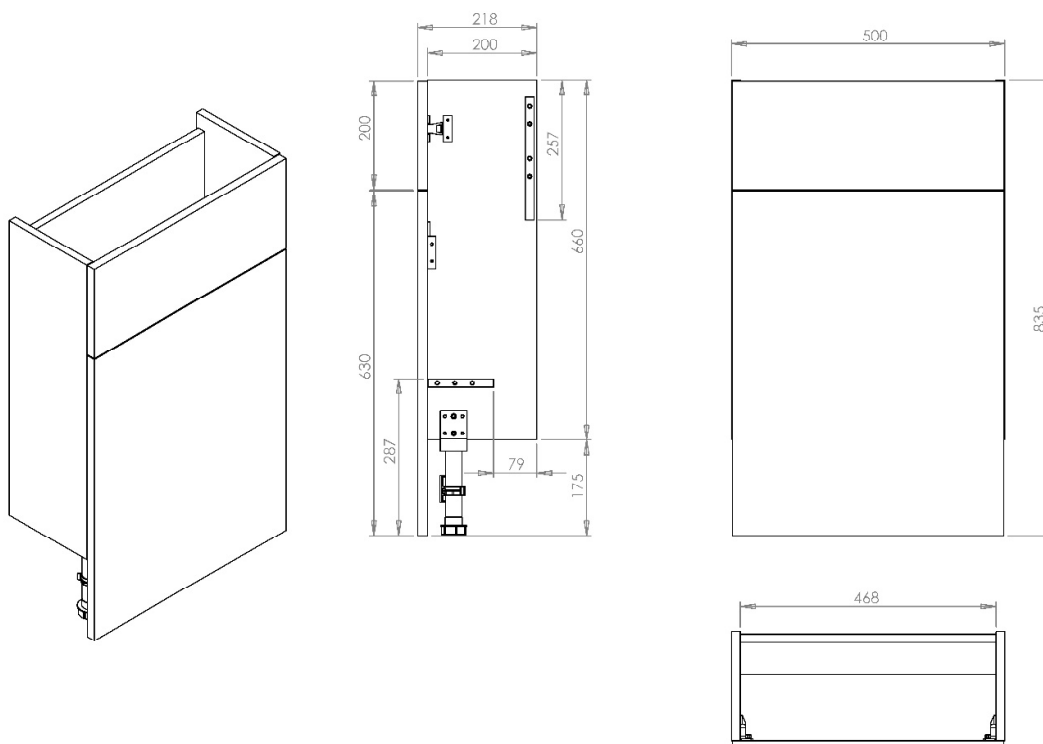
QUBE | QUBE EDGE FITTED- 500mm Reduced Depth WC Unit**QBE629** (Exc Cistern), QBE6310** (Exc Cistern), QBE631** (Inc Cistern), QBE631** (Inc Cistern)**

All dimension in mm. Please check dimensions prior to installation as they can vary due to manufacturing tolerances.

Product Details

Type:	Fitted Reduced Depth WC Unit
Width:	500
Depth:	218
Height:	835
Product Weight*:	12kg (Exc Cistern), 13kg (Inc Cistern)
Tolerances:	+/- 2mm
Guarantee Period:	5 Years (For Domestic Use) 1 Years (For Commercial Use)
Drawer Box Capacity:	N/A

Product Specification

Fascia Material:	18mm MFC
Carcass Material:	18mm MFC
Opening Mechanism:	Pull (Handle Sold Separately)
Trim Options:	N/A
Adjustable Legs:	Yes
Quantity of Shelves:	N/A
Shelving Type:	N/A
Handing:	N/A

*Product Weight includes packaging.

Features

- FSC Certified
- Assembled

Additional Documentation

Additional Documentation available on our website www.utopiagroup.com

Every effort has been made to ensure that the information provided on this document is correct at the time of creation. Finally, Utopia Furniture Ltd reserve the right to alter materials and specifications in line with continuing programme of production and service development.

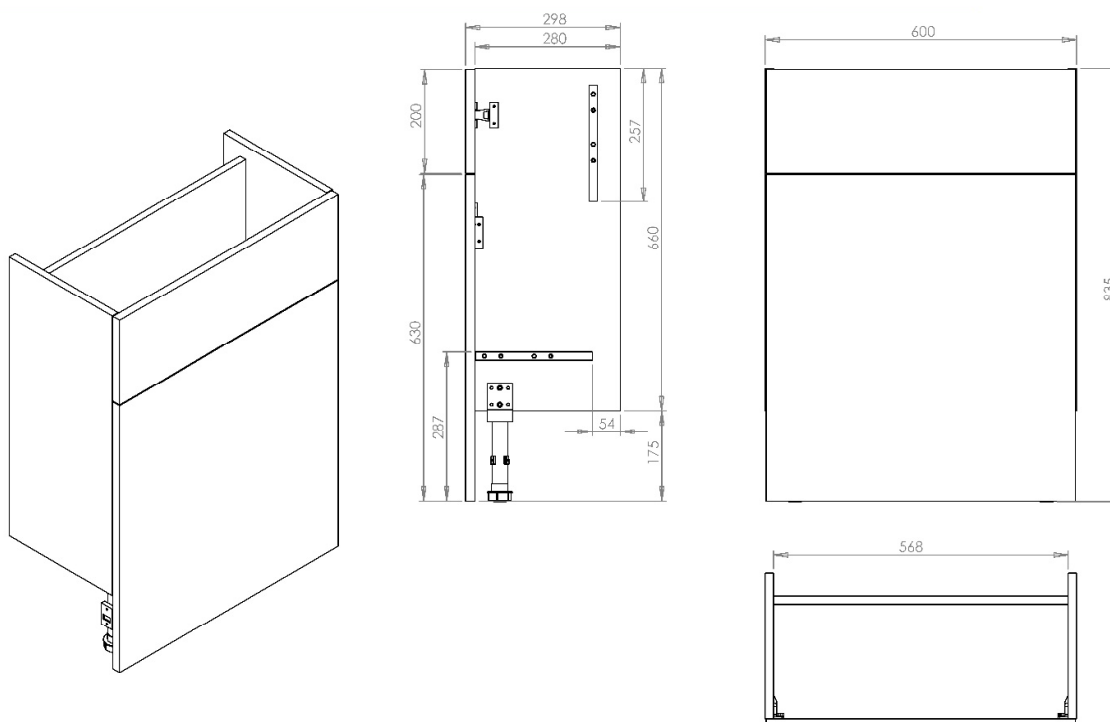
QUBE | QUBE EDGE FITTED – 600mm Standard Depth WC Unit**QBE633** (Exc Cistern), QBE634** (Exc Cistern), QBE635** (Inc Cistern), QBE636** (Inc Cistern)**

All dimension in mm. Please check dimensions prior to installation as they can vary due to manufacturing tolerances.

Product Details

Type:	Fitted Standard Depth WC Unit
Width:	600
Depth:	298
Height:	835
Product Weight*:	13.5kg (Exc Cistern), 14.5kg (Inc Cistern)
Tolerances:	+/- 2mm
Guarantee Period:	5 Years (For Domestic Use) 1 Years (For Commercial Use)
Drawer Box Capacity:	N/A

Product Specification

Fascia Material:	18mm MFC
Carcass Material:	18mm MFC
Opening Mechanism:	Pull (Handle Sold Separately)
Trim Options:	N/A
Adjustable Legs:	Yes
Quantity of Shelves:	N/A
Shelving Type:	N/A
Handing:	N/A

*Product Weight includes packaging.

Features

- FSC Certified
- Assembled

Additional DocumentationAdditional Documentation available on our website www.utopiagroup.com

Every effort has been made to ensure that the information provided on this document is correct at the time of creation. Finally, Utopia Furniture Ltd reserve the right to alter materials and specifications in line with continuing programme of production and service development.

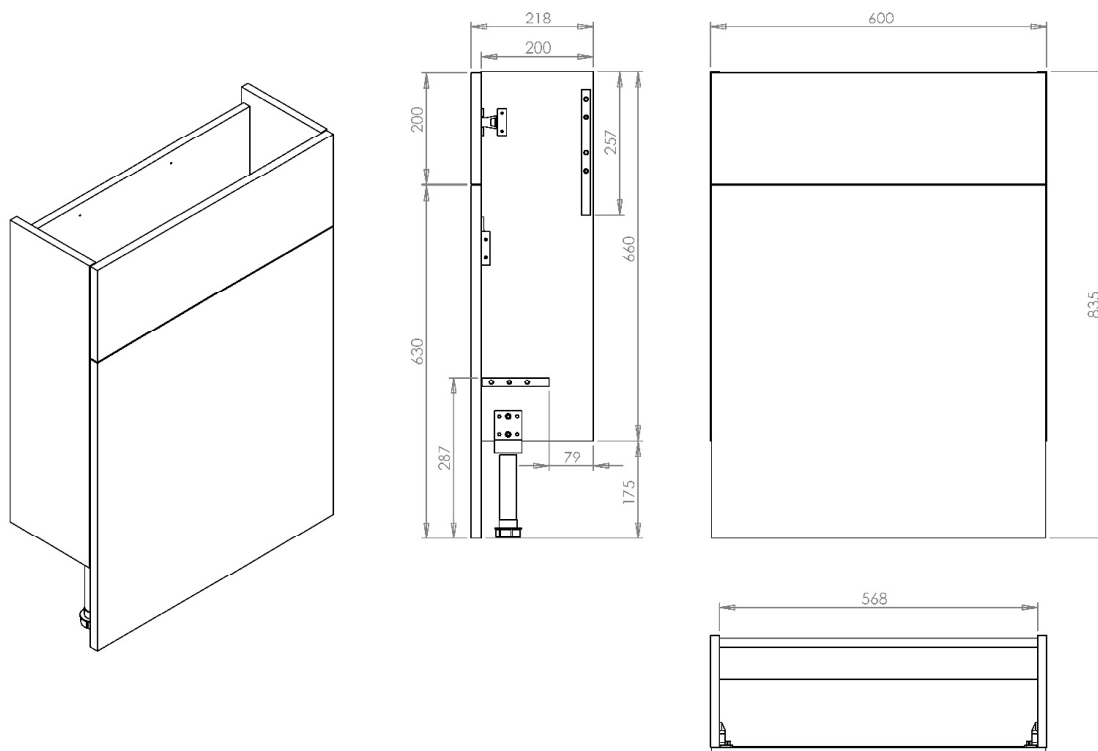
QUBE | QUBE EDGE FITTED – 600mm Reduced Depth WC Unit**QBE637** (Exc Cistern), QBE638** (Exc Cistern), QBE639** (Inc Cistern), QBE640** (Inc Cistern)**

All dimension in mm. Please check dimensions prior to installation as they can vary due to manufacturing tolerances.

Product Details

Type:	Fitted Reduced Depth WC Unit
Width:	600
Depth:	218
Height:	835
Product Weight*:	12.5kg (Exc Cistern), 13.5kg (Inc Cistern)
Tolerances:	+/- 2mm
Guarantee Period:	5 Years (For Domestic Use) 1 Years (For Commercial Use)
Drawer Box Capacity:	N/A

Product Specification

Fascia Material:	18mm MFC
Carcass Material:	18mm MFC
Opening Mechanism:	Pull (Handle Sold Separately)
Trim Options:	N/A
Adjustable Legs:	Yes
Quantity of Shelves:	N/A
Shelving Type:	N/A
Handing:	N/A

*Product Weight includes packaging.

Features

- FSC Certified
- Assembled

Additional Documentation

Additional Documentation available on our website www.utopiagroup.com

Every effort has been made to ensure that the information provided on this document is correct at the time of creation. Finally, Utopia Furniture Ltd reserve the right to alter materials and specifications in line with continuing programme of production and service development.

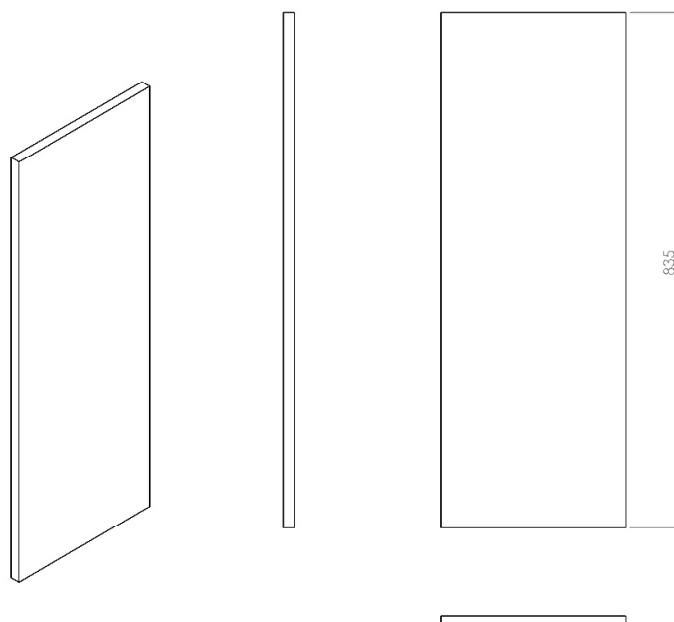
QUBE | QUBE EDGE FITTED – Cladding Panels (18mm MFC)**QBE641**, QBE642****

Product Code	Depth	Weight
QBE641/**	300	3.713Kg
QBE642/**	220	2.475Kg

All dimension in mm. Please check dimensions prior to installation as they can vary due to manufacturing tolerances.

Product Details

Type:	Fitted Reduced Depth Single Base Unit
Width:	18
Depth:	See Table
Height:	835
Product Weight*:	See Table
Tolerances:	+/- 2mm
Guarantee Period:	5 Years (For Domestic Use) 1 Years (For Commercial Use)
Drawer Box Capacity:	N/A

Product Specification

Fascia Material:	N/A
Carcass Material:	18mm MFC
Opening Mechanism:	N/A
Trim Options:	N/A
Adjustable Legs:	N/A
Quantity of Shelves:	N/A
Shelving Type:	N/A
Handing:	N/A

*Product Weight includes packaging.

Features

- FSC Certified

Additional Documentation

Additional Documentation available on our website www.utopiagroup.com

Every effort has been made to ensure that the information provided on this document is correct at the time of creation. Finally, Utopia Furniture Ltd reserve the right to alter materials and specifications in line with continuing programme of production and service development.

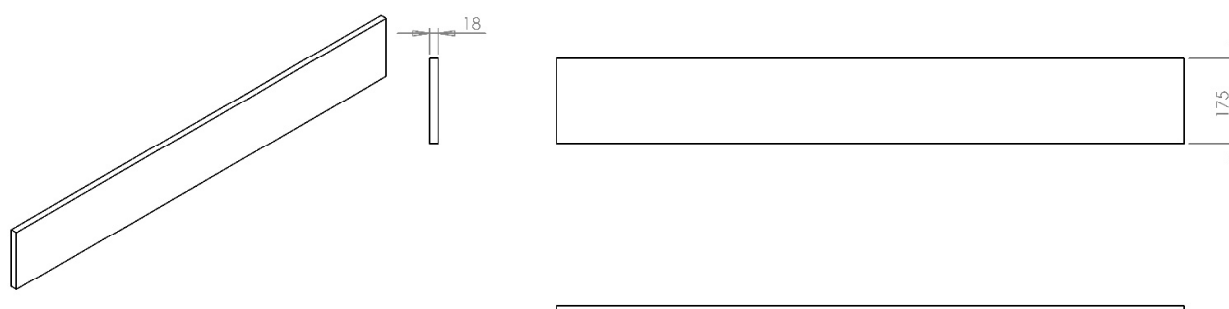
QUBE | QUBE EDGE FITTED – Plinth (18mm MFC)**QBE643**, QBE644****

Product Code	Width	Weight
QBE643/**	1300	3.372Kg
QBE644/**	1700	3.845Kg

All dimension in mm. Please check dimensions prior to installation as they can vary due to manufacturing tolerances.

Product Details

Type:	Fitted Reduced Depth Single Base Unit
Width:	See Table
Depth:	18
Height:	175
Product Weight*:	See Table
Tolerances:	+/- 2mm
Guarantee Period:	5 Years (For Domestic Use) 1 Years (For Commercial Use)
Drawer Box Capacity:	N/A

Product Specification

Fascia Material:	N/A
Carcass Material:	18mm MFC
Opening Mechanism:	N/A
Trim Options:	N/A
Adjustable Legs:	N/A
Quantity of Shelves:	N/A
Shelving Type:	N/A
Handing:	N/A

*Product Weight includes packaging.

Features

- FSC Certified

Additional Documentation

Additional Documentation available on our website www.utopiagroup.com

Every effort has been made to ensure that the information provided on this document is correct at the time of creation. Finally, Utopia Furniture Ltd reserve the right to alter materials and specifications in line with continuing programme of production and service development.