

Spares Diagram



Bathroom Perfection

QUBE | QUBE FITTED – 600mm Standard Depth Washbasin Unit

QBE605**, QBE606**

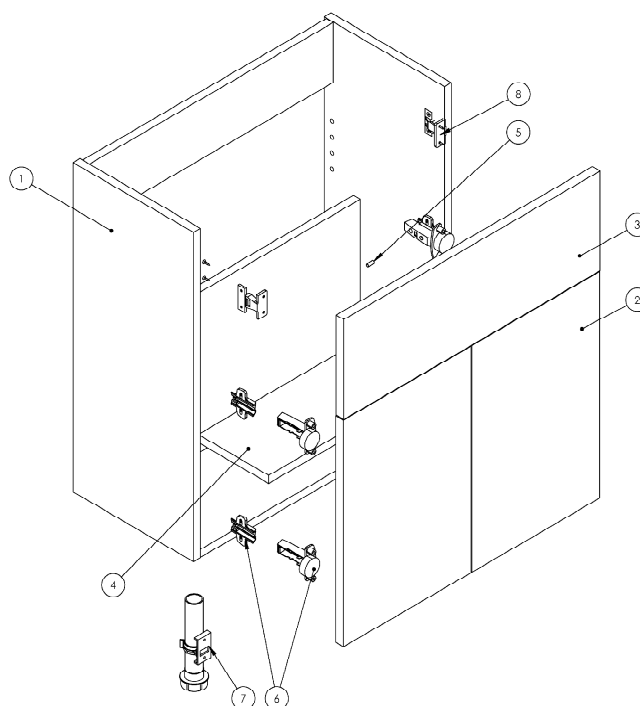

| Number | Part Code | Part Description |
|--------|---------------|---|
| 1 | CA0857 | QUBE 600 STANDARD DEPTH WBU - CARCASS ONLY |
| 2 | DR0340 | 600 WASHBASIN DOOR 297 X 454 (18MM MFC) |
| 3 | FA0228 | 600 WASHBASIN FASCIA 596 X 200 (18MM MFC) |
| 4 | SH0004 | SHELF (18MM MFC) |
| 5 | 800.FIT.00007 | 5MM NICKEL SHELF PEG |
| 6 | 800.HIN.00019 | 2 X HINGE (1 X SC ONLY) C/W PLATES & COVERS KIT |
| 7 | 800.FIT.00010 | ADJUSTABLE LEG BAG AND FITTINGS |
| 8 | 800.ACC.00017 | PUSHFIT KEKU |

Where applicable please note when ordering unit frontage's or carcasses, the style and colour will need to be specified.

Additional Documentation

Additional Documentation available on our website www.utopiagroup.com.

Every effort has been made to ensure that the information provided on this document is correct at the time of creation. Finally, Utopia Furniture Ltd reserve the right to alter materials and specifications in line with continuing programme of production and service development.

Spares Diagram



Bathroom Perfection

QUBE | QUBE FITTED – 600mm Reduced Depth Washbasin Unit

QBE607**, QBE608**

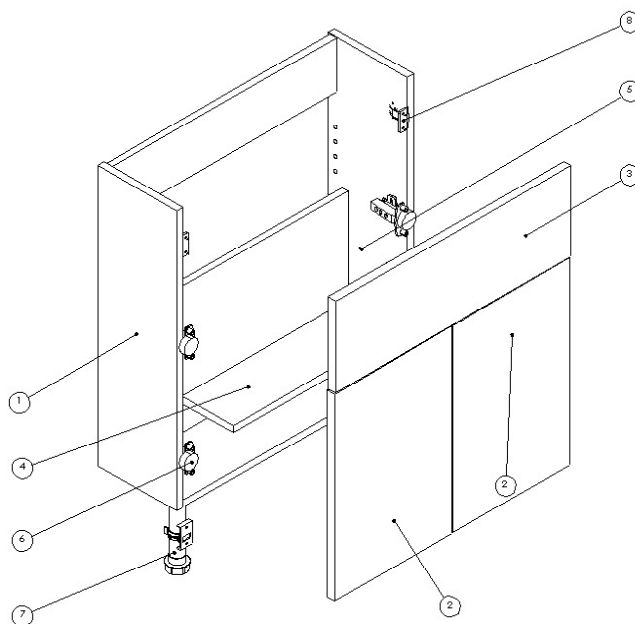

| Number | Part Code | Part Description |
|--------|---------------|---|
| 1 | CA0858 | QUBE 600 REDUCED DEPTH WBU - CARCASS ONLY |
| 2 | DR0340 | 600 WASHBASIN DOOR 297 X 454 (18MM MFC) |
| 3 | FA0228 | 600 WASHBASIN FASCIA 596 X 200 (18MM MFC) |
| 4 | SH0004 | SHELF (18MM MFC) |
| 5 | 800.FIT.00007 | 5MM NICKEL SHELF PEG |
| 6 | 800.HIN.00019 | 2 X HINGE (1 X SC ONLY) C/W PLATES & COVERS KIT |
| 7 | 800.FIT.00010 | ADJUSTABLE LEG BAG AND FITTINGS |
| 8 | 800.ACC.00017 | PUSHFIT Keku |

Where applicable please note when ordering unit frontage's or carcasses, the style and colour will need to be specified.

Additional Documentation

Additional Documentation available on our website www.utopiagroup.com.

Every effort has been made to ensure that the information provided on this document is correct at the time of creation. Finally, Utopia Furniture Ltd reserve the right to alter materials and specifications in line with continuing programme of production and service development.

Spares Diagram



Bathroom Perfection

QUBE | QUBE FITTED – 200mm Standard Depth Single Base

QBE609**, QBE613**, QBE610**, QBE614**

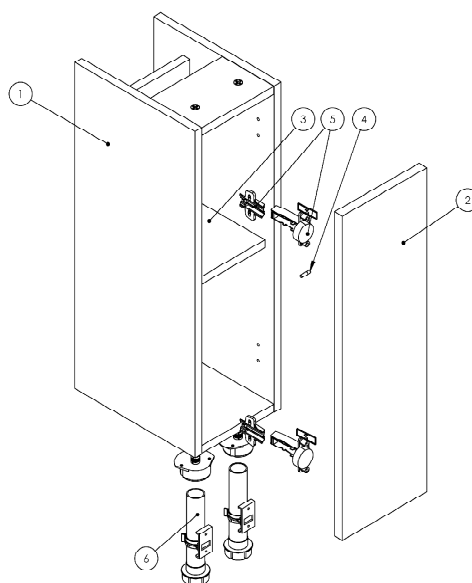

Drawing Shows Left Hand

| Number | Part Code | Part Description |
|--------|---------------|---|
| 1 | CA0853 | QUBE 200 STANDARD SINGLE BASE UNIT - CARCASS ONLY |
| 2 | DR0341 | 200 SINGLE BASE DOOR 197 X 656 (18MM MFC) |
| 3 | SH0012 | SHELF (18MM MFC) |
| 4 | 800.FIT.00007 | 5MM NICKEL SHELF PEG |
| 5 | 800.HIN.00019 | 2 X HINGE (1 X SC ONLY) C/W PLATES & COVERS KIT |
| 6 | 800.FIT.00010 | ADJUSTABLE LEG BAG AND FITTINGS |

Where applicable please note when ordering unit frontage's or carcasses, the style and colour will need to be specified.

Additional Documentation

Additional Documentation available on our website www.utopiagroup.com.

Every effort has been made to ensure that the information provided on this document is correct at the time of creation. Finally, Utopia Furniture Ltd reserve the right to alter materials and specifications in line with continuing programme of production and service development.

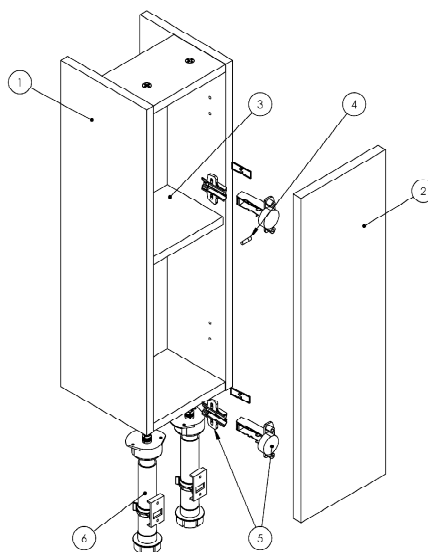
QUBE | QUBE FITTED – 200mm Reduced Depth Single Base**QBE611**, QBE615**, QBE612**, QBE616****

| Number | Part Code | Part Description |
|--------|---------------|--|
| 1 | CA0854 | QUBE 200 REDUCED SINGLE BASE UNIT - CARCASS ONLY |
| 2 | DR0341 | 200 SINGLE BASE DOOR 197 X 656 (18MM MFC) |
| 3 | SH0110 | SHELF (18MM MFC) |
| 4 | 800.FIT.00007 | 5MM NICKEL SHELF PEG |
| 5 | 800.HIN.00019 | 2 X HINGE (1 X SC ONLY) C/W PLATES & COVERS KIT |
| 6 | 800.FIT.00010 | ADJUSTABLE LEG BAG AND FITTINGS |

Where applicable please note when ordering unit frontage's or carcasses, the style and colour will need to be specified.

Additional Documentation

Additional Documentation available on our website www.utopiagroup.com.

Every effort has been made to ensure that the information provided on this document is correct at the time of creation. Finally, Utopia Furniture Ltd reserve the right to alter materials and specifications in line with continuing programme of production and service development.

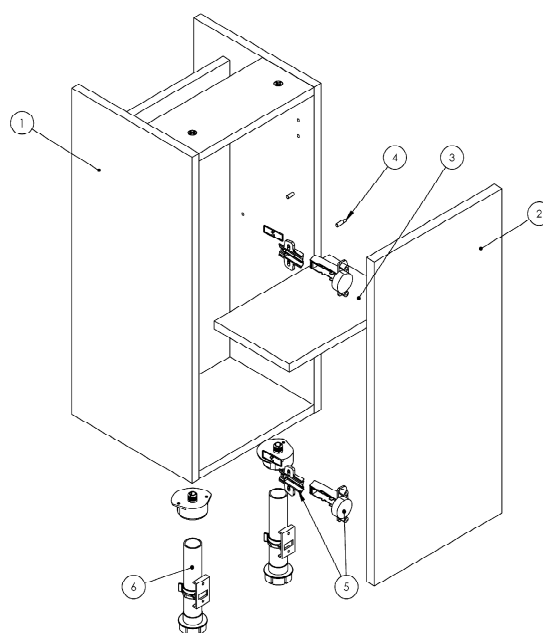
QUBE | QUBE FITTED – 300mm Standard Depth Single Base**QBE617**, QBE621**, QBE618**, QBE622****

| Number | Part Code | Part Description |
|--------|---------------|---|
| 1 | CA0855 | QUBE 300 STANDARD SINGLE BASE UNIT - CARCASS ONLY |
| 2 | DR0342 | 300 SINGLE BASE DOOR 297 X 656 (18MM MFC) |
| 3 | SH0009 | SHELF (18MM MFC) |
| 4 | 800.FIT.00007 | 5MM NICKEL SHELF PEG |
| 5 | 800.HIN.00019 | 2 X HINGE (1 X SC ONLY) C/W PLATES & COVERS KIT |
| 6 | 800.FIT.00010 | ADJUSTABLE LEG BAG AND FITTINGS |

Where applicable please note when ordering unit frontage's or carcasses, the style and colour will need to be specified.

Additional Documentation

Additional Documentation available on our website www.utopiagroup.com.

Every effort has been made to ensure that the information provided on this document is correct at the time of creation. Finally, Utopia Furniture Ltd reserve the right to alter materials and specifications in line with continuing programme of production and service development.

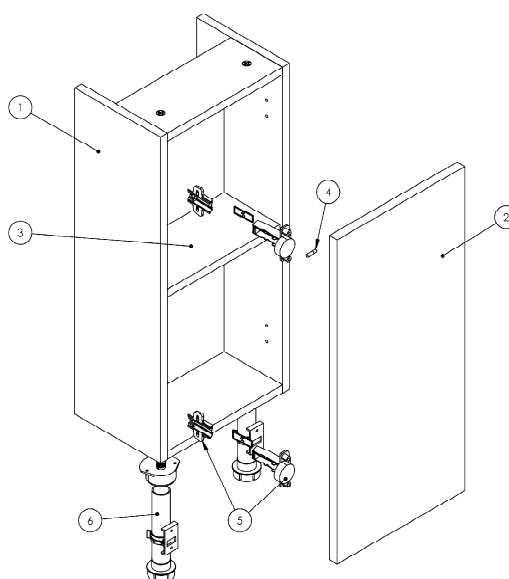
QUBE | QUBE FITTED – 300mm Reduced Depth Single Base**QBE619**, QBE623**, QBE620**, QBE624****

| Number | Part Code | Part Description |
|--------|---------------|--|
| 1 | CA0856 | QUBE 300 REDUCED SINGLE BASE UNIT - CARCASS ONLY |
| 2 | DR0342 | 300 SINGLE BASE DOOR 297 X 656 (18MM MFC) |
| 3 | SH0106 | SHELF (18MM MFC) |
| 4 | 800.FIT.00007 | 5MM NICKEL SHELF PEG |
| 5 | 800.HIN.00019 | 2 X HINGE (1 X SC ONLY) C/W PLATES & COVERS KIT |
| 6 | 800.FIT.00010 | ADJUSTABLE LEG BAG AND FITTINGS |

Where applicable please note when ordering unit frontage's or carcasses, the style and colour will need to be specified.

Additional Documentation

Additional Documentation available on our website www.utopiagroup.com.

Every effort has been made to ensure that the information provided on this document is correct at the time of creation. Finally, Utopia Furniture Ltd reserve the right to alter materials and specifications in line with continuing programme of production and service development.

Spares Diagram



Bathroom Perfection

QUBE | QUBE FITTED – 500mm Standard Depth Full Height Toilet Unit

QBE625**, QBE626**

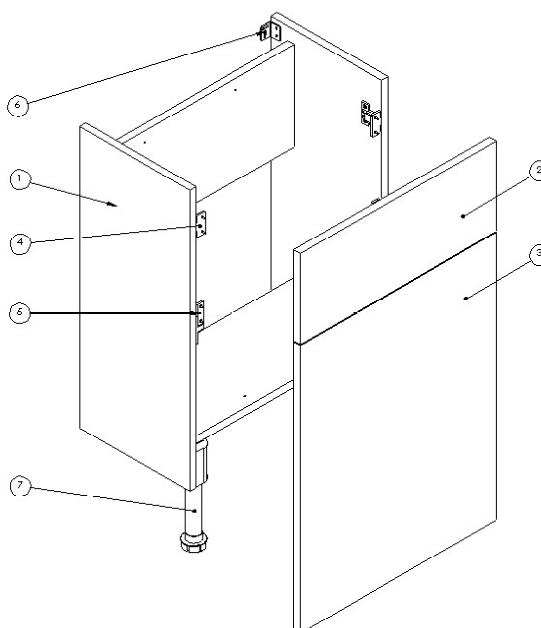

| Number | Part Code | Part Description |
|--------|---------------|--|
| 1 | CA0773 | QUBE 500 STANDARD FULL HEIGHT WCU - CARCASS ONLY |
| 2 | FA0229 | 500 WC UNIT TOP FASCIA 496 X 200 (18MM MFC) |
| 3 | FA0230 | 500 WC UNIT BOTTOM FASCIA 496 X 630 (18MM MFC) |
| 4 | 800.ACC.00017 | PUSHFIT KEKU |
| 5 | 800.ACC.00018 | SLIDE FITTING KEKU |
| 6 | 800.FIT.00028 | FITTING KIT FOR MODULAR WORKTOPS |
| 7 | 800.FIT.00010 | ADJUSTABLE LEG BAG AND FITTINGS |

Where applicable please note when ordering unit frontage's or carcasses, the style and colour will need to be specified.

Additional Documentation

Additional Documentation available on our website www.utopiagroup.com.

Every effort has been made to ensure that the information provided on this document is correct at the time of creation. Finally, Utopia Furniture Ltd reserve the right to alter materials and specifications in line with continuing programme of production and service development.

Spares Diagram



Bathroom Perfection

QUBE | QUBE FITTED – 500mm Standard Depth Full Height Toilet Unit with Cistern

QBE627**, QBE628**

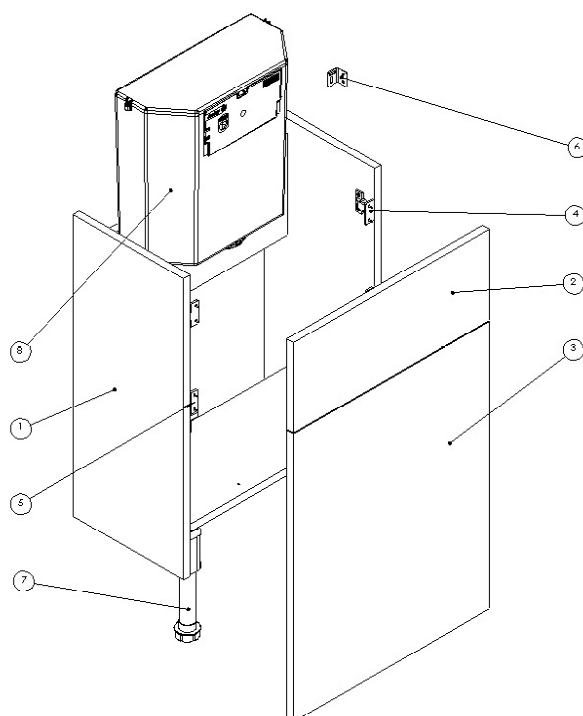

| Number | Part Code | Part Description |
|--------|---------------|--|
| 1 | CA0773 | QUBE 500 STANDARD FULL HEIGHT WCU - CARCASS ONLY |
| 2 | FA0241 | 200 X 496 WCU TOP FASCIA WITH PUSH BUTTON (18MM MFC) |
| 3 | FA0230 | 500 WC UNIT BOTTOM FASCIA 496 X 630 (18MM MFC) |
| 4 | 800.ACC.00017 | PUSHFIT KEKU |
| 5 | 800.ACC.00018 | SLIDE FITTING KEKU |
| 6 | 800.FIT.00028 | FITTING KIT FOR MODULAR WORKTOPS |
| 7 | 800.FIT.00010 | ADJUSTABLE LEG BAG AND FITTINGS |
| 8 | 800.SAN.00116 | CISTERN |

Where applicable please note when ordering unit frontage's or carcasses, the style and colour will need to be specified.

Additional Documentation

Additional Documentation available on our website www.utopiagroup.com.

Every effort has been made to ensure that the information provided on this document is correct at the time of creation. Finally, Utopia Furniture Ltd reserve the right to alter materials and specifications in line with continuing programme of production and service development.

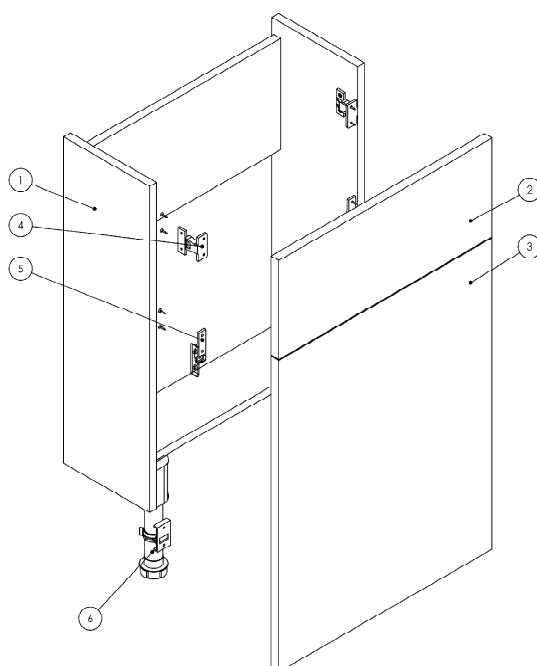
QUBE | QUBE FITTED – 500mm Reduced Depth Full Height Toilet Unit**QBE629**, QBE630****

| Number | Part Code | Part Description |
|--------|---------------|---|
| 1 | CA0772 | QUBE 500 REDUCED FULL HEIGHT WCU - CARCASS ONLY |
| 2 | FA0229 | 500 WC UNIT TOP FASCIA 496 X 200 (18MM MFC) |
| 3 | FA0230 | 500 WC UNIT BOTTOM FASCIA 496 X 630 (18MM MFC) |
| 4 | 800.ACC.00017 | PUSHFIT KEKU |
| 5 | 800.ACC.00018 | SLIDE FITTING KEKU |
| 6 | 800.FIT.00010 | ADJUSTABLE LEG BAG AND FITTINGS |

Where applicable please note when ordering unit frontage's or carcasses, the style and colour will need to be specified.

Additional Documentation

Additional Documentation available on our website www.utopiagroup.com.

Every effort has been made to ensure that the information provided on this document is correct at the time of creation. Finally, Utopia Furniture Ltd reserve the right to alter materials and specifications in line with continuing programme of production and service development.

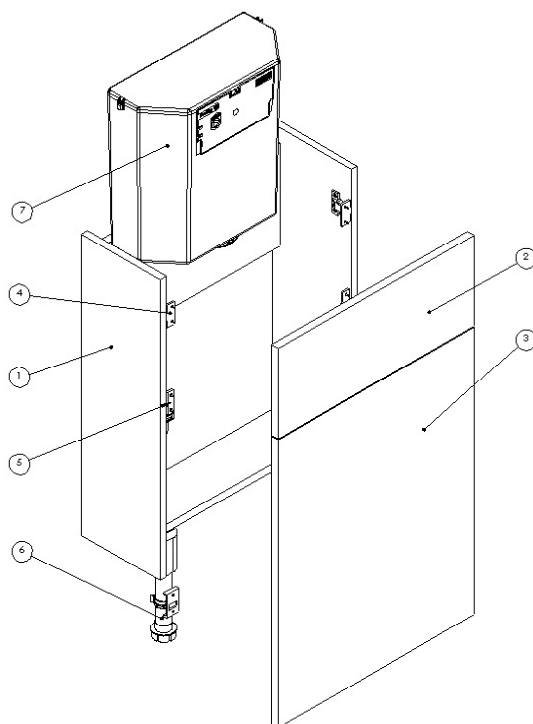
QUBE | QUBE FITTED – 500mm Reduced Depth Full Height Toilet Unit with Cistern**QBE631**, QBE632****

| Number | Part Code | Part Description |
|--------|---------------|--|
| 1 | CA0772 | QUBE 500 REDUCED FULL HEIGHT WCU - CARCASS ONLY |
| 2 | FA0241 | 200 X 496 WCU TOP FASCIA WITH PUSH BUTTON (18MM MFC) |
| 3 | FA0230 | 500 WC UNIT BOTTOM FASCIA 496 X 630 (18MM MFC) |
| 4 | 800.ACC.00017 | PUSHFIT KEKU |
| 5 | 800.ACC.00018 | SLIDE FITTING KEKU |
| 6 | 800.FIT.00010 | ADJUSTABLE LEG BAG AND FITTINGS |
| 7 | 800.SAN.00116 | CISTERN |

Where applicable please note when ordering unit frontage's or carcasses, the style and colour will need to be specified.

Additional Documentation

Additional Documentation available on our website www.utopiagroup.com.

Every effort has been made to ensure that the information provided on this document is correct at the time of creation. Finally, Utopia Furniture Ltd reserve the right to alter materials and specifications in line with continuing programme of production and service development.

Spares Diagram



Bathroom Perfection

QUBE | QUBE FITTED – 600mm Standard Depth Full Height Toilet Unit

QBE633**, QBE634**

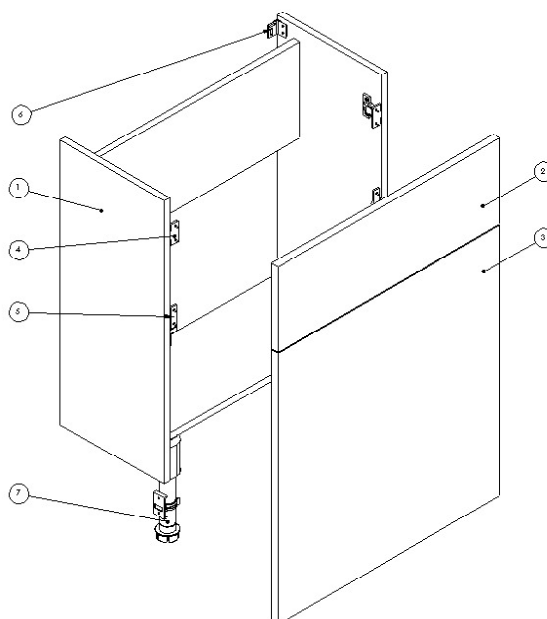

| Number | Part Code | Part Description |
|--------|---------------|--|
| 1 | CA0775 | QUBE 600 STANDARD FULL HEIGHT WCU - CARCASS ONLY |
| 2 | FA0228 | 600 WC UNIT TOP FASCIA 596 X 200 (18MM MFC) |
| 3 | FA0231 | 600 WC UNIT BOTTOM FASCIA 596 X 630 (18MM MFC) |
| 4 | 800.ACC.00017 | PUSHFIT Keku |
| 5 | 800.ACC.00018 | SLIDE FITTING Keku |
| 6 | 800.FIT.00028 | FITTING KIT FOR MODULAR WORKTOPS |
| 7 | 800.FIT.00010 | ADJUSTABLE LEG BAG AND FITTINGS |

Where applicable please note when ordering unit frontage's or carcasses, the style and colour will need to be specified.

Additional Documentation

Additional Documentation available on our website www.utopiagroup.com.

Every effort has been made to ensure that the information provided on this document is correct at the time of creation. Finally, Utopia Furniture Ltd reserve the right to alter materials and specifications in line with continuing programme of production and service development.

Spares Diagram



Bathroom Perfection

QUBE | QUBE FITTED – 600mm Standard Depth Full Height Toilet Unit with Cistern

QBE635**, QBE636**

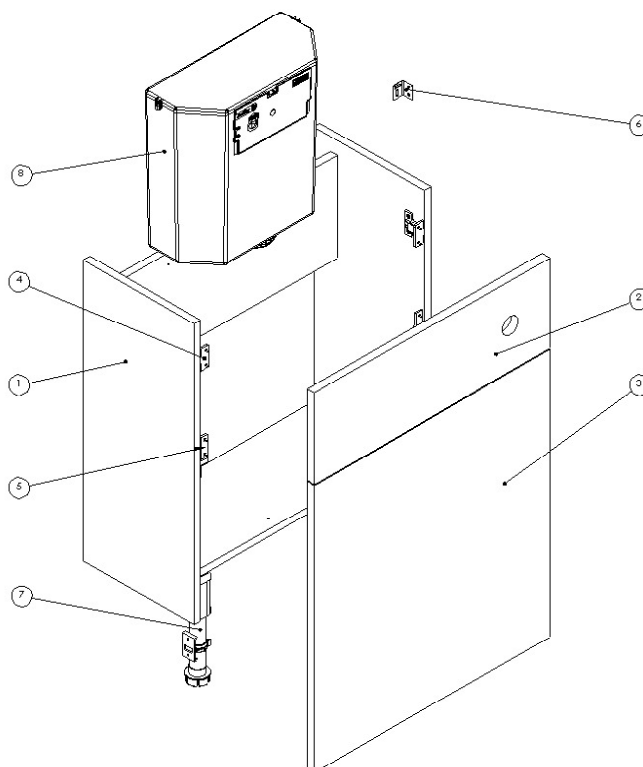

| Number | Part Code | Part Description |
|--------|---------------|---|
| 1 | CA0775 | QUBE 600 STANDARD FULL HEIGHT WCU - CARCASS ONLY |
| 2 | FA0242 | 200 X 596 WCU TOP FASCIA WITH PUSH BUTTON (18MM MFC) |
| 3 | FA0231 | 600 WC UNIT BOTTOM FASCIA 596 X 630 (18MM MFC) |
| 4 | 800.ACC.00017 | PUSHFIT KEKU |
| 5 | 800.ACC.00018 | SLIDE FITTING KEKU |
| 6 | 800.FIT.00028 | FITTING KIT FOR MODULAR WORKTOPS |
| 7 | 800.FIT.00010 | ADJUSTABLE LEG BAG AND FITTINGS |
| 8 | 800.SAN.00116 | CISTERN |

Where applicable please note when ordering unit frontage's or carcasses, the style and colour will need to be specified.

Additional Documentation

Additional Documentation available on our website www.utopiagroup.com.

Every effort has been made to ensure that the information provided on this document is correct at the time of creation. Finally, Utopia Furniture Ltd reserve the right to alter materials and specifications in line with continuing programme of production and service development.

Spares Diagram



Bathroom Perfection

QUBE | QUBE FITTED – 600mm Reduced Depth Full Height Toilet Unit

QBE637**, QBE638**

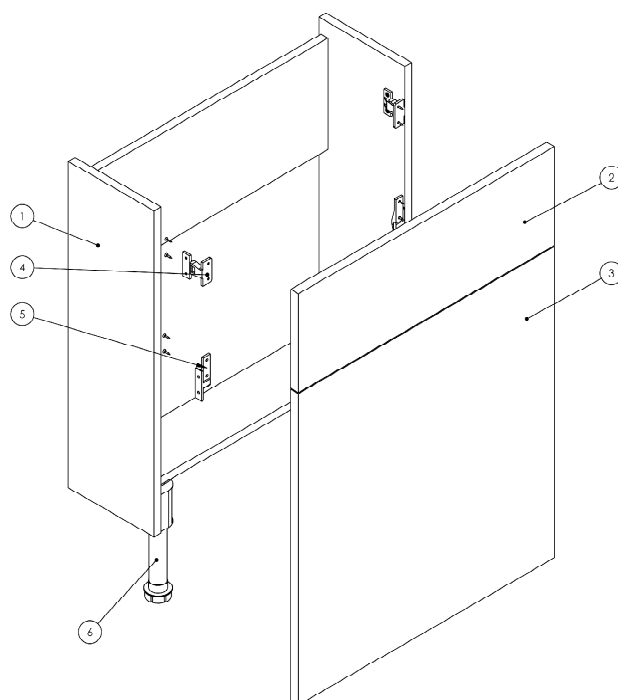

| Number | Part Code | Part Description |
|--------|---------------|---|
| 1 | CA0774 | QUBE 600 REDUCED FULL HEIGHT WCU - CARCASS ONLY |
| 2 | FA0228 | 600 WASHBASIN FASCIA 596 X 200 (18MM MFC) |
| 3 | FA0231 | 600 WC UNIT BOTTOM FASCIA 596 X 630 (18MM MFC) |
| 4 | 800.ACC.00017 | PUSHFIT KEKU |
| 5 | 800.ACC.00018 | SLIDE FITTING KEKU |
| 6 | 800.FIT.00010 | ADJUSTABLE LEG BAG AND FITTINGS |

Where applicable please note when ordering unit frontage's or carcasses, the style and colour will need to be specified.

Additional Documentation

Additional Documentation available on our website www.utopiagroup.com.

Every effort has been made to ensure that the information provided on this document is correct at the time of creation. Finally, Utopia Furniture Ltd reserve the right to alter materials and specifications in line with continuing programme of production and service development.

Spares Diagram



Bathroom Perfection

QUBE | QUBE FITTED – 600mm Reduced Depth Full Height Toilet Unit with Cistern

QBE639**, QBE640**

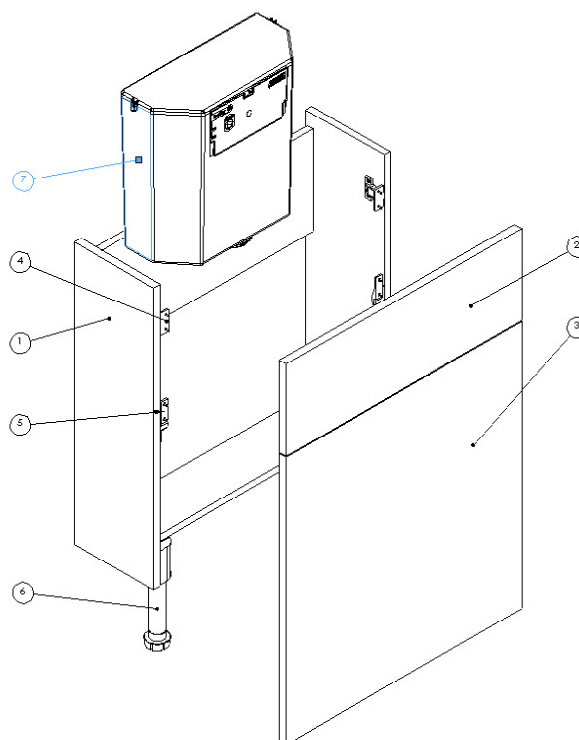

| Number | Part Code | Part Description |
|--------|---------------|--|
| 1 | CA0774 | QUBE 600 REDUCED FULL HEIGHT WCU - CARCASS ONLY |
| 2 | FA0231 | 200 X 596 WCU TOP FASCIA WITH PUSH BUTTON (18MM MFC) |
| 3 | FA0242 | 500 WC UNIT BOTTOM FASCIA 596 X 630 (18MM MFC) |
| 4 | 800.ACC.00017 | PUSHFIT KEKU |
| 5 | 800.ACC.00018 | SLIDE FITTING KEKU |
| 6 | 800.FIT.00010 | ADJUSTABLE LEG BAG AND FITTINGS |
| 7 | 800.SAN.00116 | CISTERN |

Where applicable please note when ordering unit frontage's or carcasses, the style and colour will need to be specified.

Additional Documentation

Additional Documentation available on our website www.utopiagroup.com.

Every effort has been made to ensure that the information provided on this document is correct at the time of creation. Finally, Utopia Furniture Ltd reserve the right to alter materials and specifications in line with continuing programme of production and service development.