

Spares Diagram



Bathroom Perfection

QUBE | QUBE – 500mm Mirror Cabinet

QBE163**

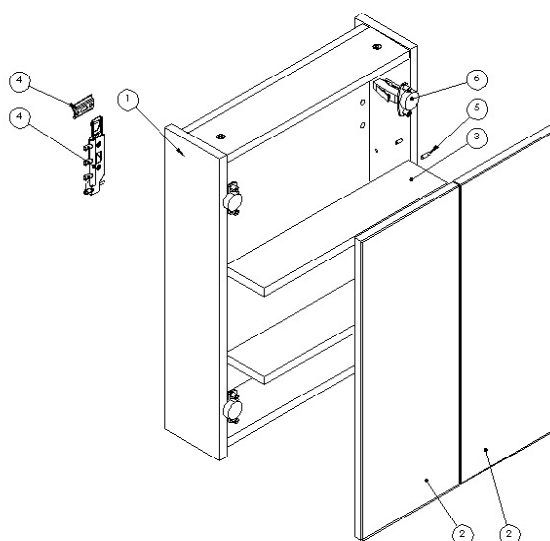

| Number | Part Code | Part Description |
|--------|---------------|---|
| 1 | CA0682 | QUBE 500 MIRROR CABINET - CARCASS ONLY |
| 2 | BD0039 | 247 X 656 BONDED MIRROR DOOR |
| 3 | SH0150 | SHELF 464 X 100 (18MM MFC) |
| 4 | 800.FIT.00029 | CAB HANGER DOWEL PLATE KIT |
| 5 | 800.FIT.00007 | 5MM NICKEL SHELF PEG |
| 6 | 800.HIN.00019 | 2 X HINGE (1 X SC ONLY) C/W PLATES & COVERS KIT |

Where applicable please note when ordering unit frontage's or carcasses, the style and colour will need to be specified.

Additional Documentation

Additional Documentation available on our website www.utopiagroup.com.

Every effort has been made to ensure that the information provided on this document is correct at the time of creation. Finally, Utopia Furniture Ltd reserve the right to alter materials and specifications in line with continuing programme of production and service development.

Spares Diagram



Bathroom Perfection

QUBE | QUBE – 600mm Mirror Cabinet

QBE164**

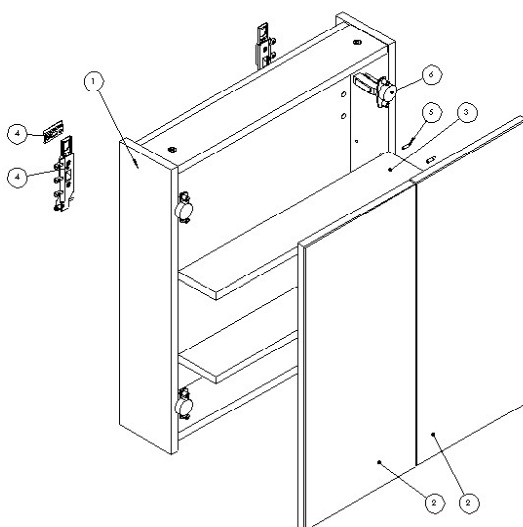

| Number | Part Code | Part Description |
|--------|---------------|---|
| 1 | CA0683 | QUBE 600 MIRROR CABINET - CARCASS ONLY |
| 2 | BD0040 | 297 X 656 BONDED MIRROR DOOR |
| 3 | SH0149 | SHELF 564 X 100 (18MM MFC) |
| 4 | 800.FIT.00029 | CAB HANGER DOWEL PLATE KIT |
| 5 | 800.FIT.00007 | 5MM NICKEL SHELF PEG |
| 6 | 800.HIN.00019 | 2 X HINGE (1 X SC ONLY) C/W PLATES & COVERS KIT |

Where applicable please note when ordering unit frontage's or carcasses, the style and colour will need to be specified.

Additional Documentation

Additional Documentation available on our website www.utopiagroup.com.

Every effort has been made to ensure that the information provided on this document is correct at the time of creation. Finally, Utopia Furniture Ltd reserve the right to alter materials and specifications in line with continuing programme of production and service development.

Spares Diagram



Bathroom Perfection

QUBE | QUBE – 800mm Mirror Cabinet

QBE165**

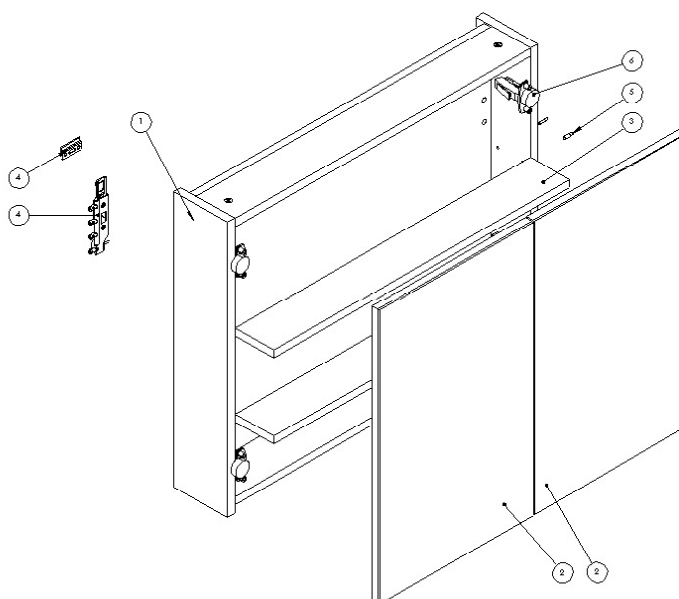

| Number | Part Code | Part Description |
|--------|---------------|---|
| 1 | CA0684 | QUBE 800 MIRROR CABINET - CARCASS ONLY |
| 2 | BD0041 | 397 X 656 BONDED MIRROR DOOR |
| 3 | SH0144 | SHELF 764 X 100 (18MM MFC) |
| 4 | 800.FIT.00029 | CAB HANGER DOWEL PLATE KIT |
| 5 | 800.FIT.00007 | 5MM NICKEL SHELF PEG |
| 6 | 800.HIN.00019 | 2 X HINGE (1 X SC ONLY) C/W PLATES & COVERS KIT |

Where applicable please note when ordering unit frontage's or carcasses, the style and colour will need to be specified.

Additional Documentation

Additional Documentation available on our website www.utopiagroup.com.

Every effort has been made to ensure that the information provided on this document is correct at the time of creation. Finally, Utopia Furniture Ltd reserve the right to alter materials and specifications in line with continuing programme of production and service development.

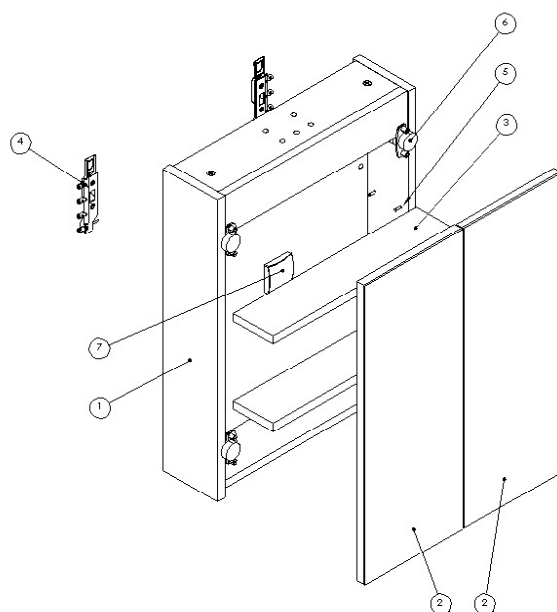
QUBE | QUBE – 500mm Deluxe Mirror Cabinet**QBE166****

| Number | Part Code | Part Description |
|--------|---------------|---|
| 1 | CA0685 | QUBE 500 DELUXE MIRROR CABINET - CARCASS ONLY |
| 2 | BD0039 | 247 X 656 BONDED MIRROR DOOR |
| 3 | SH0150 | SHELF 464 X 100 (18MM MFC) |
| 4 | 800.FIT.00029 | CAB HANGER DOWEL PLATE KIT |
| 5 | 800.FIT.00007 | 5MM NICKEL SHELF PEG |
| 6 | 800.HIN.00019 | 2 X HINGE (1 X SC ONLY) C/W PLATES & COVERS KIT |
| 7 | 800.ELE.00065 | SHAVER SOCKET UNIT C/W TRANSFORMER STAINLESS |

Where applicable please note when ordering unit frontage's or carcasses, the style and colour will need to be specified.

Additional Documentation

Additional Documentation available on our website www.utopiagroup.com.

Every effort has been made to ensure that the information provided on this document is correct at the time of creation. Finally, Utopia Furniture Ltd reserve the right to alter materials and specifications in line with continuing programme of production and service development.

Spares Diagram



Bathroom Perfection

QUBE | QUBE – 600mm Deluxe Mirror Cabinet

QBE169**

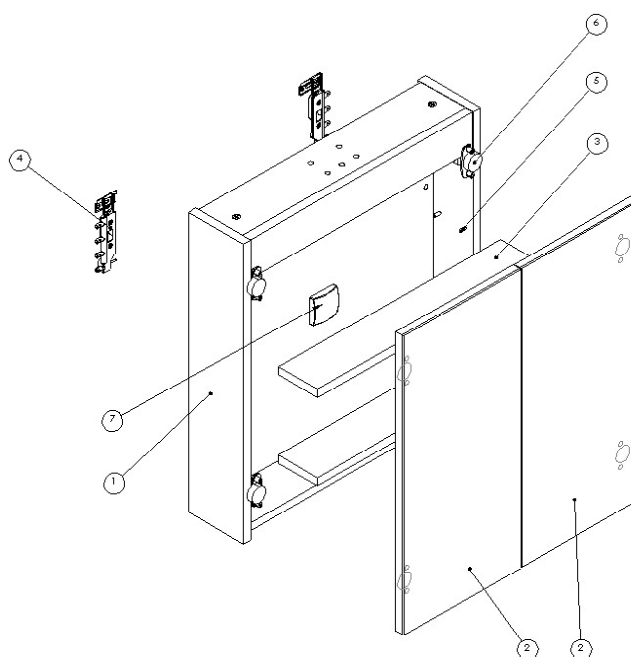

| Number | Part Code | Part Description |
|--------|---------------|---|
| 1 | CA0686 | QUBE 600 DELUXE MIRROR CABINET - CARCASS ONLY |
| 2 | BD0040 | 297 X 656 BONDED MIRROR DOOR |
| 3 | SH0149 | SHELF 564 X 100 (18MM MFC) |
| 4 | 800.FIT.00029 | CAB HANGER DOWEL PLATE KIT |
| 5 | 800.FIT.00007 | 5MM NICKEL SHELF PEG |
| 6 | 800.HIN.00019 | 2 X HINGE (1 X SC ONLY) C/W PLATES & COVERS KIT |
| 7 | 800.ELE.00065 | SHAVER SOCKET UNIT C/W TRANSFORMER STAINLESS |

Where applicable please note when ordering unit frontage's or carcasses, the style and colour will need to be specified.

Additional Documentation

Additional Documentation available on our website www.utopiagroup.com.

Every effort has been made to ensure that the information provided on this document is correct at the time of creation. Finally, Utopia Furniture Ltd reserve the right to alter materials and specifications in line with continuing programme of production and service development.

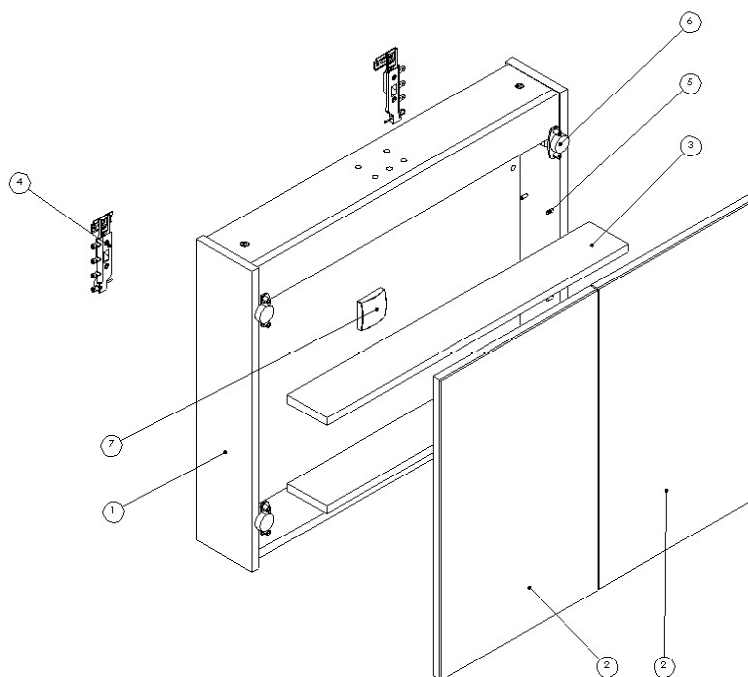
QUBE | QUBE – 800mm Deluxe Mirror Cabinet**QBE172****

| Number | Part Code | Part Description |
|--------|---------------|---|
| 1 | CA0687 | QUBE 800 DELUXE MIRROR CABINET - CARCASS ONLY |
| 2 | BD0041 | 397 X 656 BONDED MIRROR DOOR |
| 3 | SH0144 | SHELF 764 X 100 (18MM MFC) |
| 4 | 800.FIT.00029 | CAB HANGER DOWEL PLATE KIT |
| 5 | 800.FIT.00007 | 5MM NICKEL SHELF PEG |
| 6 | 800.HIN.00019 | 2 X HINGE (1 X SC ONLY) C/W PLATES & COVERS KIT |
| 7 | 800.ELE.00065 | SHAVER SOCKET UNIT C/W TRANSFORMER STAINLESS |

Where applicable please note when ordering unit frontage's or carcasses, the style and colour will need to be specified.

Additional Documentation

Additional Documentation available on our website www.utopiagroup.com.

Every effort has been made to ensure that the information provided on this document is correct at the time of creation. Finally, Utopia Furniture Ltd reserve the right to alter materials and specifications in line with continuing programme of production and service development.

Spares Diagram



Bathroom Perfection

QUBE | QUBE GLIDE – 200mm Wall Open Shelf

QBE153**

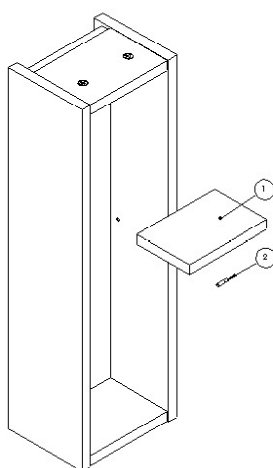

| Number | Part Code | Part Description |
|--------|---------------|----------------------------|
| 1 | SH0148 | SHELF 164 X 110 (18MM MFC) |
| 2 | 800.FIT.00007 | 5MM NICKEL SHELF PEG |

Where applicable please note when ordering unit frontage's or carcasses, the style and colour will need to be specified.

Additional Documentation

Additional Documentation available on our website www.utopiagroup.com.

Every effort has been made to ensure that the information provided on this document is correct at the time of creation. Finally, Utopia Furniture Ltd reserve the right to alter materials and specifications in line with continuing programme of production and service development.

05/06/2025

SD0103 - QUBE - 200 WALL OPEN SHELF.docx

Version: v1.0