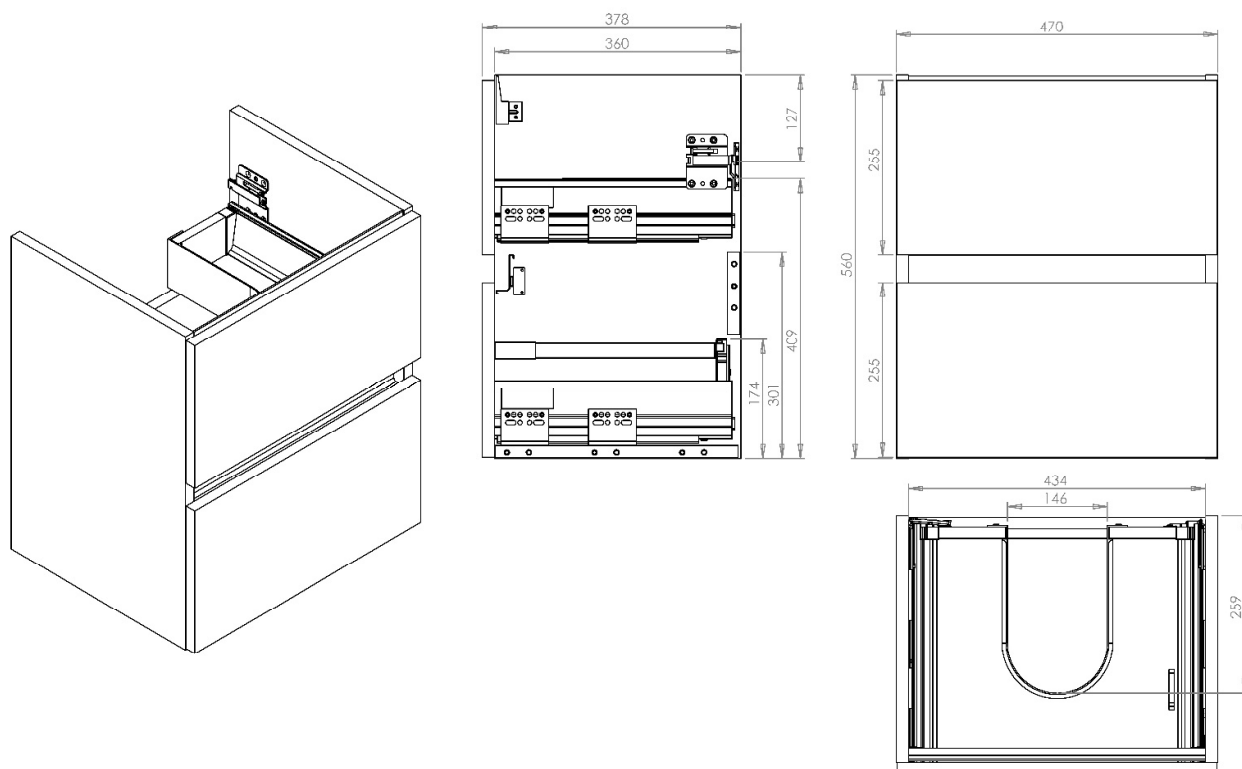

QUBE | QUBE GLIDE – 500 WH Reduced Double Drawer WBU**QBE100**, QBE101**, QBE102****

All dimension in mm. Please check dimensions prior to installation as they can vary due to manufacturing tolerances.

Product Details

Type:	Wall Mounted Double Drawer Washbasin Unit
Width:	470
Depth:	378
Height:	560
Product Weight*:	17kg
Tolerances:	+/- 2mm
Guarantee Period:	5 Years (For Domestic Use) 1 Years (For Commercial Use)
Drawer Box Capacity:	30kg

Product Specification

Fascia Material:	18mm MFC
Carcass Material:	18mm MFC
Opening Mechanism:	Pull
Trim Options:	Chrome, Matt Black & Brushed Brass
Adjustable Legs:	N/A
Quantity of Shelves:	N/A
Shelving Type:	N/A
Handing:	N/A

*Product Weight includes packaging.

Features

- FSC Certified
- Soft Close
- Assembled
- Space Saving

Additional Documentation

Additional Documentation available on our website www.utopiagroup.com

Every effort has been made to ensure that the information provided on this document is correct at the time of creation. Finally, Utopia Furniture Ltd reserve the right to alter materials and specifications in line with continuing programme of production and service development.

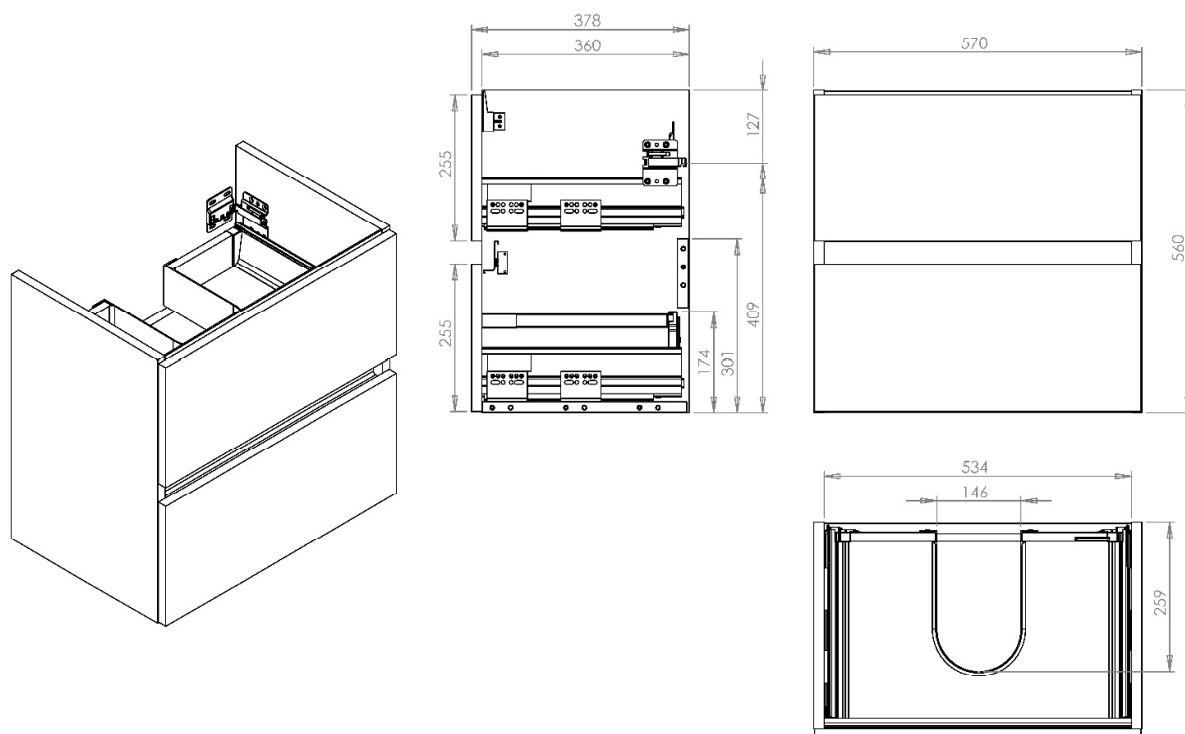
QUBE | QUBE GLIDE – 600 WH Reduced Double Drawer WBU**QBE103**, QBE104**, QBE105****

All dimension in mm. Please check dimensions prior to installation as they can vary due to manufacturing tolerances.

Product Details

Type:	Wall Mounted Double Drawer Washbasin Unit
Width:	570
Depth:	378
Height:	560
Product Weight*:	19kg
Tolerances:	+/- 2mm
Guarantee Period:	5 Years (For Domestic Use) 1 Years (For Commercial Use)
Drawer Box Capacity:	30kg

Product Specification

Fascia Material:	18mm MFC
Carcass Material:	18mm MFC
Opening Mechanism:	Pull
Trim Options:	Chrome, Matt Black & Brushed Brass
Adjustable Legs:	N/A
Quantity of Shelves:	N/A
Shelving Type:	N/A
Handing:	N/A

*Product Weight includes packaging.

Features

- FSC Certified
- Soft Close
- Assembled
- Space Saving

Additional Documentation

Additional Documentation available on our website www.utopiagroup.com

Every effort has been made to ensure that the information provided on this document is correct at the time of creation. Finally, Utopia Furniture Ltd reserve the right to alter materials and specifications in line with continuing programme of production and service development.

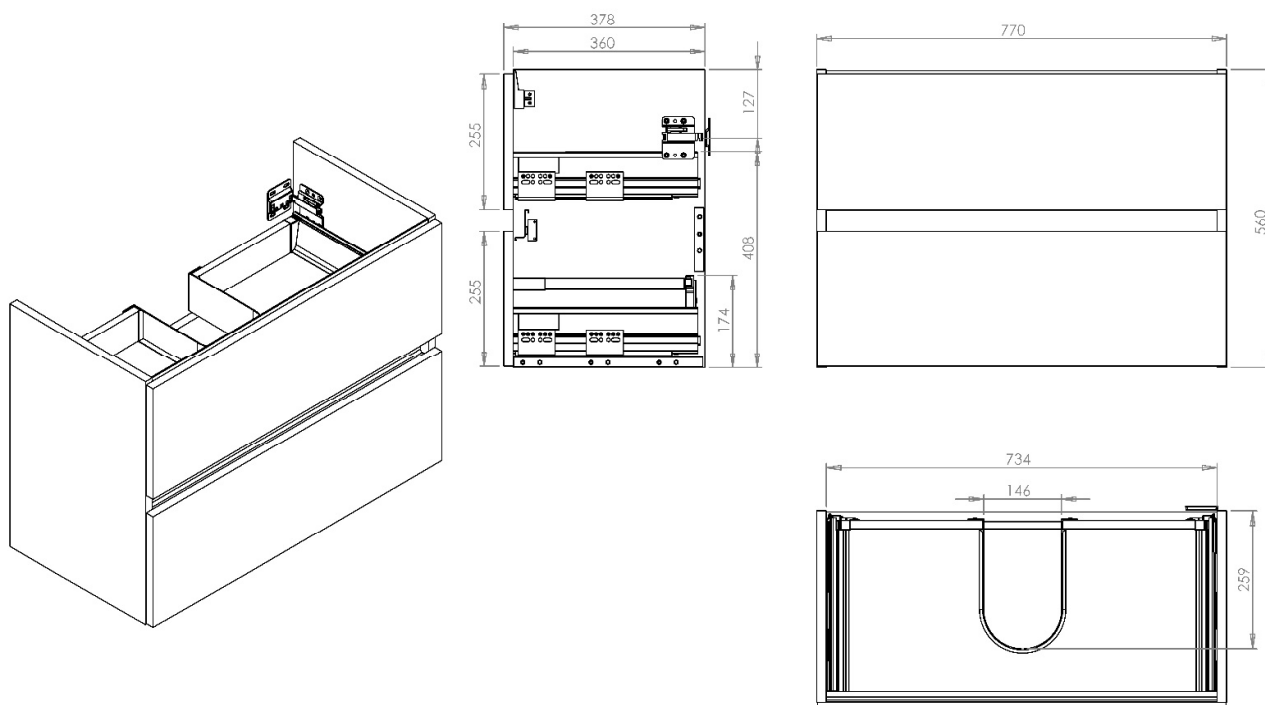
QUBE | QUBE GLIDE – 800 WH Reduced Double Drawer WBU**QBE106**, QBE107**, QBE108****

All dimension in mm. Please check dimensions prior to installation as they can vary due to manufacturing tolerances.

Product Details

Type:	Wall Mounted Double Drawer Washbasin Unit
Width:	770
Depth:	378
Height:	560
Product Weight*:	24kg
Tolerances:	+/- 2mm
Guarantee Period:	5 Years (For Domestic Use) 1 Years (For Commercial Use)
Drawer Box Capacity:	30kg

Product Specification

Fascia Material:	18mm MFC
Carcass Material:	18mm MFC
Opening Mechanism:	Pull
Trim Options:	Chrome, Matt Black & Brushed Brass
Adjustable Legs:	N/A
Quantity of Shelves:	N/A
Shelving Type:	N/A
Handing:	N/A

*Product Weight includes packaging.

Features

- FSC Certified
- Soft Close
- Assembled
- Space Saving

Additional Documentation

Additional Documentation available on our website www.utopiagroup.com

Every effort has been made to ensure that the information provided on this document is correct at the time of creation. Finally, Utopia Furniture Ltd reserve the right to alter materials and specifications in line with continuing programme of production and service development.

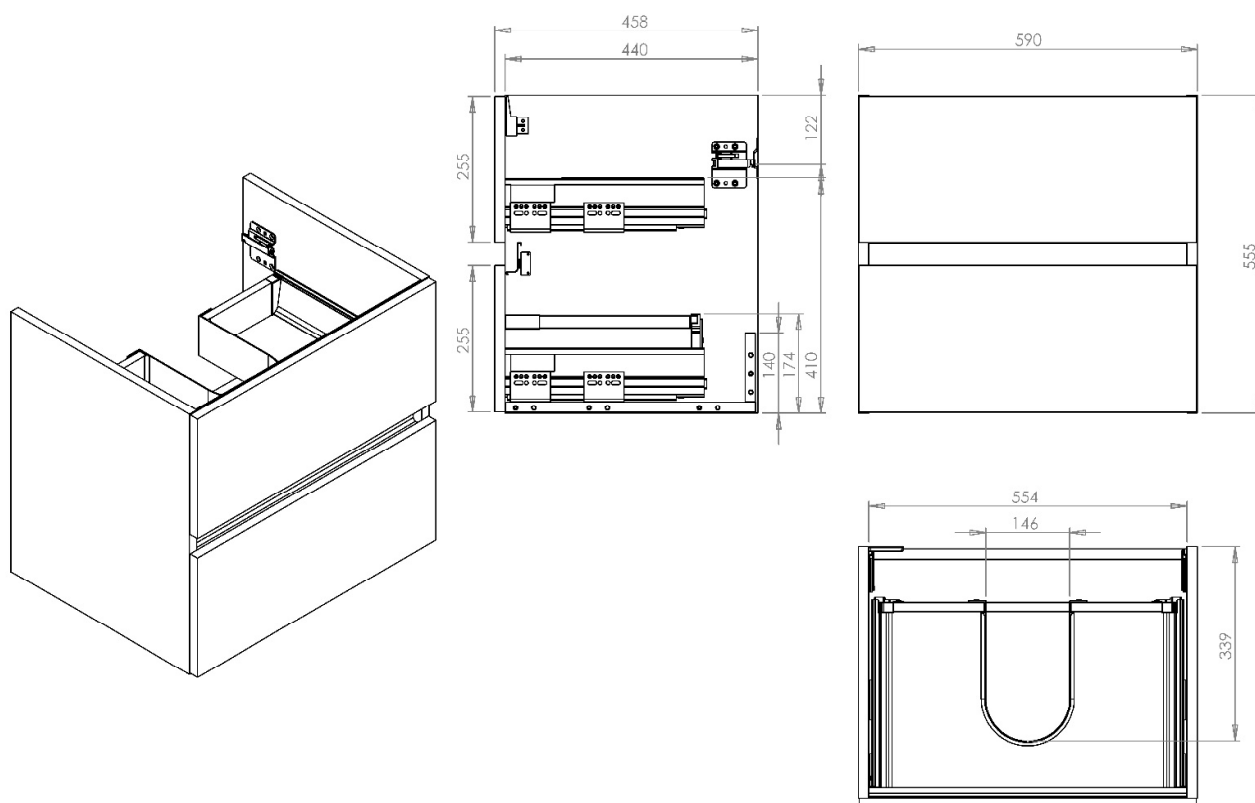
QUBE | QUBE GLIDE – 600 WH Standard Double Drawer WBU**QBE109**, QBE110**, QBE111****

All dimension in mm. Please check dimensions prior to installation as they can vary due to manufacturing tolerances.

Product Details

Type:	Wall Mounted Double Drawer Washbasin Unit
Width:	590
Depth:	458
Height:	555
Product Weight*:	21kg
Tolerances:	+/- 2mm
Guarantee Period:	5 Years (For Domestic Use) 1 Years (For Commercial Use)
Drawer Box Capacity:	30kg

Product Specification

Fascia Material:	18mm MFC
Carcass Material:	18mm MFC
Opening Mechanism:	Pull
Trim Options:	Chrome, Matt Black & Brushed Brass
Adjustable Legs:	N/A
Quantity of Shelves:	N/A
Shelving Type:	N/A
Handing:	N/A

*Product Weight includes packaging.

Features

- FSC Certified
- Soft Close
- Assembled

Additional Documentation

Additional Documentation available on our website www.utopiagroup.com

Every effort has been made to ensure that the information provided on this document is correct at the time of creation. Finally, Utopia Furniture Ltd reserve the right to alter materials and specifications in line with continuing programme of production and service development.

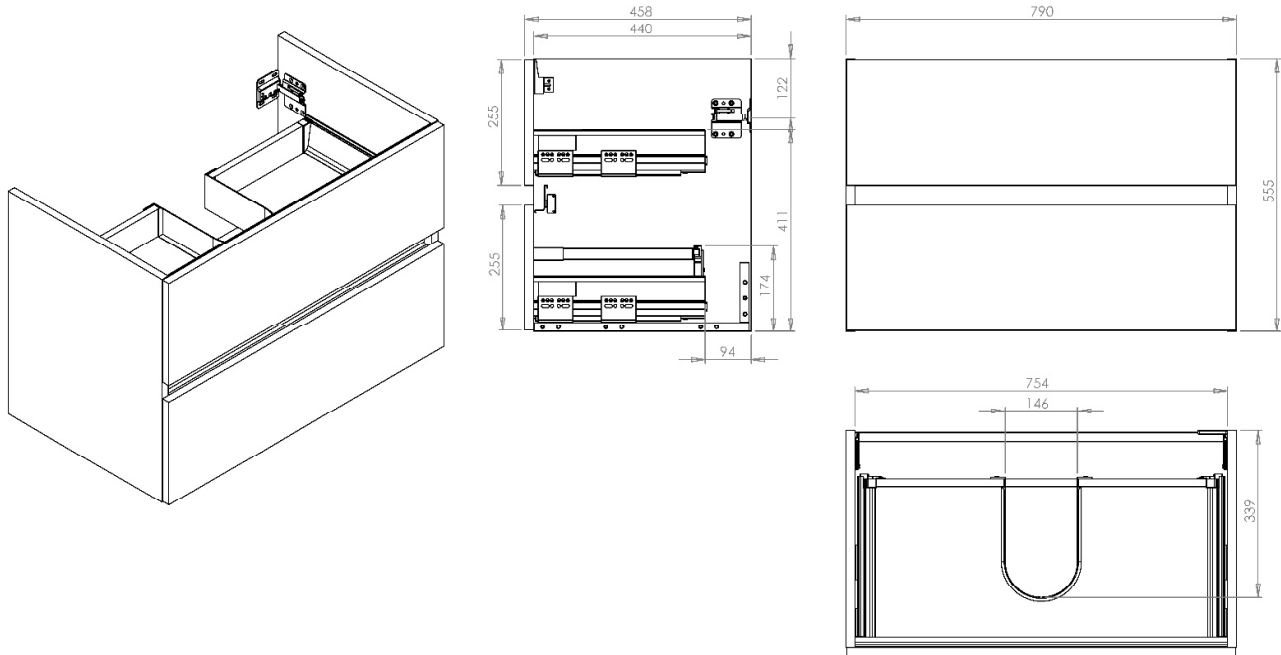
QUBE | QUBE GLIDE – 800 WH Standard Double Drawer WBU**QBE112**, QBE113**, QBE114****

All dimension in mm. Please check dimensions prior to installation as they can vary due to manufacturing tolerances.

Product Details

Type:	Wall Mounted Double Drawer Washbasin Unit
Width:	790
Depth:	458
Height:	555
Product Weight*:	26.5kg
Tolerances:	+/- 2mm
Guarantee Period:	5 Years (For Domestic Use) 1 Years (For Commercial Use)
Drawer Box Capacity:	30kg

Product Specification

Fascia Material:	18mm MFC
Carcass Material:	18mm MFC
Opening Mechanism:	Pull
Trim Options:	Chrome, Matt Black & Brushed Brass
Adjustable Legs:	N/A
Quantity of Shelves:	N/A
Shelving Type:	N/A
Handing:	N/A

*Product Weight includes packaging.

Features

- FSC Certified
- Soft Close
- Assembled

Additional Documentation

Additional Documentation available on our website www.utopiagroup.com

Every effort has been made to ensure that the information provided on this document is correct at the time of creation. Finally, Utopia Furniture Ltd reserve the right to alter materials and specifications in line with continuing programme of production and service development.

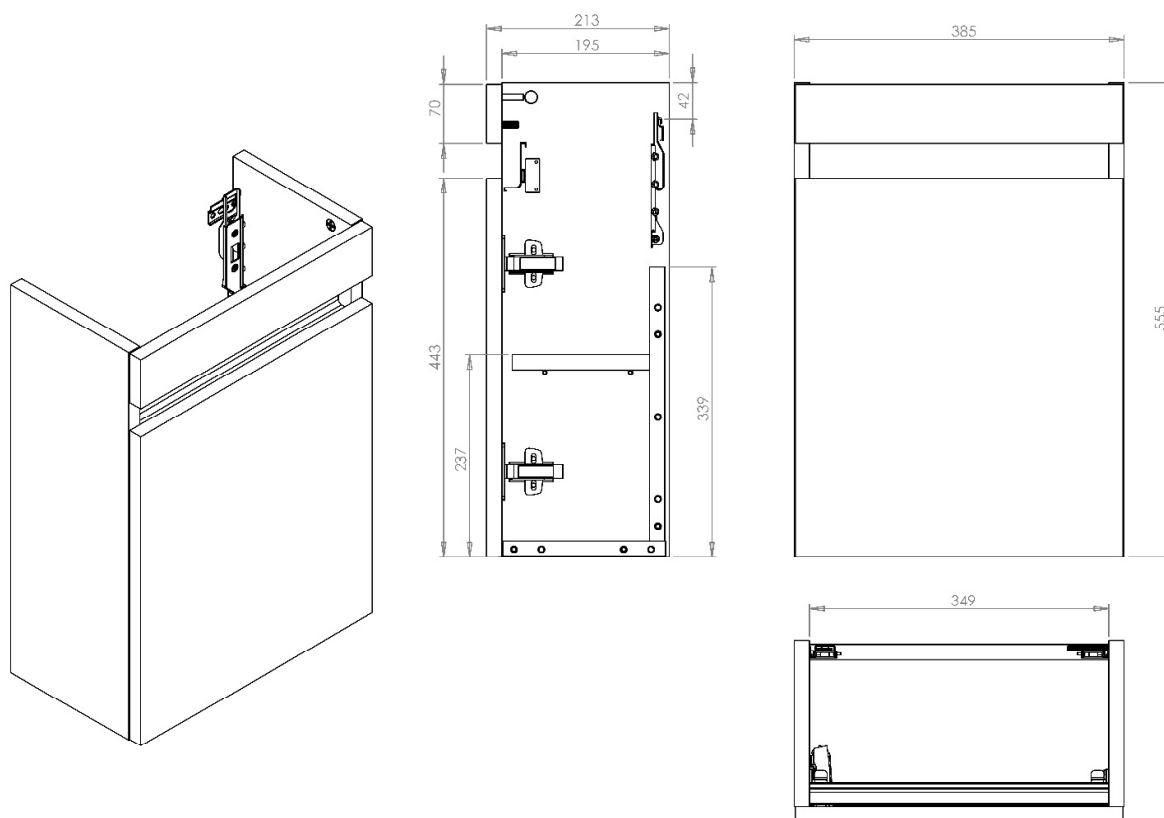
QUBE | QUBE GLIDE – 400 WH Cloakroom Unit**QBE115**, QBE116**, QBE117**, QBE118**, QBE119**, QBE120****

All dimension in mm. Please check dimensions prior to installation as they can vary due to manufacturing tolerances.

Product Details

Type:	Wall Mounted Cloakroom Unit
Width:	385
Depth:	213
Height:	555
Product Weight*:	8.8kg
Tolerances:	+/- 2mm
Guarantee Period:	5 Years (For Domestic Use) 1 Years (For Commercial Use)
Drawer Box Capacity:	30kg

Product Specification

Fascia Material:	18mm MFC
Carcass Material:	18mm MFC
Opening Mechanism:	Pull
Trim Options:	Chrome, Matt Black & Brushed Brass
Adjustable Legs:	N/A
Quantity of Shelves:	1 Plus Base
Shelving Type:	MFC
Handing:	Available Left or Right Hand

*Product Weight includes packaging.

Features

- FSC Certified
- Soft Close
- Assembled
- Space Saving

Additional Documentation

Additional Documentation available on our website www.utopiagroup.com

Every effort has been made to ensure that the information provided on this document is correct at the time of creation. Finally, Utopia Furniture Ltd reserve the right to alter materials and specifications in line with continuing programme of production and service development.

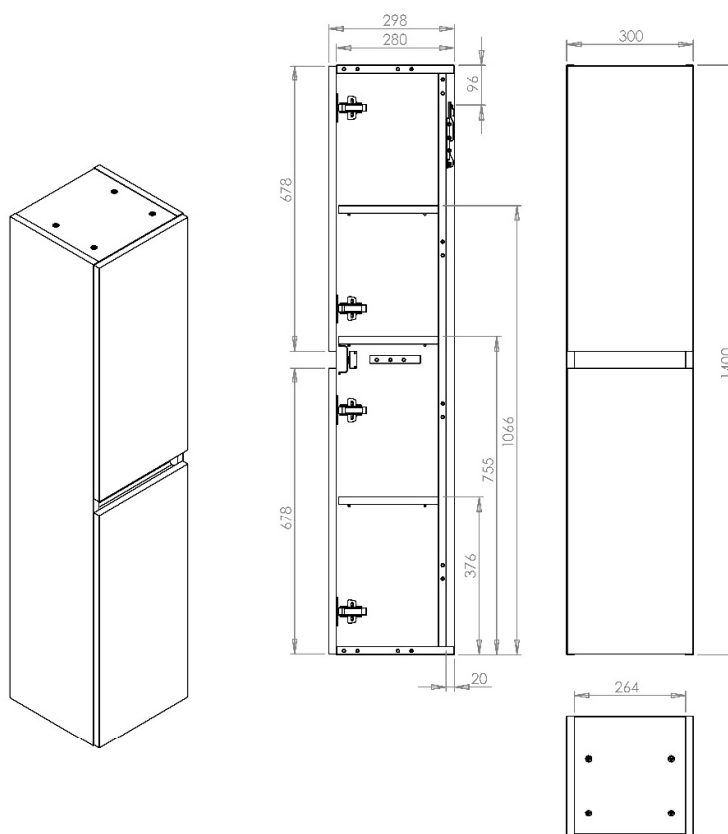
QUBE | QUBE GLIDE – 300 Tall Storage Unit**QBE157**, QBE158**, QBE159**, QBE160**, QBE161**, QBE162****

All dimension in mm. Please check dimensions prior to installation as they can vary due to manufacturing tolerances.

Product Details

Type:	Wall Mounted Double Door Tall Storage Unit
Width:	300
Depth:	298
Height:	1400
Product Weight*:	25.5kg
Tolerances:	+/- 2mm
Guarantee Period:	5 Years (For Domestic Use) 1 Years (For Commercial Use)
Drawer Box Capacity:	N/A

Product Specification

Fascia Material:	18mm MFC
Carcass Material:	18mm MFC
Opening Mechanism:	Pull
Trim Options:	Chrome, Matt Black & Brushed Brass
Adjustable Legs:	N/A
Quantity of Shelves:	N/A
Shelving Type:	N/A
Handing:	Available Left or Right Hand

*Product Weight includes packaging.

Features

- FSC Certified
- Soft Close
- Assembled

Additional Documentation

Additional Documentation available on our website www.utopiagroup.com

Every effort has been made to ensure that the information provided on this document is correct at the time of creation. Finally, Utopia Furniture Ltd reserve the right to alter materials and specifications in line with continuing programme of production and service development.

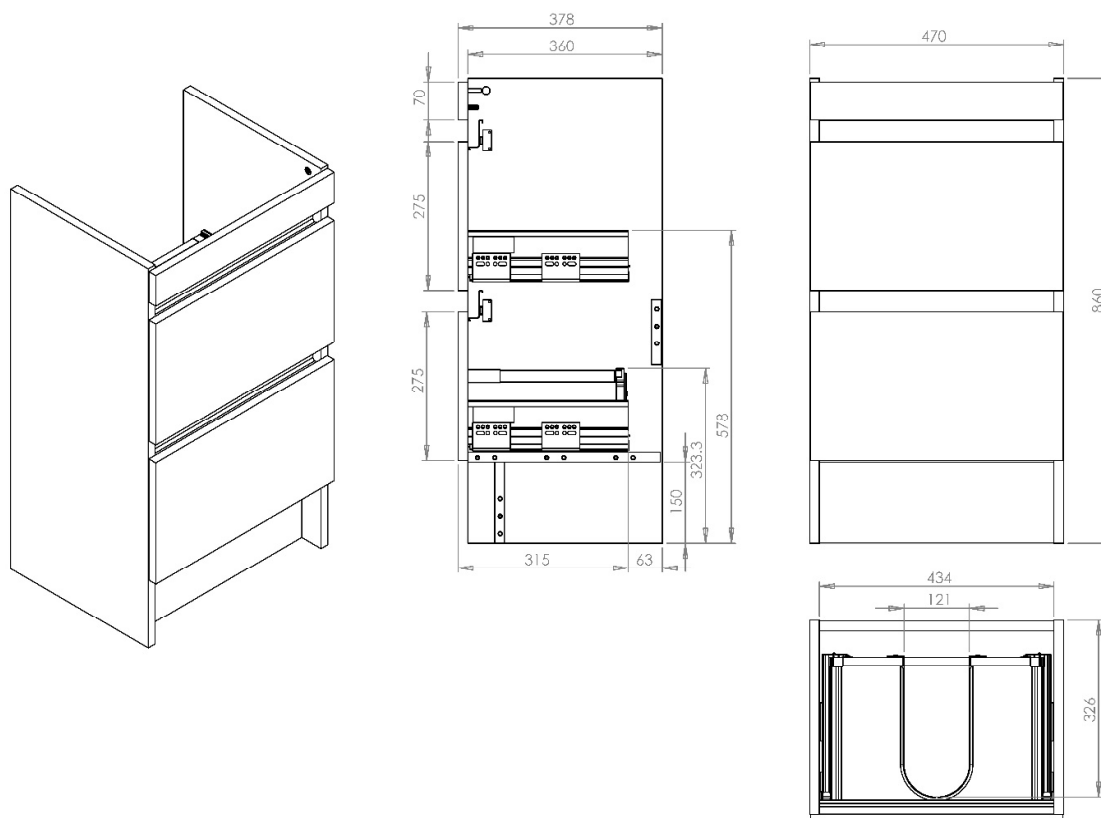
QUBE | QUBE GLIDE – 500 FS Reduced Double Drawer WBU**QBE127**, QBE128**, QBE129****

All dimension in mm. Please check dimensions prior to installation as they can vary due to manufacturing tolerances.

Product Details

Type:	Floor Standing Double Drawer Washbasin Unit
Width:	470
Depth:	378
Height:	860
Product Weight*:	17.4kg
Tolerances:	+/- 2mm
Guarantee Period:	5 Years (For Domestic Use) 1 Years (For Commercial Use)
Drawer Box Capacity:	30kg

Product Specification

Fascia Material:	18mm MFC
Carcass Material:	18mm MFC
Opening Mechanism:	Pull
Trim Options:	Chrome, Matt Black & Brushed Brass
Adjustable Legs:	N/A
Quantity of Shelves:	N/A
Shelving Type:	N/A
Handing:	N/A

*Product Weight includes packaging.

Features

- FSC Certified
- Soft Close
- Assembled
- Space Saving

Additional Documentation

Additional Documentation available on our website www.utopiagroup.com

Every effort has been made to ensure that the information provided on this document is correct at the time of creation. Finally, Utopia Furniture Ltd reserve the right to alter materials and specifications in line with continuing programme of production and service development.

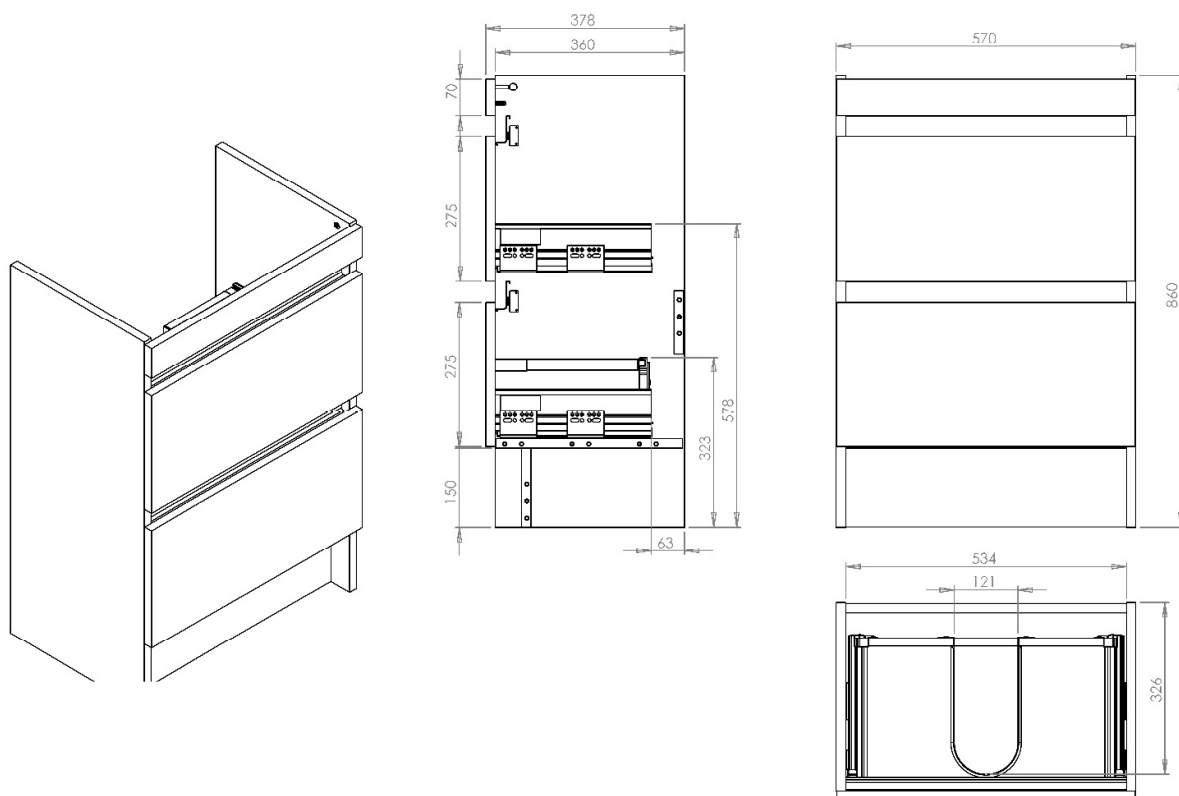
QUBE | QUBE GLIDE – 600 FS Reduced Double Drawer WBU**QBE130**, QBE131**, QBE132****

All dimension in mm. Please check dimensions prior to installation as they can vary due to manufacturing tolerances.

Product Details

Type:	Floor Standing Double Drawer Washbasin Unit
Width:	570
Depth:	378
Height:	860
Product Weight*:	23.5kg
Tolerances:	+/- 2mm
Guarantee Period:	5 Years (For Domestic Use) 1 Years (For Commercial Use)
Drawer Box Capacity:	30kg

Product Specification

Fascia Material:	18mm MFC
Carcass Material:	18mm MFC
Opening Mechanism:	Pull
Trim Options:	Chrome, Matt Black & Brushed Brass
Adjustable Legs:	N/A
Quantity of Shelves:	N/A
Shelving Type:	N/A
Handing:	N/A

*Product Weight includes packaging.

Features

- FSC Certified
- Soft Close
- Assembled
- Space Saving

Additional Documentation

Additional Documentation available on our website www.utopiagroup.com

Every effort has been made to ensure that the information provided on this document is correct at the time of creation. Finally, Utopia Furniture Ltd reserve the right to alter materials and specifications in line with continuing programme of production and service development.

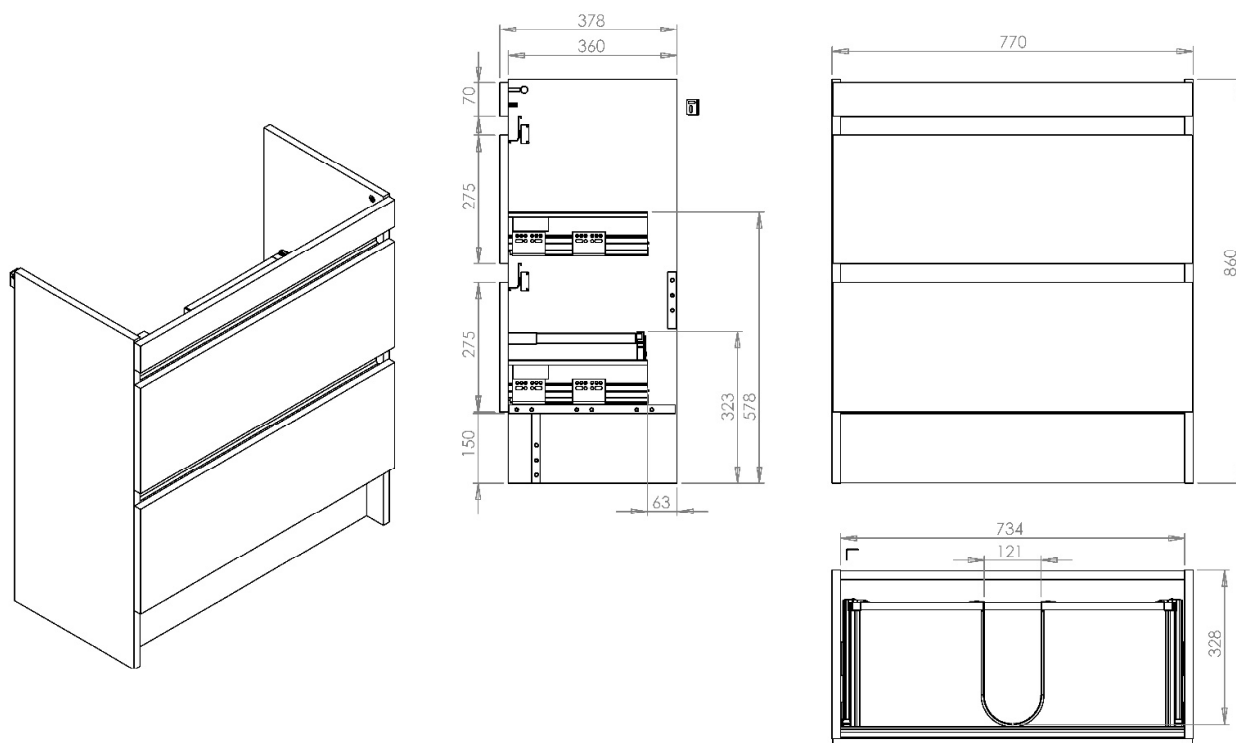
QUBE | QUBE GLIDE – 800 FS Reduced Double Drawer WBU**QBE133**, QBE134**, QBE135****

All dimension in mm. Please check dimensions prior to installation as they can vary due to manufacturing tolerances.

Product Details

Type:	Floor Standing Double Drawer Washbasin Unit
Width:	770
Depth:	378
Height:	860
Product Weight*:	39.20kg
Tolerances:	+/- 2mm
Guarantee Period:	5 Years (For Domestic Use) 1 Years (For Commercial Use)
Drawer Box Capacity:	30kg

Product Specification

Fascia Material:	18mm MFC
Carcass Material:	18mm MFC
Opening Mechanism:	Pull
Trim Options:	Chrome, Matt Black & Brushed Brass
Adjustable Legs:	N/A
Quantity of Shelves:	N/A
Shelving Type:	N/A
Handing:	N/A

*Product Weight includes packaging.

Features

- FSC Certified
- Soft Close
- Assembled
- Space Saving

Additional Documentation

Additional Documentation available on our website www.utopiagroup.com

Every effort has been made to ensure that the information provided on this document is correct at the time of creation. Finally, Utopia Furniture Ltd reserve the right to alter materials and specifications in line with continuing programme of production and service development.

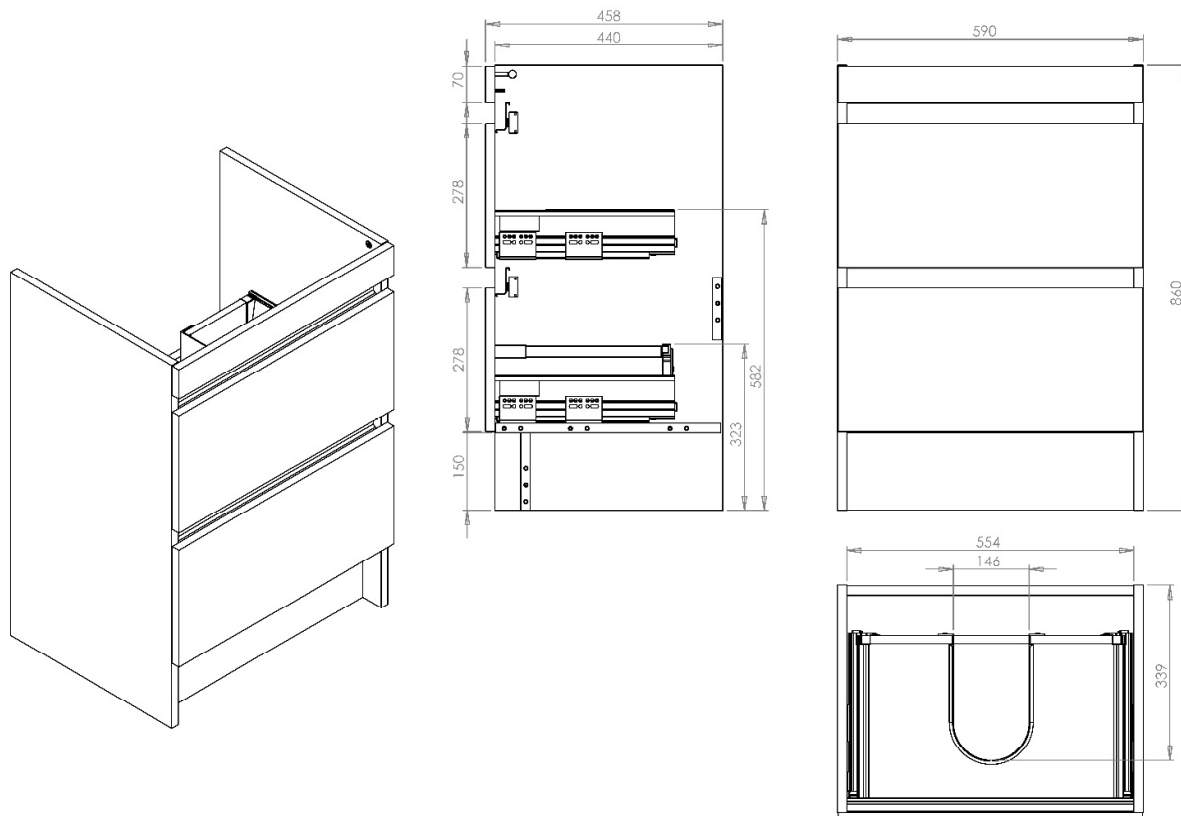
QUBE | QUBE GLIDE – 600 FS Standard Double Drawer WBU**QBE136**, QBE137**, QBE138****

All dimension in mm. Please check dimensions prior to installation as they can vary due to manufacturing tolerances.

Product Details

Type:	Floor Standing Double Drawer Washbasin Unit
Width:	590
Depth:	458
Height:	860
Product Weight*:	26.4kg
Tolerances:	+/- 2mm
Guarantee Period:	5 Years (For Domestic Use) 1 Years (For Commercial Use)
Drawer Box Capacity:	30kg

Product Specification

Fascia Material:	18mm MFC
Carcass Material:	18mm MFC
Opening Mechanism:	Pull
Trim Options:	Chrome, Matt Black & Brushed Brass
Adjustable Legs:	N/A
Quantity of Shelves:	N/A
Shelving Type:	N/A
Handing:	N/A

*Product Weight includes packaging.

Features

- FSC Certified
- Soft Close
- Assembled

Additional Documentation

Additional Documentation available on our website www.utopiagroup.com

Every effort has been made to ensure that the information provided on this document is correct at the time of creation. Finally, Utopia Furniture Ltd reserve the right to alter materials and specifications in line with continuing programme of production and service development.

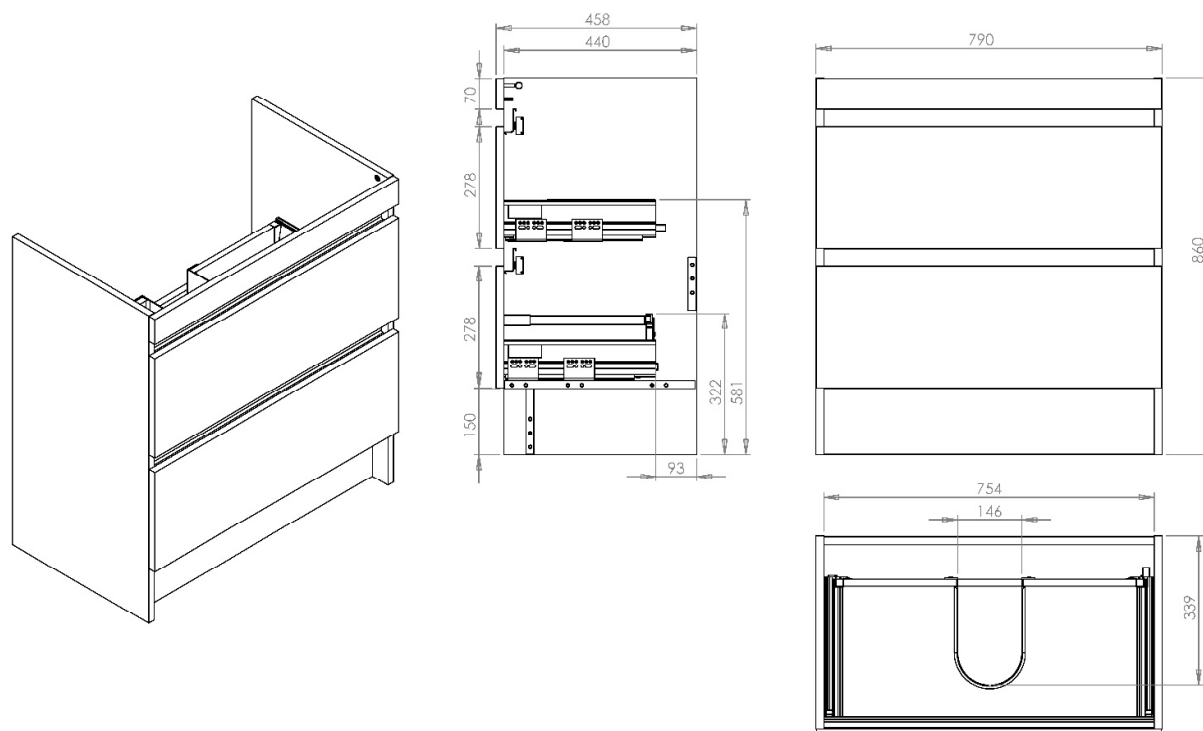
QUBE | QUBE GLIDE – 800 FS Standard Double Drawer WBU**QBE139**, QBE140**, QBE141****

All dimension in mm. Please check dimensions prior to installation as they can vary due to manufacturing tolerances.

Product Details

Type:	Floor Standing Double Drawer Washbasin Unit
Width:	790
Depth:	458
Height:	855
Product Weight*:	31.7kg
Tolerances:	+/- 2mm
Guarantee Period:	5 Years (For Domestic Use) 1 Years (For Commercial Use)
Drawer Box Capacity:	30kg

Product Specification

Fascia Material:	18mm MFC
Carcass Material:	18mm MFC
Opening Mechanism:	Pull
Trim Options:	Chrome, Matt Black & Brushed Brass
Adjustable Legs:	N/A
Quantity of Shelves:	N/A
Shelving Type:	N/A
Handing:	N/A

*Product Weight includes packaging.

Features

- FSC Certified
- Soft Close
- Assembled

Additional Documentation

Additional Documentation available on our website www.utopiagroup.com

Every effort has been made to ensure that the information provided on this document is correct at the time of creation. Finally, Utopia Furniture Ltd reserve the right to alter materials and specifications in line with continuing programme of production and service development.

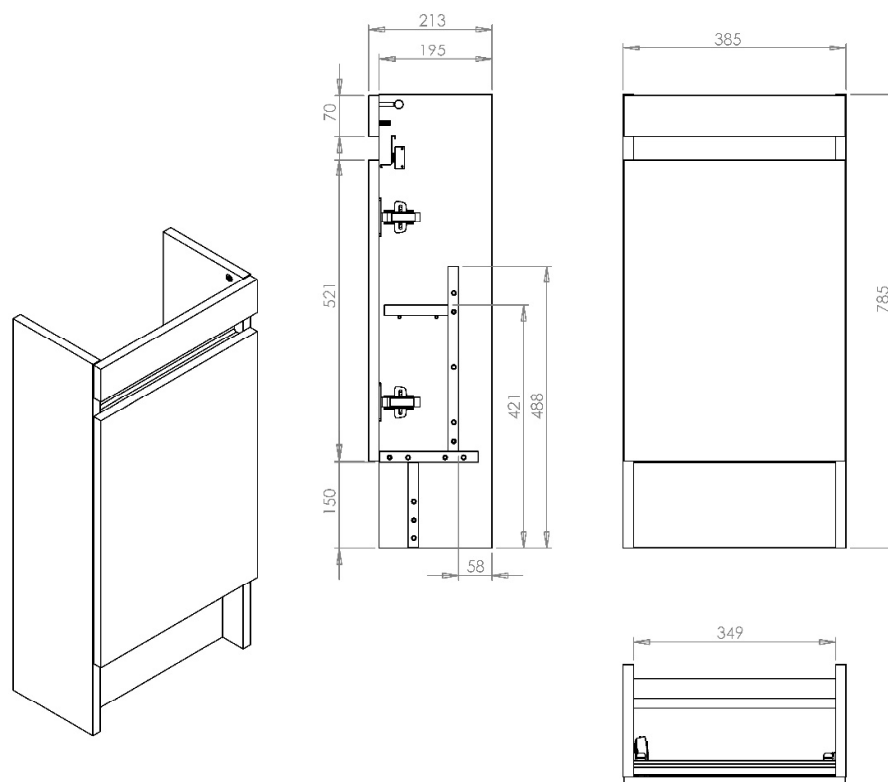
QUBE | QUBE GLIDE – 400 FS Cloakroom Unit**QBE121**, QBE122**, QBE123**, QBE124**, QBE125**, QBE126****

All dimension in mm. Please check dimensions prior to installation as they can vary due to manufacturing tolerances.

Product Details

Type:	Floor Standing Cloakroom Unit
Width:	385
Depth:	213
Height:	785
Product Weight*:	10.3kg
Tolerances:	+/- 2mm
Guarantee Period:	5 Years (For Domestic Use) 1 Years (For Commercial Use)
Drawer Box Capacity:	30kg

Product Specification

Fascia Material:	18mm MFC
Carcass Material:	18mm MFC
Opening Mechanism:	Pull
Trim Options:	Chrome, Matt Black & Brushed Brass
Adjustable Legs:	N/A
Quantity of Shelves:	1 Plus Base
Shelving Type:	MFC
Handing:	Available Left or Right Hand

*Product Weight includes packaging.

Features

- FSC Certified
- Soft Close
- Assembled
- Space Saving

Additional Documentation

Additional Documentation available on our website www.utopiagroup.com

Every effort has been made to ensure that the information provided on this document is correct at the time of creation. Finally, Utopia Furniture Ltd reserve the right to alter materials and specifications in line with continuing programme of production and service development.

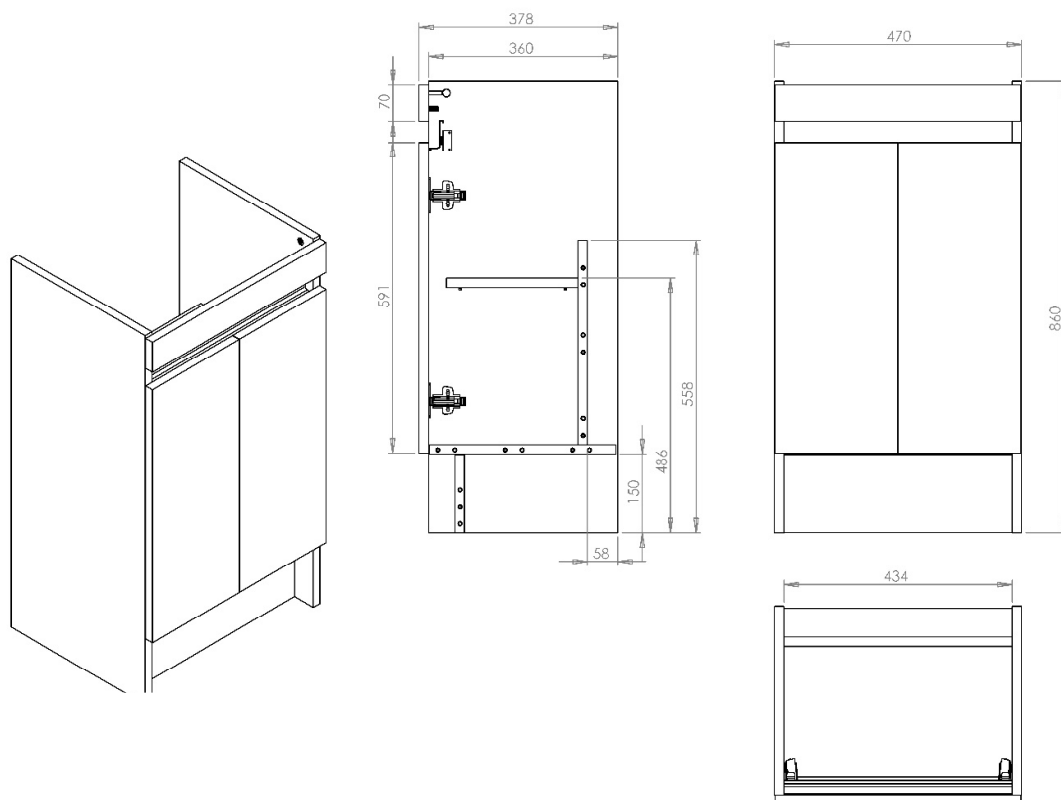
QUBE | QUBE GLIDE – 500 FS Reduced Double Door WBU**QBE142**, QBE143**, QBE144****

All dimension in mm. Please check dimensions prior to installation as they can vary due to manufacturing tolerances.

Product Details

Type:	Floor Standing Double Door Washbasin Unit
Width:	470
Depth:	378
Height:	860
Product Weight*:	19kg
Tolerances:	+/- 2mm
Guarantee Period:	5 Years (For Domestic Use) 1 Years (For Commercial Use)
Drawer Box Capacity:	30kg

Product Specification

Fascia Material:	18mm MFC
Carcass Material:	18mm MFC
Opening Mechanism:	Pull
Trim Options:	Chrome, Matt Black & Brushed Brass
Adjustable Legs:	N/A
Quantity of Shelves:	N/A
Shelving Type:	N/A
Handing:	N/A

*Product Weight includes packaging.

Features

- FSC Certified
- Soft Close
- Assembled
- Space Saving

Additional Documentation

Additional Documentation available on our website www.utopiagroup.com

Every effort has been made to ensure that the information provided on this document is correct at the time of creation. Finally, Utopia Furniture Ltd reserve the right to alter materials and specifications in line with continuing programme of production and service development.

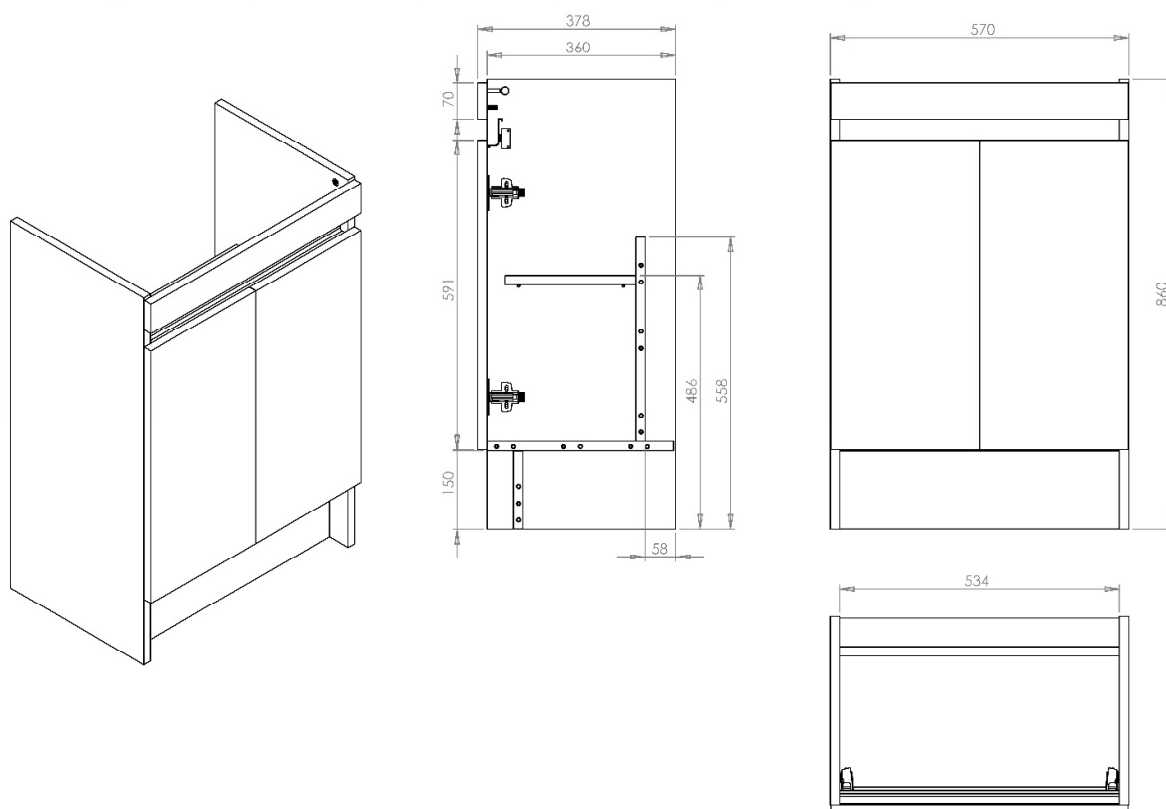
QUBE | QUBE GLIDE – 600 FS Reduced Double Door WBU**QBE145**, QBE146**, QBE147****

All dimension in mm. Please check dimensions prior to installation as they can vary due to manufacturing tolerances.

Product Details

Type:	Floor Standing Double Door Washbasin Unit
Width:	570
Depth:	378
Height:	860
Product Weight*:	21.2kg
Tolerances:	+/- 2mm
Guarantee Period:	5 Years (For Domestic Use) 1 Years (For Commercial Use)
Drawer Box Capacity:	30kg

Product Specification

Fascia Material:	18mm MFC
Carcass Material:	18mm MFC
Opening Mechanism:	Pull
Trim Options:	Chrome, Matt Black & Brushed Brass
Adjustable Legs:	N/A
Quantity of Shelves:	N/A
Shelving Type:	N/A
Handing:	N/A

*Product Weight includes packaging.

Features

- FSC Certified
- Soft Close
- Assembled
- Space Saving

Additional Documentation

Additional Documentation available on our website www.utopiagroup.com

Every effort has been made to ensure that the information provided on this document is correct at the time of creation. Finally, Utopia Furniture Ltd reserve the right to alter materials and specifications in line with continuing programme of production and service development.

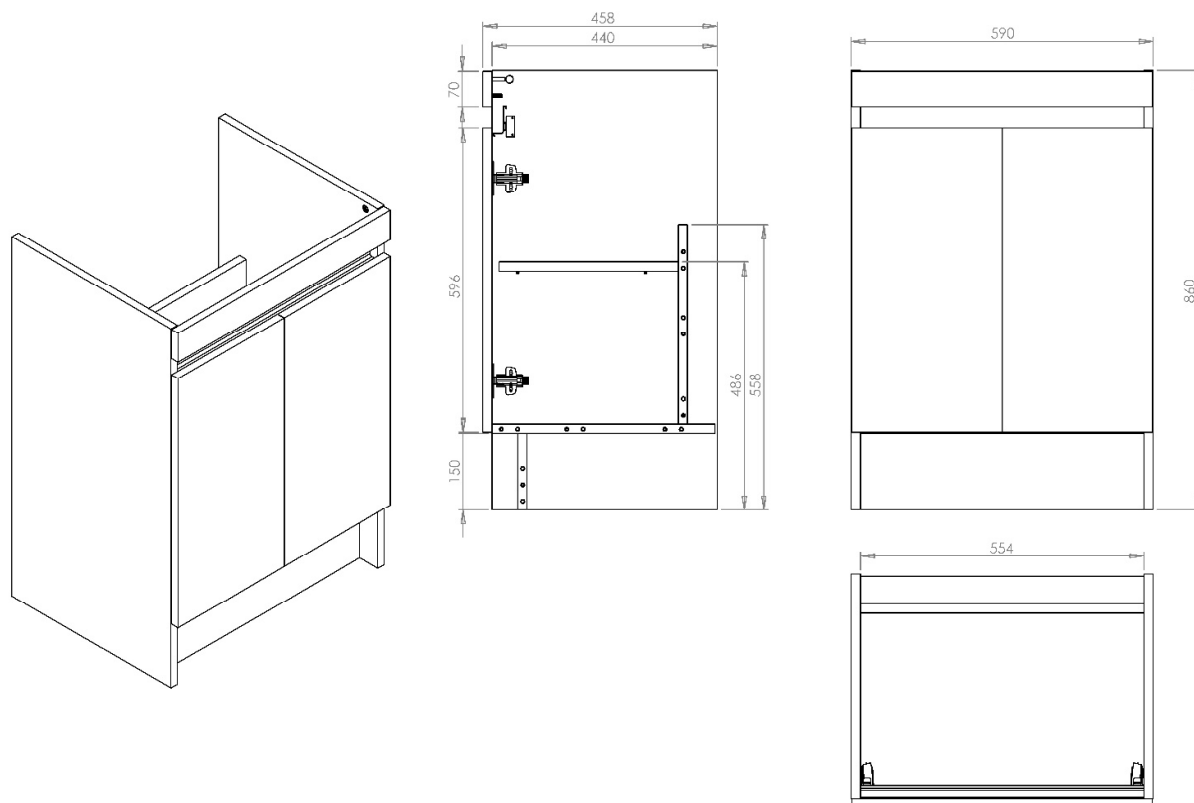
QUBE | QUBE GLIDE – 600 FS Standard Double Door WBU**QBE148**, QBE149**, QBE150****

All dimension in mm. Please check dimensions prior to installation as they can vary due to manufacturing tolerances.

Product Details

Type:	Floor Standing Double Door Washbasin Unit
Width:	590
Depth:	458
Height:	860
Product Weight*:	25.1kg
Tolerances:	+/- 2mm
Guarantee Period:	5 Years (For Domestic Use) 1 Years (For Commercial Use)
Drawer Box Capacity:	30kg

Product Specification

Fascia Material:	18mm MFC
Carcass Material:	18mm MFC
Opening Mechanism:	Pull
Trim Options:	Chrome, Matt Black & Brushed Brass
Adjustable Legs:	N/A
Quantity of Shelves:	N/A
Shelving Type:	N/A
Handing:	N/A

*Product Weight includes packaging.

Features

- FSC Certified
- Soft Close
- Assembled

Additional Documentation

Additional Documentation available on our website www.utopiagroup.com

Every effort has been made to ensure that the information provided on this document is correct at the time of creation. Finally, Utopia Furniture Ltd reserve the right to alter materials and specifications in line with continuing programme of production and service development.

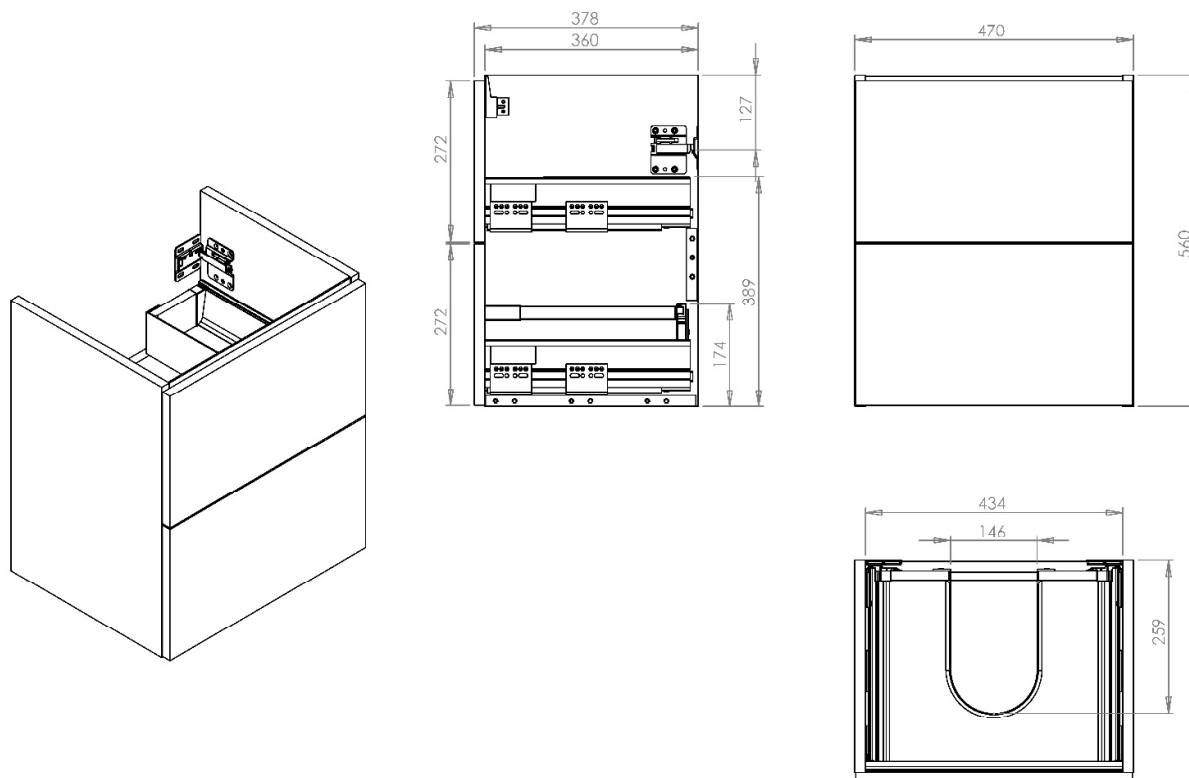
QUBE | QUBE EDGE – 500 WH Reduced Double Drawer WBU**QBE500****

All dimension in mm. Please check dimensions prior to installation as they can vary due to manufacturing tolerances.

Product Details

Type:	Wall Mounted Double Drawer Washbasin Unit
Width:	470
Depth:	378
Height:	560
Product Weight*:	20.17kg
Tolerances:	+/- 2mm
Guarantee Period:	5 Years (For Domestic Use) 1 Years (For Commercial Use)
Drawer Box Capacity:	30kg

Product Specification

Fascia Material:	18mm MFC
Carcass Material:	18mm MFC
Opening Mechanism:	Pull (Handle Sold Separately)
Trim Options:	N/A
Adjustable Legs:	N/A
Quantity of Shelves:	N/A
Shelving Type:	N/A
Handing:	N/A

*Product Weight includes packaging.

Features

- FSC Certified
- Soft Close
- Assembled
- Space Saving

Additional Documentation

Additional Documentation available on our website www.utopiagroup.com

Every effort has been made to ensure that the information provided on this document is correct at the time of creation. Finally, Utopia Furniture Ltd reserve the right to alter materials and specifications in line with continuing programme of production and service development.

QUBE | QUBE EDGE – 600 WH Reduced Double Drawer WBU

QBE501**

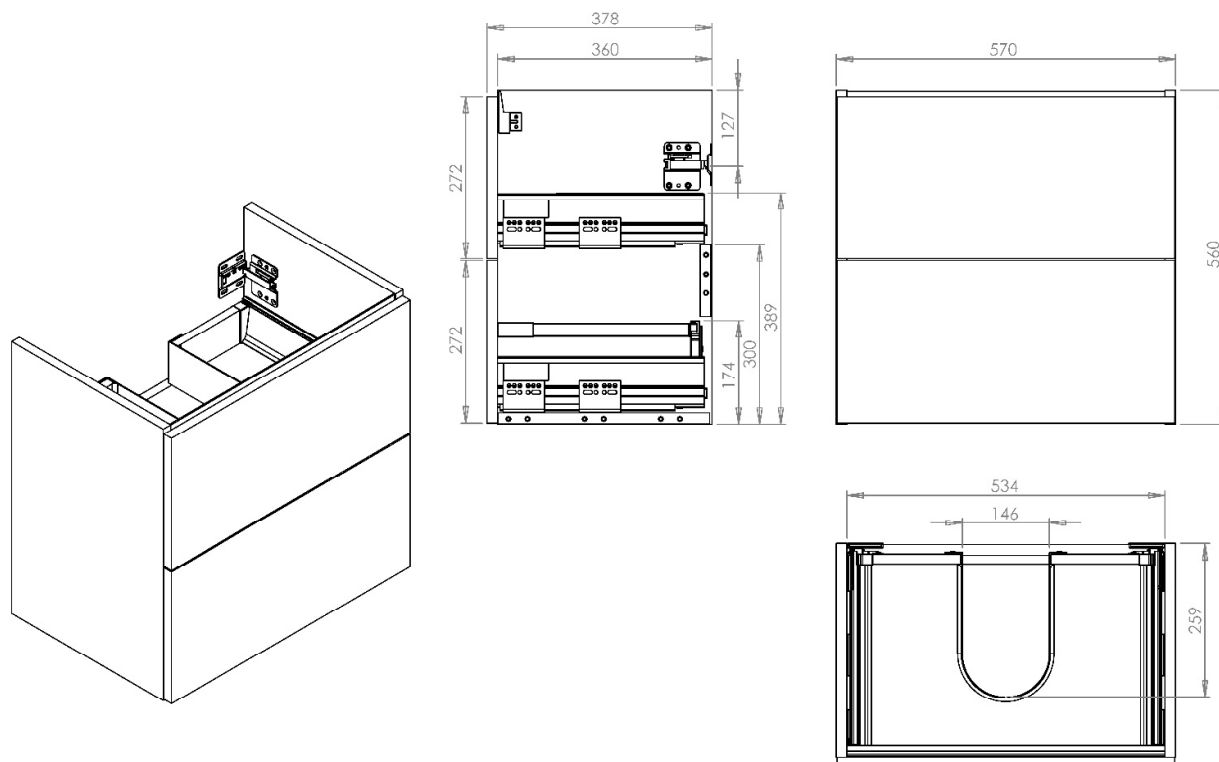

All dimension in mm. Please check dimensions prior to installation as they can vary due to manufacturing tolerances.

Product Details

Type:	Wall Mounted Double Drawer Washbasin Unit
Width:	570
Depth:	378
Height:	560
Product Weight*:	19kg
Tolerances:	+/- 2mm
Guarantee Period:	5 Years (For Domestic Use) 1 Years (For Commercial Use)
Drawer Box Capacity:	30kg

Product Specification

Fascia Material:	18mm MFC
Carcass Material:	18mm MFC
Opening Mechanism:	Pull (Handle Sold Separately)
Trim Options:	N/A
Adjustable Legs:	N/A
Quantity of Shelves:	N/A
Shelving Type:	N/A
Handing:	N/A

*Product Weight includes packaging.

Features

- FSC Certified
- Soft Close
- Assembled
- Space Saving

Additional Documentation

Additional Documentation available on our website www.utopiagroup.com

Every effort has been made to ensure that the information provided on this document is correct at the time of creation. Finally, Utopia Furniture Ltd reserve the right to alter materials and specifications in line with continuing programme of production and service development.

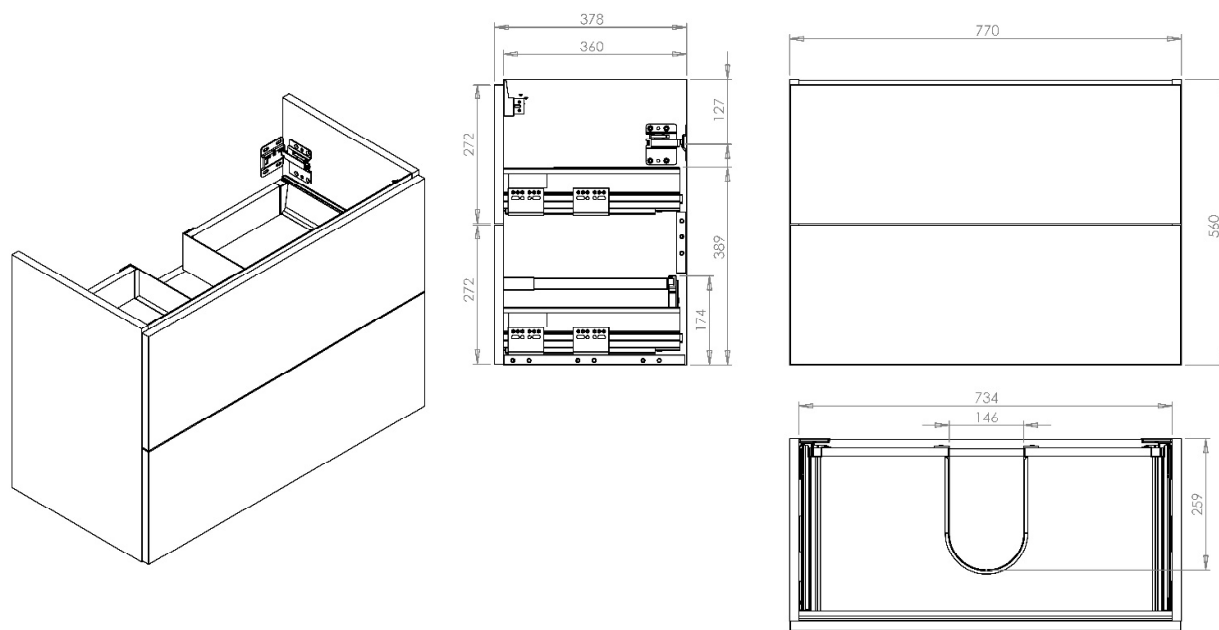
QUBE | QUBE EDGE – 800 WH Reduced Double Drawer WBU**QBE502****

All dimension in mm. Please check dimensions prior to installation as they can vary due to manufacturing tolerances.

Product Details

Type:	Wall Mounted Double Drawer Washbasin Unit
Width:	770
Depth:	378
Height:	560
Product Weight*:	24kg
Tolerances:	+/- 2mm
Guarantee Period:	5 Years (For Domestic Use) 1 Years (For Commercial Use)
Drawer Box Capacity:	30kg

Product Specification

Fascia Material:	18mm MFC
Carcass Material:	18mm MFC
Opening Mechanism:	Pull (Handle Sold Separately)
Trim Options:	N/A
Adjustable Legs:	N/A
Quantity of Shelves:	N/A
Shelving Type:	N/A
Handing:	N/A

*Product Weight includes packaging.

Features

- FSC Certified
- Soft Close
- Assembled
- Space Saving

Additional Documentation

Additional Documentation available on our website www.utopiagroup.com

Every effort has been made to ensure that the information provided on this document is correct at the time of creation. Finally, Utopia Furniture Ltd reserve the right to alter materials and specifications in line with continuing programme of production and service development.

QUBE | QUBE EDGE – 600 WH Standard Double Drawer WBU

QBE503**

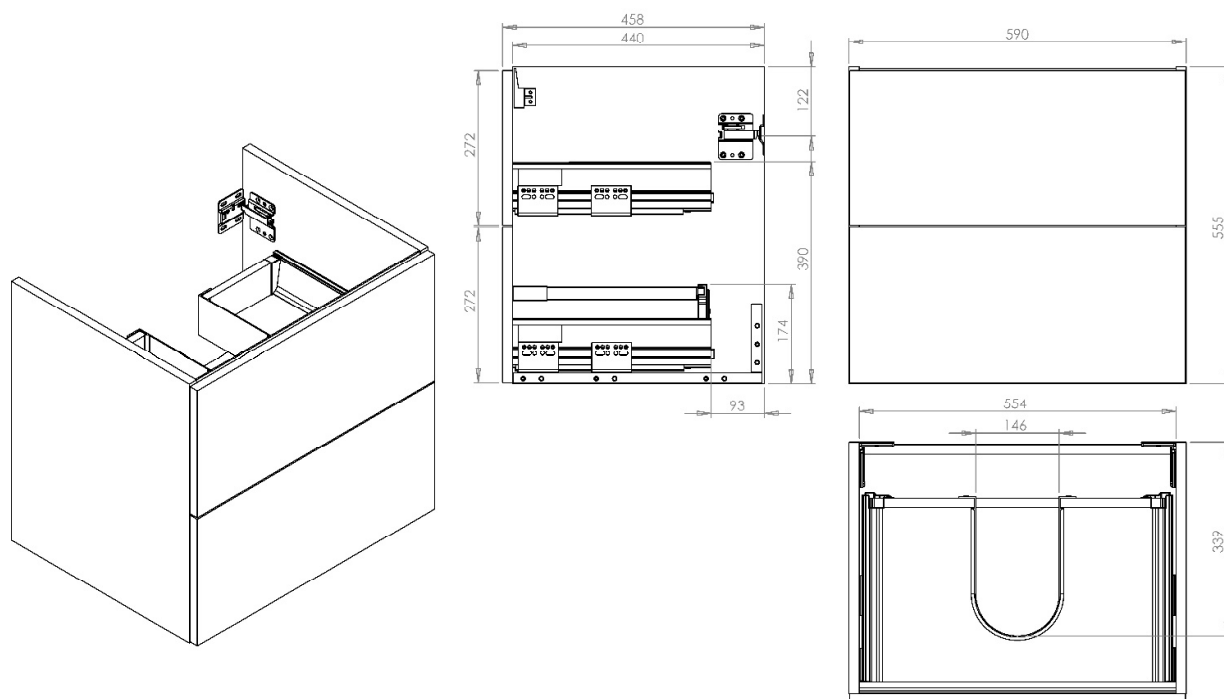

All dimension in mm. Please check dimensions prior to installation as they can vary due to manufacturing tolerances.

Product Details

Type:	Wall Mounted Double Drawer Washbasin Unit
Width:	590
Depth:	458
Height:	555
Product Weight*:	21.5kg
Tolerances:	+/- 2mm
Guarantee Period:	5 Years (For Domestic Use) 1 Years (For Commercial Use)
Drawer Box Capacity:	30kg

Product Specification

Fascia Material:	18mm MFC
Carcass Material:	18mm MFC
Opening Mechanism:	Pull (Handle Sold Separately)
Trim Options:	N/A
Adjustable Legs:	N/A
Quantity of Shelves:	N/A
Shelving Type:	N/A
Handing:	N/A

*Product Weight includes packaging.

Features

- FSC Certified
- Soft Close
- Assembled

Additional Documentation

Additional Documentation available on our website www.utopiagroup.com

Every effort has been made to ensure that the information provided on this document is correct at the time of creation. Finally, Utopia Furniture Ltd reserve the right to alter materials and specifications in line with continuing programme of production and service development.

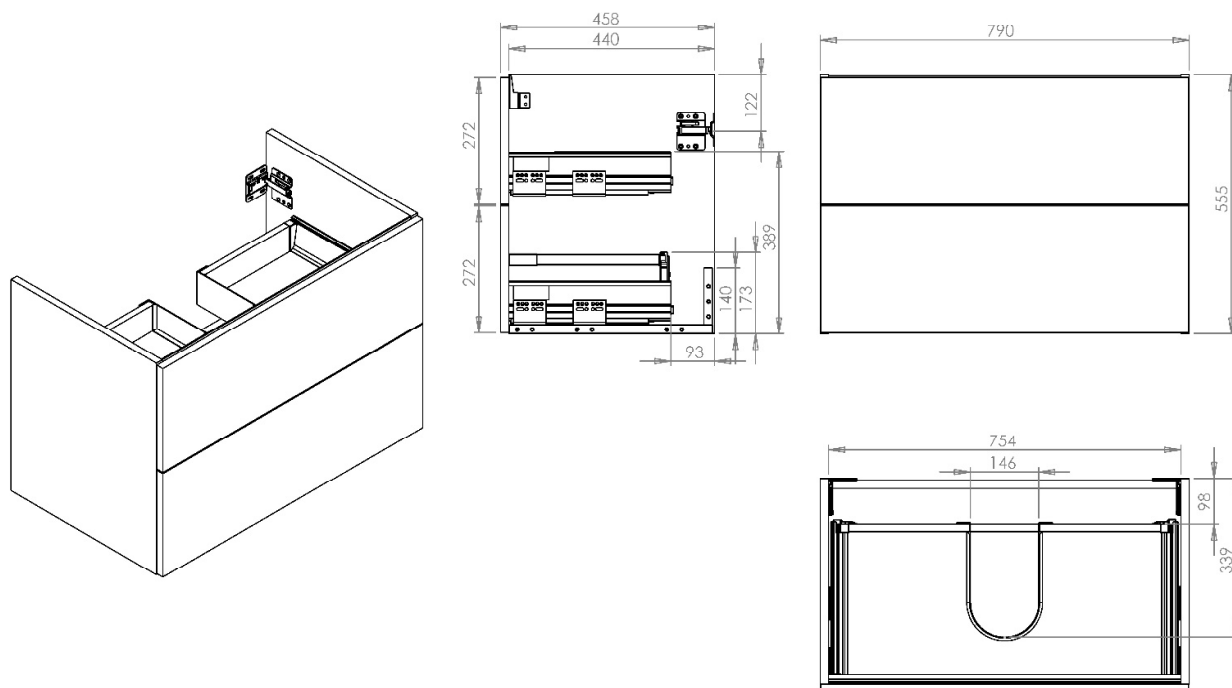
QUBE | QUBE EDGE – 800 WH Standard Double Drawer WBU**QBE504****

All dimension in mm. Please check dimensions prior to installation as they can vary due to manufacturing tolerances.

Product Details

Type:	Wall Mounted Double Drawer Washbasin Unit
Width:	790
Depth:	458
Height:	555
Product Weight*:	26.5kg
Tolerances:	+/- 2mm
Guarantee Period:	5 Years (For Domestic Use) 1 Years (For Commercial Use)
Drawer Box Capacity:	30kg

Product Specification

Fascia Material:	18mm MFC
Carcass Material:	18mm MFC
Opening Mechanism:	Pull (Handle Sold Separately)
Trim Options:	N/A
Adjustable Legs:	N/A
Quantity of Shelves:	N/A
Shelving Type:	N/A
Handing:	N/A

*Product Weight includes packaging.

Features

- FSC Certified
- Soft Close
- Assembled

Additional Documentation

Additional Documentation available on our website www.utopiagroup.com

Every effort has been made to ensure that the information provided on this document is correct at the time of creation. Finally, Utopia Furniture Ltd reserve the right to alter materials and specifications in line with continuing programme of production and service development.

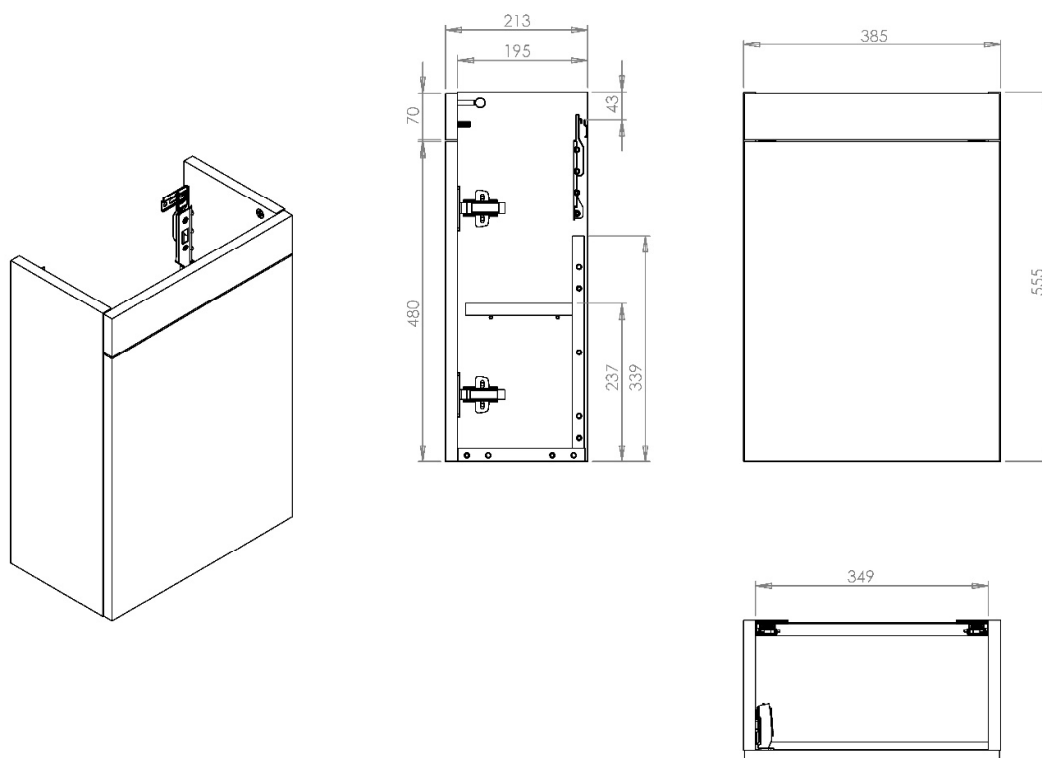
QUBE | QUBE EDGE – 400 WH Cloakroom Unit**QBE505**, QBE506****

All dimension in mm. Please check dimensions prior to installation as they can vary due to manufacturing tolerances.

Product Details

Type:	Wall Mounted Cloakroom Unit
Width:	385
Depth:	213
Height:	555
Product Weight*:	8.9kg
Tolerances:	+/- 2mm
Guarantee Period:	5 Years (For Domestic Use) 1 Years (For Commercial Use)
Drawer Box Capacity:	30kg

Product Specification

Fascia Material:	18mm MFC
Carcass Material:	18mm MFC
Opening Mechanism:	Pull
Trim Options:	Chrome, Matt Black & Brushed Brass
Adjustable Legs:	N/A
Quantity of Shelves:	1 Plus Base
Shelving Type:	MFC
Handing:	Available Left or Right Hand

*Product Weight includes packaging.

Features

- FSC Certified
- Soft Close
- Assembled
- Space Saving

Additional Documentation

Additional Documentation available on our website www.utopiagroup.com

Every effort has been made to ensure that the information provided on this document is correct at the time of creation. Finally, Utopia Furniture Ltd reserve the right to alter materials and specifications in line with continuing programme of production and service development.

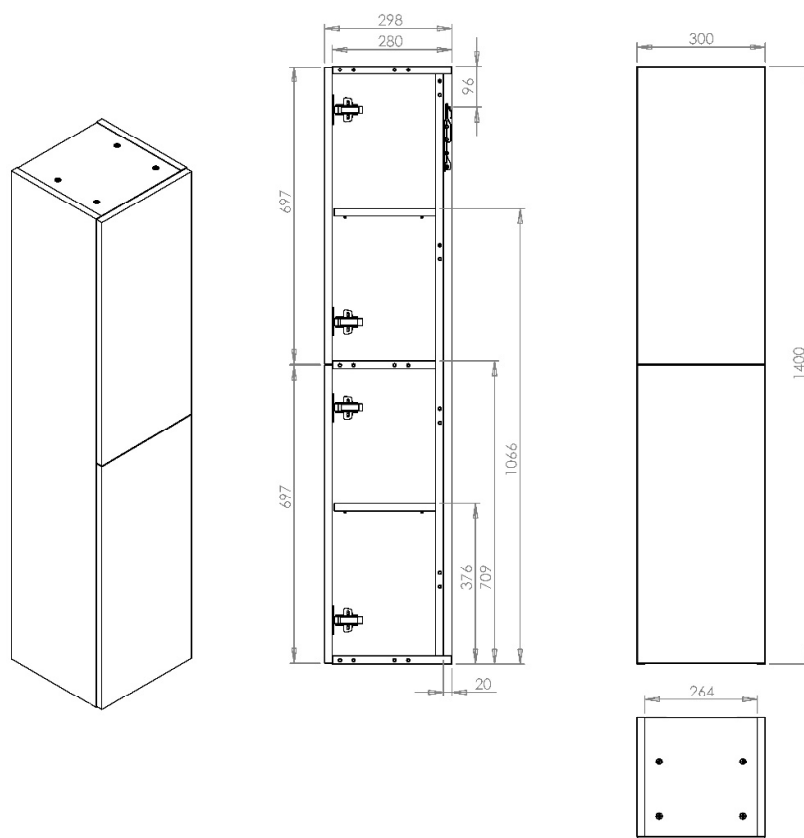
QUBE | QUBE EDGE – 300 Tall Storage Unit**QBE517**, QBE518****

All dimension in mm. Please check dimensions prior to installation as they can vary due to manufacturing tolerances.

Product Details

Type:	Wall Mounted Double Door Tall Storage Unit
Width:	300
Depth:	298
Height:	1400
Product Weight*:	25.5kg
Tolerances:	+/- 2mm
Guarantee Period:	5 Years (For Domestic Use) 1 Years (For Commercial Use)
Drawer Box Capacity:	N/A

Product Specification

Fascia Material:	18mm MFC
Carcass Material:	18mm MFC
Opening Mechanism:	Pull (Handle Sold Separately)
Trim Options:	N/A
Adjustable Legs:	N/A
Quantity of Shelves:	N/A
Shelving Type:	N/A
Handing:	Available Left or Right Hand

*Product Weight includes packaging.

Features

- FSC Certified
- Soft Close
- Assembled

Additional Documentation

Additional Documentation available on our website www.utopiagroup.com

Every effort has been made to ensure that the information provided on this document is correct at the time of creation. Finally, Utopia Furniture Ltd reserve the right to alter materials and specifications in line with continuing programme of production and service development.

QUBE | QUBE EDGE – 500 FS Reduced Double Drawer WBU

QBE509**

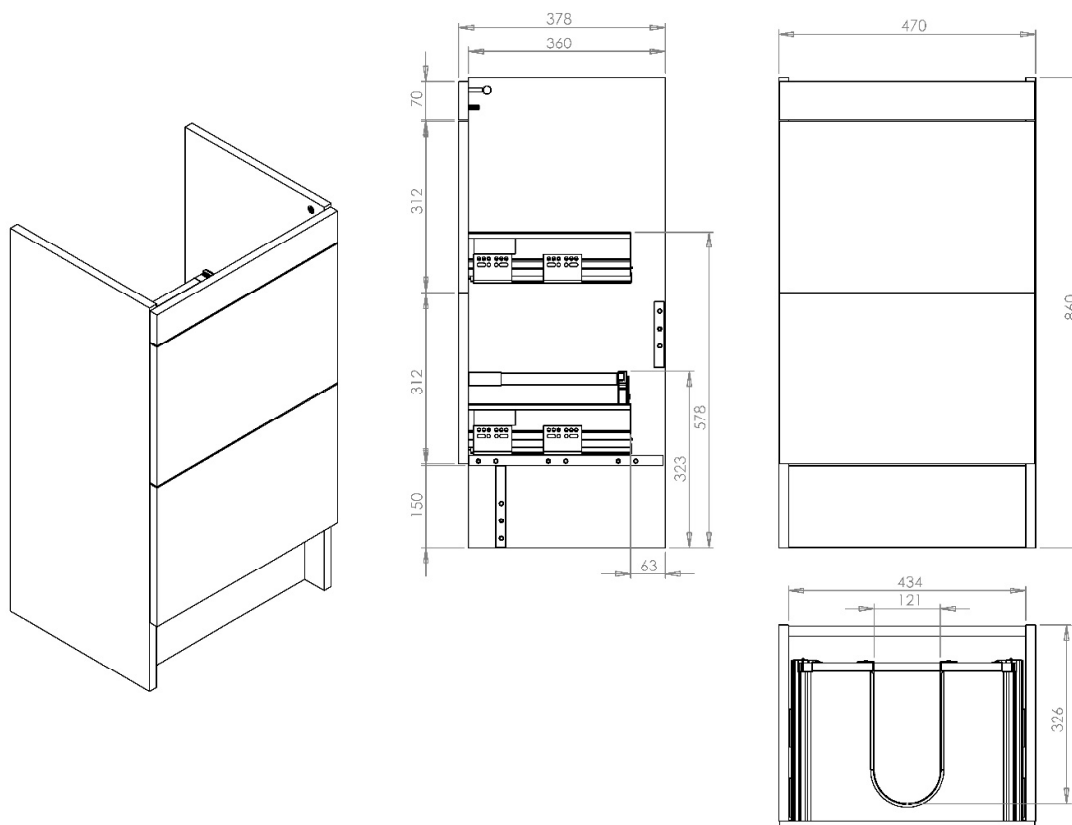

All dimension in mm. Please check dimensions prior to installation as they can vary due to manufacturing tolerances.

Product Details

Type:	Floor Standing Double Drawer Washbasin Unit
Width:	470
Depth:	378
Height:	860
Product Weight*:	17.4kg
Tolerances:	+/- 2mm
Guarantee Period:	5 Years (For Domestic Use) 1 Years (For Commercial Use)
Drawer Box Capacity:	30kg

Product Specification

Fascia Material:	18mm MFC
Carcass Material:	18mm MFC
Opening Mechanism:	Pull
Trim Options:	Chrome, Matt Black & Brushed Brass
Adjustable Legs:	N/A
Quantity of Shelves:	N/A
Shelving Type:	N/A
Handing:	N/A

*Product Weight includes packaging.

Features

- FSC Certified
- Soft Close
- Assembled
- Space Saving

Additional Documentation

Additional Documentation available on our website www.utopiagroup.com

Every effort has been made to ensure that the information provided on this document is correct at the time of creation. Finally, Utopia Furniture Ltd reserve the right to alter materials and specifications in line with continuing programme of production and service development.

QUBE | QUBE EDGE- 600 FS Reduced Double Drawer WBU

QBE510**

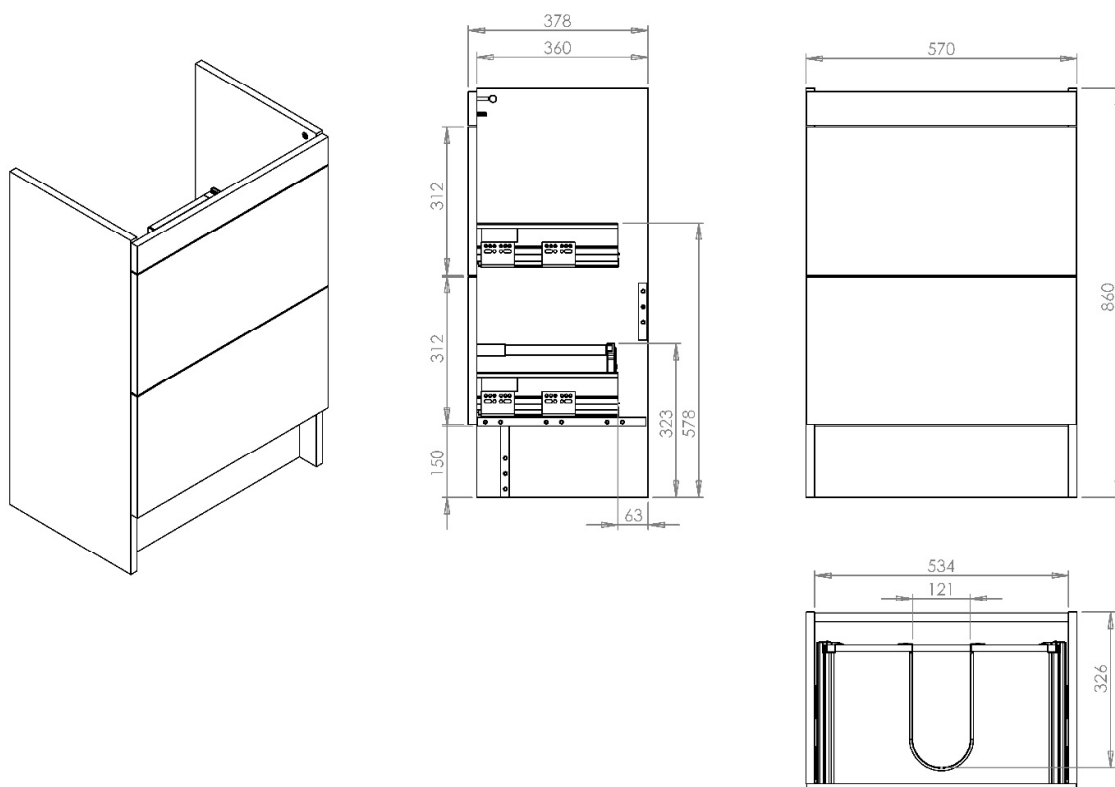

All dimension in mm. Please check dimensions prior to installation as they can vary due to manufacturing tolerances.

Product Details

Type:	Floor Standing Double Drawer Washbasin Unit
Width:	570
Depth:	378
Height:	860
Product Weight*:	23.5kg
Tolerances:	+/- 2mm
Guarantee Period:	5 Years (For Domestic Use) 1 Years (For Commercial Use)
Drawer Box Capacity:	30kg

Product Specification

Fascia Material:	18mm MFC
Carcass Material:	18mm MFC
Opening Mechanism:	Pull (Handle Sold Separately)
Trim Options:	N/A
Adjustable Legs:	N/A
Quantity of Shelves:	N/A
Shelving Type:	N/A
Handing:	N/A

*Product Weight includes packaging.

Features

- FSC Certified
- Soft Close
- Assembled
- Space Saving

Additional Documentation

Additional Documentation available on our website www.utopiagroup.com

Every effort has been made to ensure that the information provided on this document is correct at the time of creation. Finally, Utopia Furniture Ltd reserve the right to alter materials and specifications in line with continuing programme of production and service development.

QUBE | QUBE EDGE – 800 FS Reduced Double Drawer WBU

QBE511**

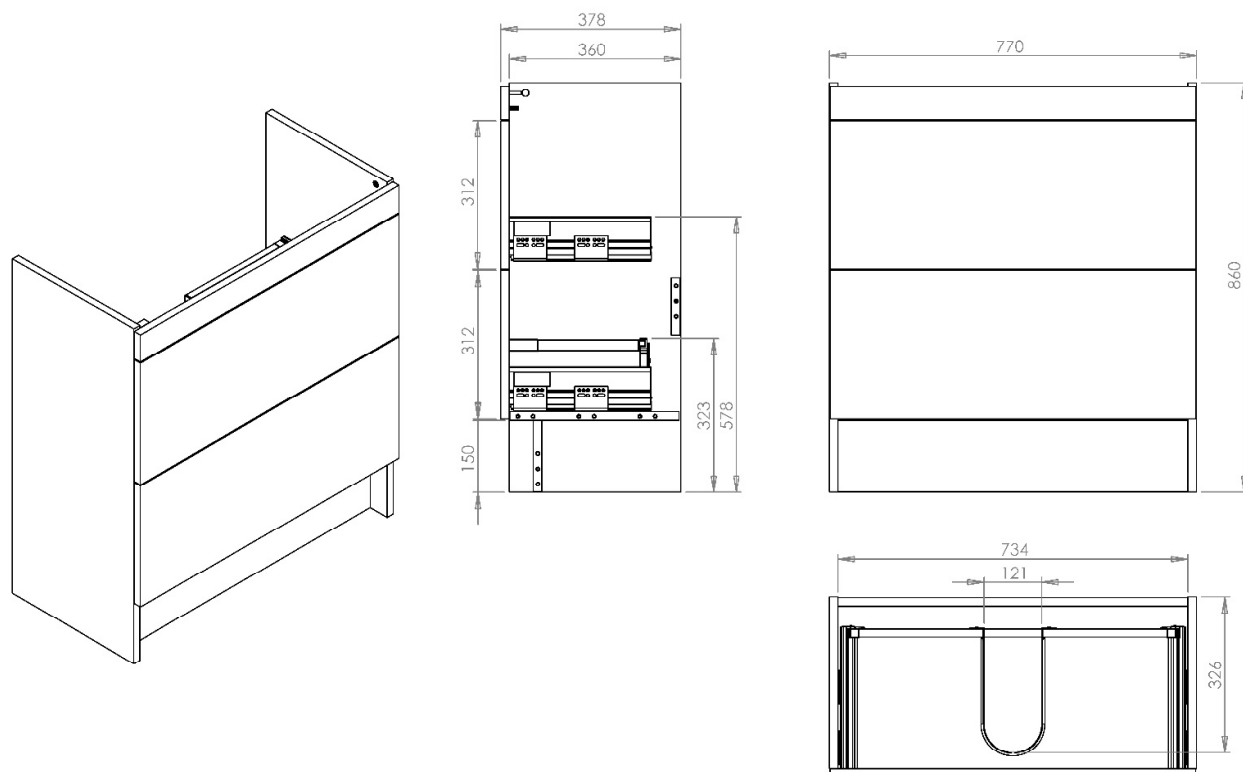

All dimension in mm. Please check dimensions prior to installation as they can vary due to manufacturing tolerances.

Product Details

Type:	Floor Standing Double Drawer Washbasin Unit
Width:	770
Depth:	378
Height:	860
Product Weight*:	26.4kg
Tolerances:	+/- 2mm
Guarantee Period:	5 Years (For Domestic Use) 1 Years (For Commercial Use)
Drawer Box Capacity:	30kg

Product Specification

Fascia Material:	18mm MFC
Carcass Material:	18mm MFC
Opening Mechanism:	Pull (Handle Sold Separately)
Trim Options:	N/A
Adjustable Legs:	N/A
Quantity of Shelves:	N/A
Shelving Type:	N/A
Handing:	N/A

*Product Weight includes packaging.

Features

- FSC Certified
- Soft Close
- Assembled

Additional Documentation

Additional Documentation available on our website www.utopiagroup.com

Every effort has been made to ensure that the information provided on this document is correct at the time of creation. Finally, Utopia Furniture Ltd reserve the right to alter materials and specifications in line with continuing programme of production and service development.

QUBE | QUBE EDGE – 600 FS Standard Double Drawer WBU

QBE512**

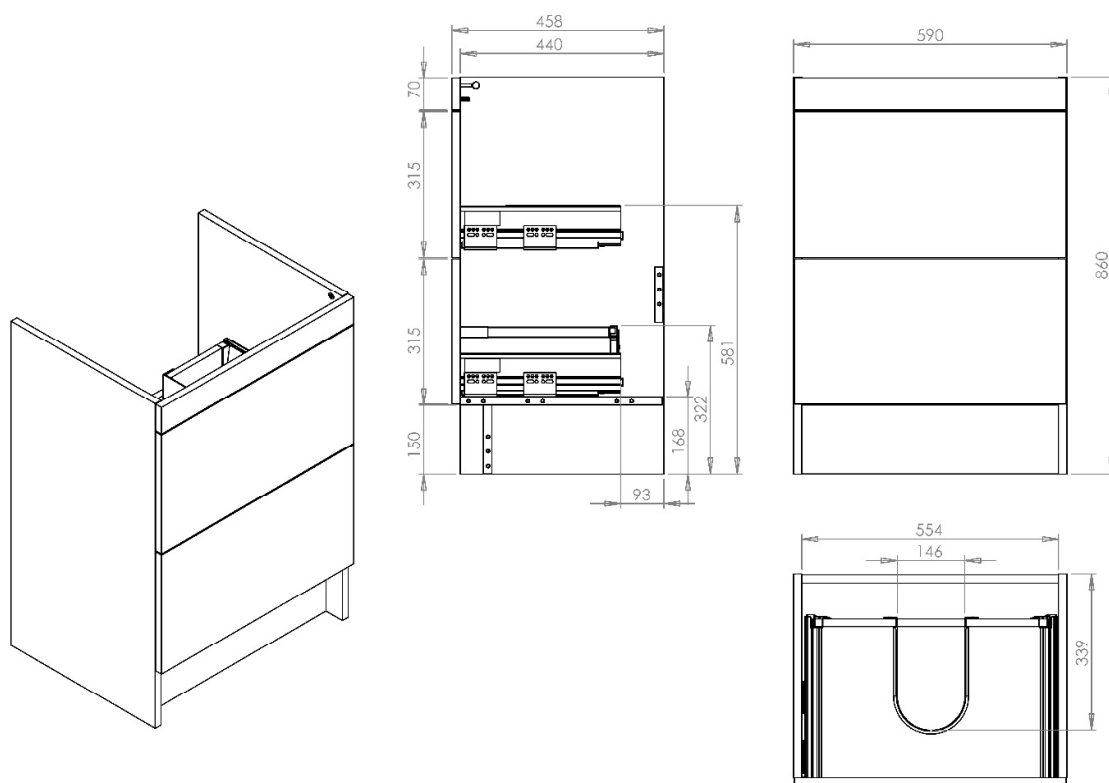

All dimension in mm. Please check dimensions prior to installation as they can vary due to manufacturing tolerances.

Product Details

Type:	Floor Standing Double Drawer Washbasin Unit
Width:	590
Depth:	458
Height:	860
Product Weight*:	31.7kg
Tolerances:	+/- 2mm
Guarantee Period:	5 Years (For Domestic Use) 1 Years (For Commercial Use)
Drawer Box Capacity:	30kg

Product Specification

Fascia Material:	18mm MFC
Carcass Material:	18mm MFC
Opening Mechanism:	Pull (Handle Sold Separately)
Trim Options:	N/A
Adjustable Legs:	N/A
Quantity of Shelves:	N/A
Shelving Type:	N/A
Handing:	N/A

*Product Weight includes packaging.

Features

- FSC Certified
- Soft Close
- Assembled

Additional Documentation

Additional Documentation available on our website www.utopiagroup.com

Every effort has been made to ensure that the information provided on this document is correct at the time of creation. Finally, Utopia Furniture Ltd reserve the right to alter materials and specifications in line with continuing programme of production and service development.

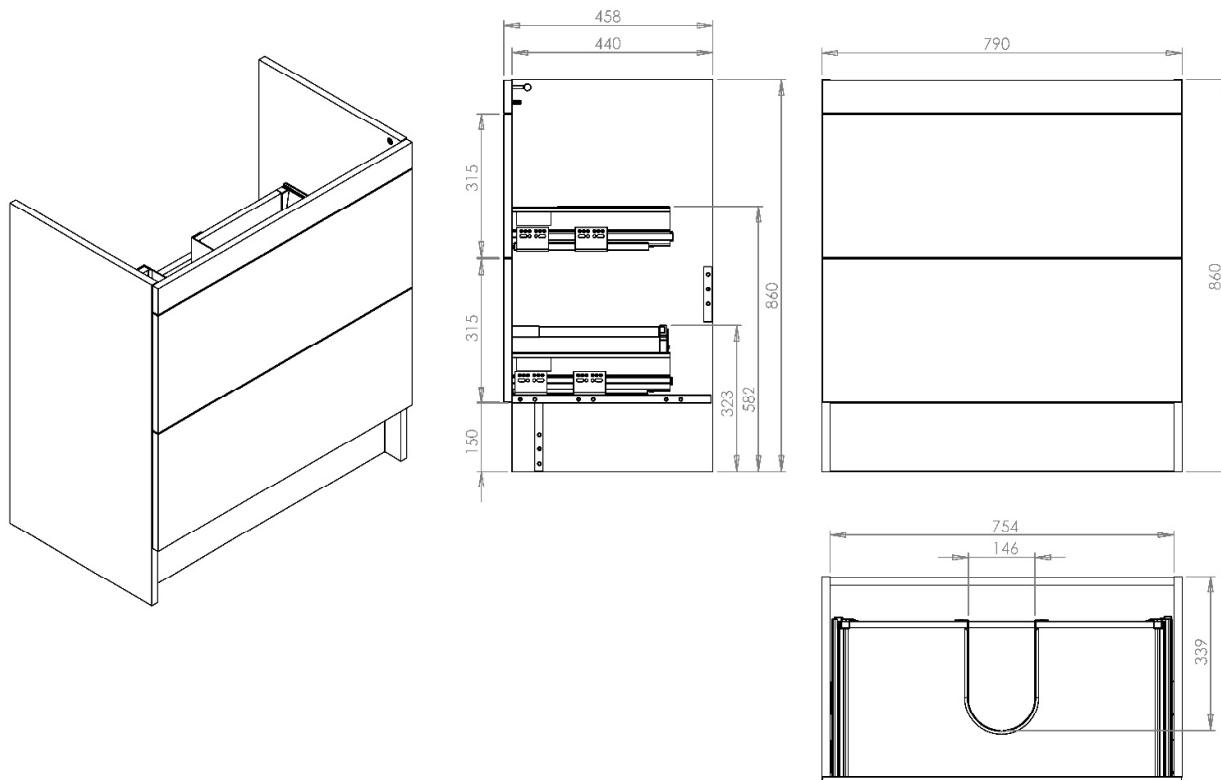
QUBE | QUBE GLIDE – 800 FS Standard Double Drawer WBU**QBE513****

All dimension in mm. Please check dimensions prior to installation as they can vary due to manufacturing tolerances.

Product Details

Type:	Floor Standing Double Drawer Washbasin Unit
Width:	790
Depth:	458
Height:	860
Product Weight*:	31.7kg
Tolerances:	+/- 2mm
Guarantee Period:	5 Years (For Domestic Use) 1 Years (For Commercial Use)
Drawer Box Capacity:	30kg

Product Specification

Fascia Material:	18mm MFC
Carcass Material:	18mm MFC
Opening Mechanism:	Pull (Handle Sold Separately)
Trim Options:	N/A
Adjustable Legs:	N/A
Quantity of Shelves:	N/A
Shelving Type:	N/A
Handing:	N/A

*Product Weight includes packaging.

Features

- FSC Certified
- Soft Close
- Assembled

Additional Documentation

Additional Documentation available on our website www.utopiagroup.com

Every effort has been made to ensure that the information provided on this document is correct at the time of creation. Finally, Utopia Furniture Ltd reserve the right to alter materials and specifications in line with continuing programme of production and service development.

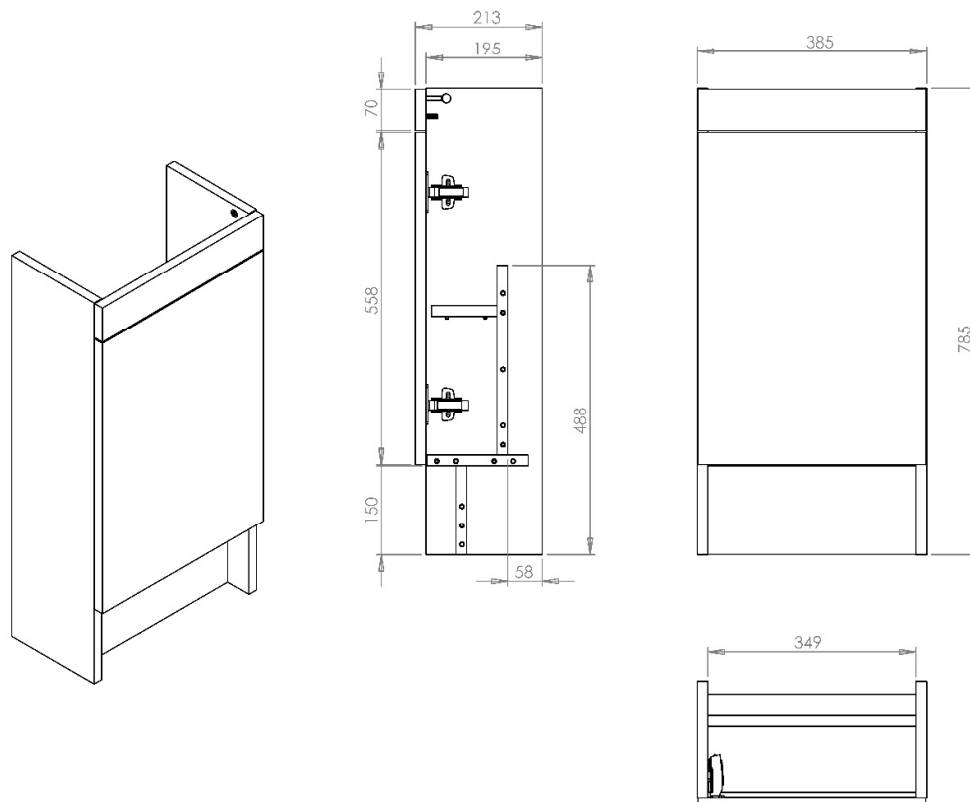
QUBE | QUBE EDGE – 400 FS Cloakroom Unit**QBE507**, QBE508****

All dimension in mm. Please check dimensions prior to installation as they can vary due to manufacturing tolerances.

Product Details

Type:	Floor Standing Cloakroom Unit
Width:	385
Depth:	213
Height:	785
Product Weight*:	10.3kg
Tolerances:	+/- 2mm
Guarantee Period:	5 Years (For Domestic Use) 1 Years (For Commercial Use)
Drawer Box Capacity:	30kg

Product Specification

Fascia Material:	18mm MFC
Carcass Material:	18mm MFC
Opening Mechanism:	Pull (Handle Sold Separately)
Trim Options:	N/A
Adjustable Legs:	N/A
Quantity of Shelves:	1 Plus Base
Shelving Type:	MFC
Handing:	Available Left or Right Hand

*Product Weight includes packaging.

Features

- FSC Certified
- Soft Close
- Assembled
- Space Saving

Additional Documentation

Additional Documentation available on our website www.utopiagroup.com

Every effort has been made to ensure that the information provided on this document is correct at the time of creation. Finally, Utopia Furniture Ltd reserve the right to alter materials and specifications in line with continuing programme of production and service development.

QUBE | QUBE EDGE – 500 FS Reduced Double Door WBU

QBE514**

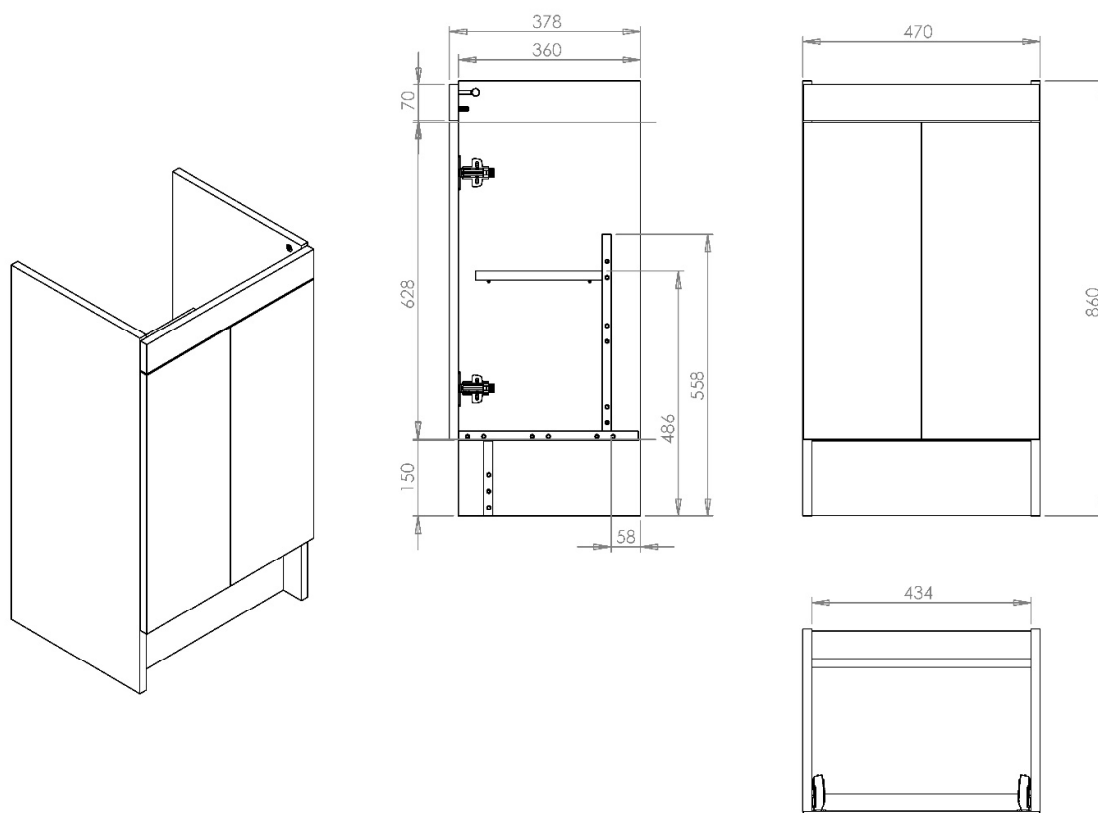

All dimension in mm. Please check dimensions prior to installation as they can vary due to manufacturing tolerances.

Product Details

Type:	Floor Standing Double Door Washbasin Unit
Width:	470
Depth:	378
Height:	860
Product Weight*:	19kg
Tolerances:	+/- 2mm
Guarantee Period:	5 Years (For Domestic Use) 1 Years (For Commercial Use)
Drawer Box Capacity:	30kg

Product Specification

Fascia Material:	18mm MFC
Carcass Material:	18mm MFC
Opening Mechanism:	Pull (Handle Sold Separately)
Trim Options:	Chrome, Matt Black & Brushed Brass
Adjustable Legs:	N/A
Quantity of Shelves:	N/A
Shelving Type:	N/A
Handing:	N/A

*Product Weight includes packaging.

Features

- FSC Certified
- Soft Close
- Assembled
- Space Saving

Additional Documentation

Additional Documentation available on our website www.utopiagroup.com

Every effort has been made to ensure that the information provided on this document is correct at the time of creation. Finally, Utopia Furniture Ltd reserve the right to alter materials and specifications in line with continuing programme of production and service development.

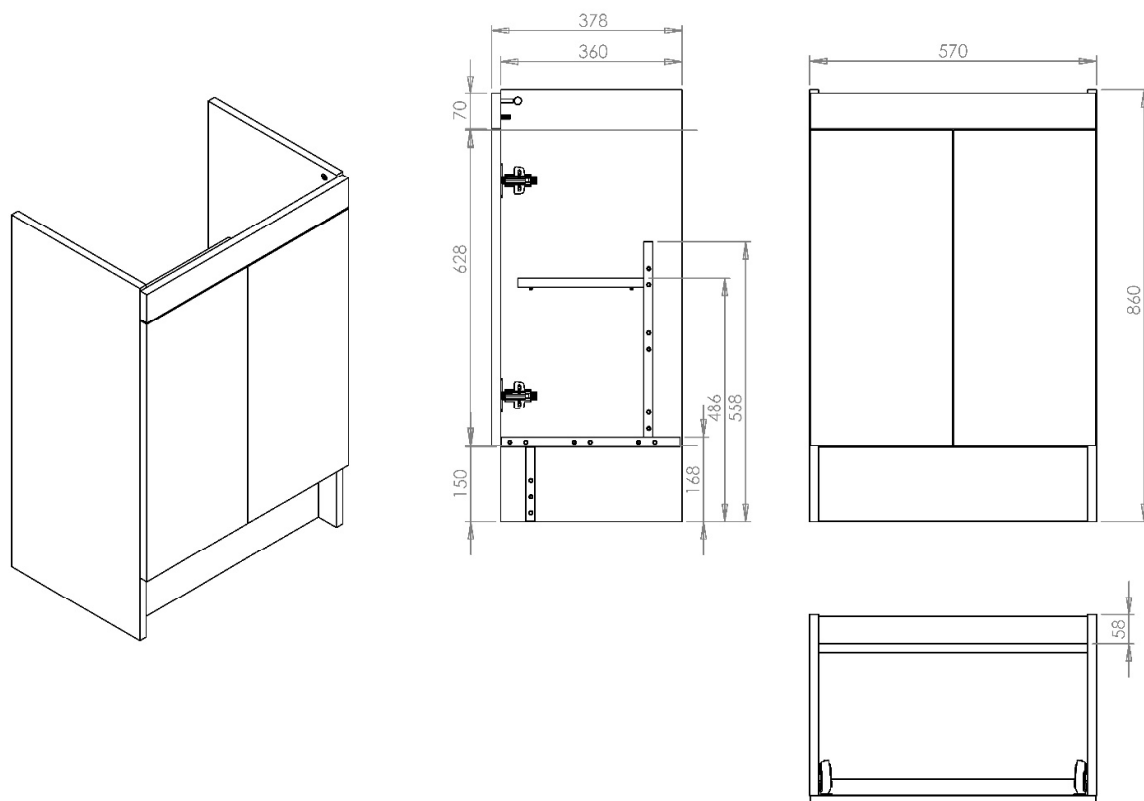
QUBE | QUBE EDGE- 600 FS Reduced Double Door WBU**QBE515****

All dimension in mm. Please check dimensions prior to installation as they can vary due to manufacturing tolerances.

Product Details

Type:	Floor Standing Double Door Washbasin Unit
Width:	570
Depth:	378
Height:	860
Product Weight*:	21.2kg
Tolerances:	+/- 2mm
Guarantee Period:	5 Years (For Domestic Use) 1 Years (For Commercial Use)
Drawer Box Capacity:	30kg

Product Specification

Fascia Material:	18mm MFC
Carcass Material:	18mm MFC
Opening Mechanism:	Pull (Handle Sold Separately)
Trim Options:	N/A
Adjustable Legs:	N/A
Quantity of Shelves:	N/A
Shelving Type:	N/A
Handing:	N/A

*Product Weight includes packaging.

Features

- FSC Certified
- Soft Close
- Assembled
- Space Saving

Additional Documentation

Additional Documentation available on our website www.utopiagroup.com

Every effort has been made to ensure that the information provided on this document is correct at the time of creation. Finally, Utopia Furniture Ltd reserve the right to alter materials and specifications in line with continuing programme of production and service development.

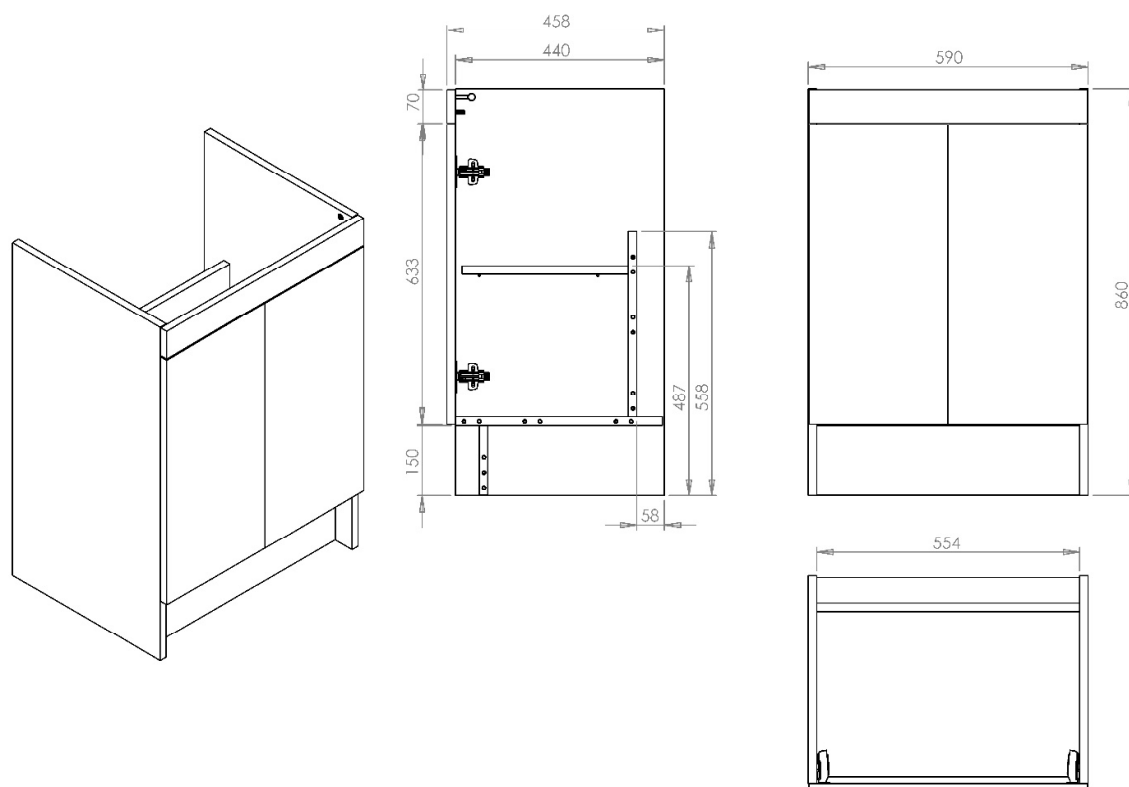
QUBE | QUBE EDGE- 600 FS Standard Double Door WBU**QBE516****

All dimension in mm. Please check dimensions prior to installation as they can vary due to manufacturing tolerances.

Product Details

Type:	Floor Standing Double Door Washbasin Unit
Width:	590
Depth:	458
Height:	860
Product Weight*:	25.1kg
Tolerances:	+/- 2mm
Guarantee Period:	5 Years (For Domestic Use) 1 Years (For Commercial Use)
Drawer Box Capacity:	30kg

Product Specification

Fascia Material:	18mm MFC
Carcass Material:	18mm MFC
Opening Mechanism:	Pull (Handle Sold Separately)
Trim Options:	N/A
Adjustable Legs:	N/A
Quantity of Shelves:	N/A
Shelving Type:	N/A
Handing:	N/A

*Product Weight includes packaging.

Features

- FSC Certified
- Soft Close
- Assembled

Additional Documentation

Additional Documentation available on our website www.utopiagroup.com

Every effort has been made to ensure that the information provided on this document is correct at the time of creation. Finally, Utopia Furniture Ltd reserve the right to alter materials and specifications in line with continuing programme of production and service development.

QUBE | QUBE – 200mm Reduced Base Open Shelf Unit

QBE151**

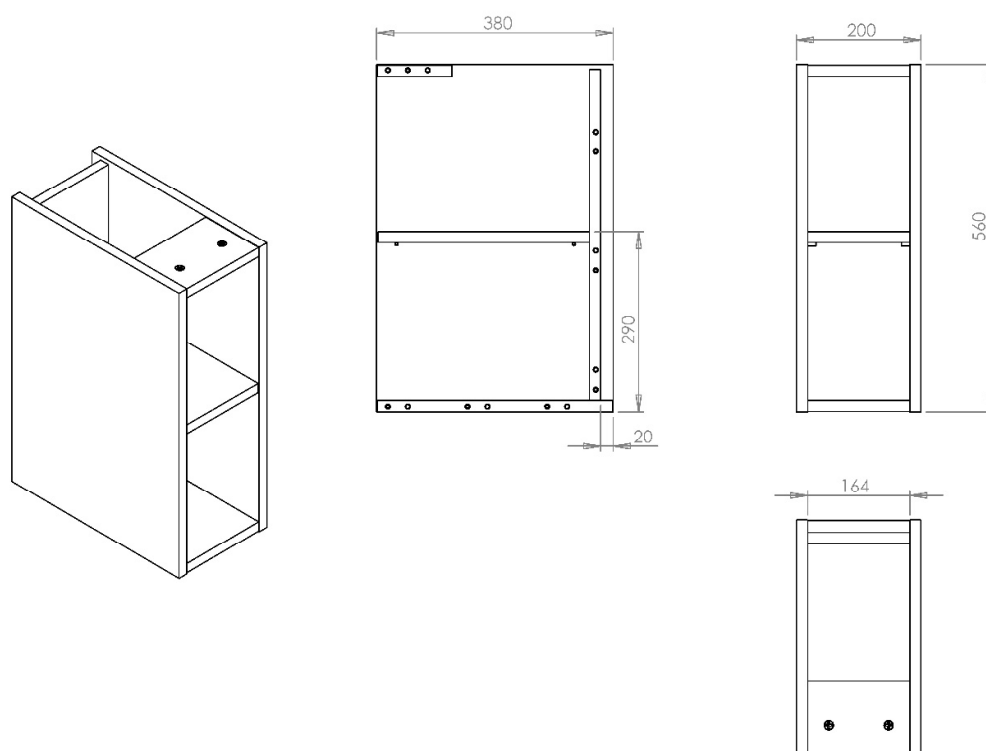

All dimension in mm. Please check dimensions prior to installation as they can vary due to manufacturing tolerances.

Product Details

Type:	Wall Mounted Base Open Shelf
Width:	200
Depth:	380
Height:	560
Product Weight*:	8.5kg
Tolerances:	+/- 2mm
Guarantee Period:	5 Years (For Domestic Use) 1 Years (For Commercial Use)
Drawer Box Capacity:	N/A

Product Specification

Fascia Material:	N/A
Carcass Material:	18mm MFC
Opening Mechanism:	N/A
Trim Options:	N/A
Adjustable Legs:	N/A
Quantity of Shelves:	1 Plus Base
Shelving Type:	MFC
Handing:	N/A

*Product Weight includes packaging.

Features

- FSC Certified
- Soft Close
- Assembled

Additional Documentation

Additional Documentation available on our website www.utopiagroup.com

Every effort has been made to ensure that the information provided on this document is correct at the time of creation. Finally, Utopia Furniture Ltd reserve the right to alter materials and specifications in line with continuing programme of production and service development.

QUBE | QUBE – 200mm Standard Base Open Shelf Unit

QBE152**

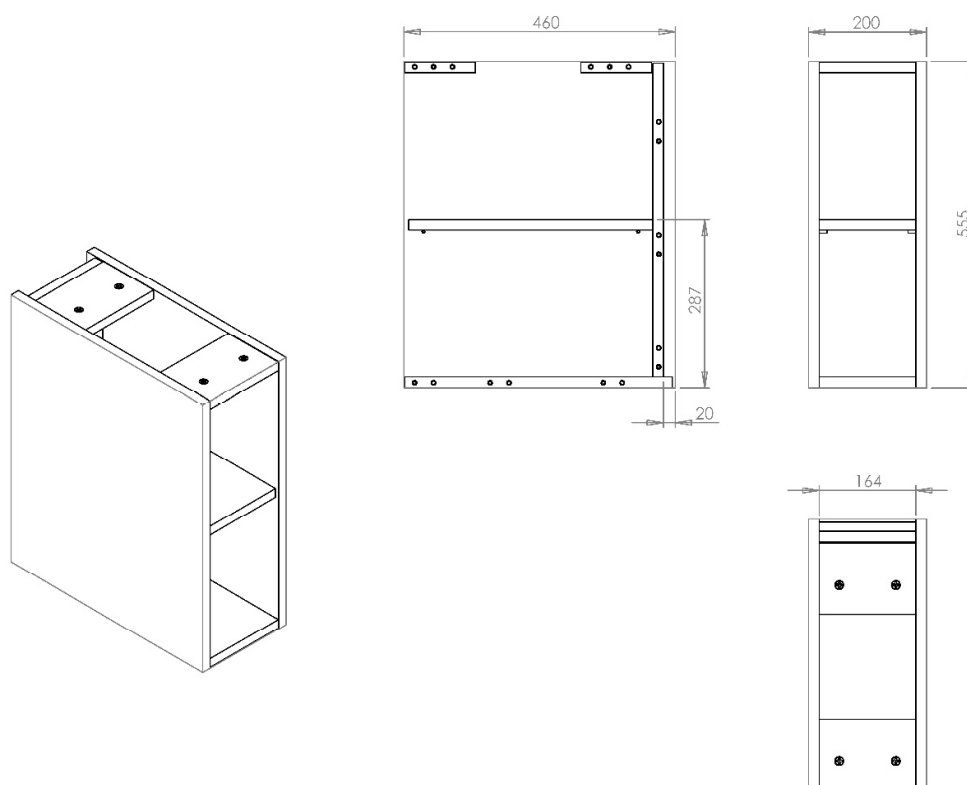

All dimension in mm. Please check dimensions prior to installation as they can vary due to manufacturing tolerances.

Product Details

Type:	Wall Mounted Base Open Shelf
Width:	200
Depth:	460
Height:	555
Product Weight*:	7.2kg
Tolerances:	+/- 2mm
Guarantee Period:	5 Years (For Domestic Use) 1 Years (For Commercial Use)
Drawer Box Capacity:	N/A

Product Specification

Fascia Material:	N/A
Carcass Material:	18mm MFC
Opening Mechanism:	N/A
Trim Options:	N/A
Adjustable Legs:	N/A
Quantity of Shelves:	1 Plus Base
Shelving Type:	MFC
Handing:	N/A

*Product Weight includes packaging.

Features

- FSC Certified
- Soft Close
- Assembled

Additional Documentation

Additional Documentation available on our website www.utopiagroup.com

Every effort has been made to ensure that the information provided on this document is correct at the time of creation. Finally, Utopia Furniture Ltd reserve the right to alter materials and specifications in line with continuing programme of production and service development.

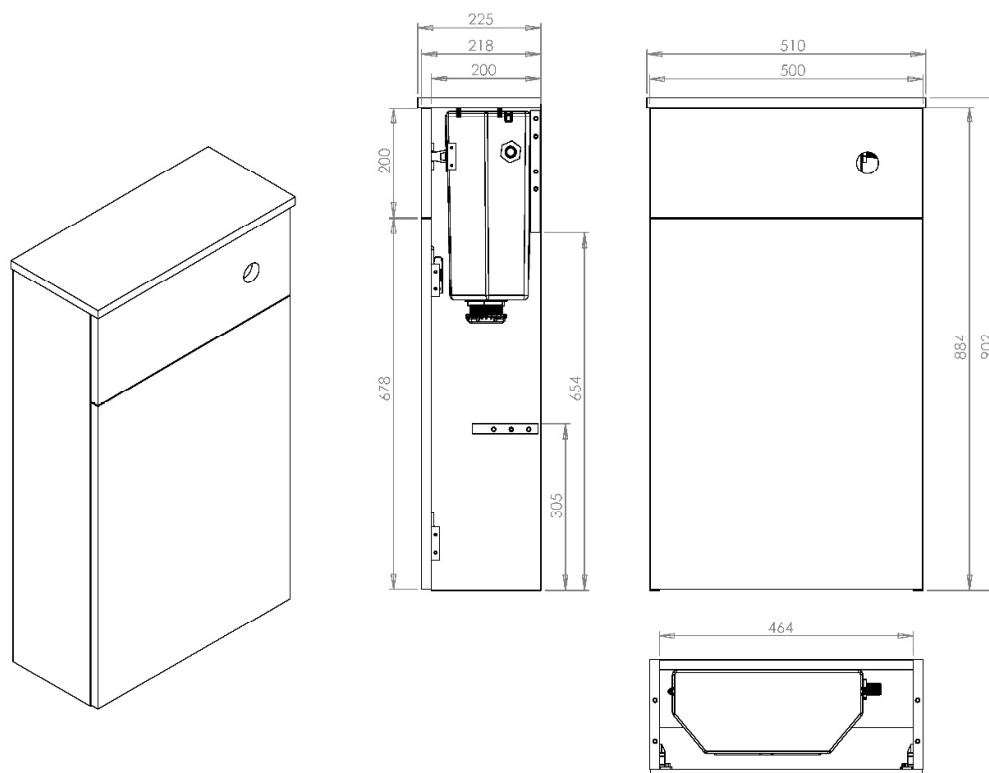
QUBE | QUBE EDGE FITTED- 510mm Modular WC Unit**QBE154** (Exc Cistern), QBE155** (Inc Cistern)**

All dimension in mm. Please check dimensions prior to installation as they can vary due to manufacturing tolerances.

Product Details

Type:	Modular Standard Depth WC Unit
Width:	500
Depth:	225
Height:	902
Product Weight*:	11.1kg (Exc Cistern), 12.1kg (Inc Cistern)
Tolerances:	+/- 2mm
Guarantee Period:	5 Years (For Domestic Use) 1 Years (For Commercial Use)
Drawer Box Capacity:	N/A

Product Specification

Fascia Material:	18mm MFC
Carcass Material:	18mm MFC
Opening Mechanism:	N/A
Trim Options:	N/A
Adjustable Legs:	N/A
Quantity of Shelves:	N/A
Shelving Type:	N/A
Handing:	N/A

*Product Weight includes packaging.

Features

- FSC Certified
- Assembled

Additional Documentation

Additional Documentation available on our website www.utopiagroup.com

Every effort has been made to ensure that the information provided on this document is correct at the time of creation. Finally, Utopia Furniture Ltd reserve the right to alter materials and specifications in line with continuing programme of production and service development.



QUBE | QUBE EDGE FITTED- 510mm Modular WC Unit

QBE156**

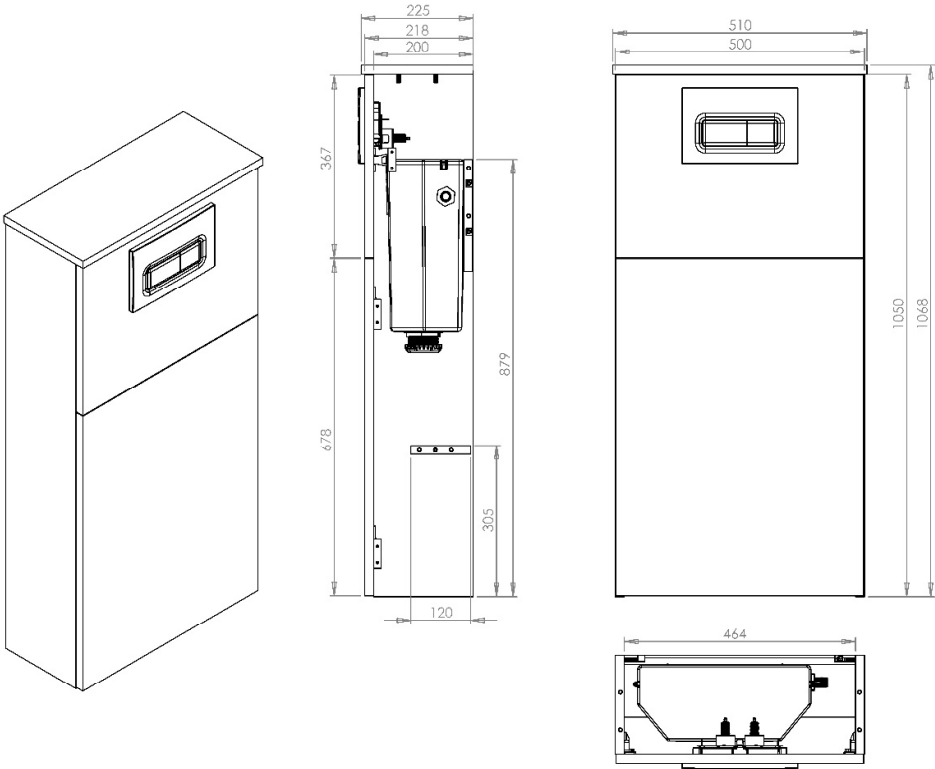

All dimension in mm. Please check dimensions prior to installation as they can vary due to manufacturing tolerances.

Product Details

Type:	Modular Tall WC Unit
Width:	510
Depth:	225
Height:	1068
Product Weight*:	17.2kg (Inc Cistern)
Tolerances:	+/- 2mm
Guarantee Period:	5 Years (For Domestic Use) 1 Years (For Commercial Use)
Drawer Box Capacity:	N/A

Product Specification

Fascia Material:	18mm MFC
Carcass Material:	18mm MFC
Opening Mechanism:	N/A
Trim Options:	N/A
Adjustable Legs:	N/A
Quantity of Shelves:	N/A
Shelving Type:	N/A
Handing:	N/A

*Product Weight includes packaging.

Features

- FSC Certified
- Assembled

Additional Documentation

Additional Documentation available on our website www.utopiagroup.com

Every effort has been made to ensure that the information provided on this document is correct at the time of creation. Finally, Utopia Furniture Ltd reserve the right to alter materials and specifications in line with continuing programme of production and service development.