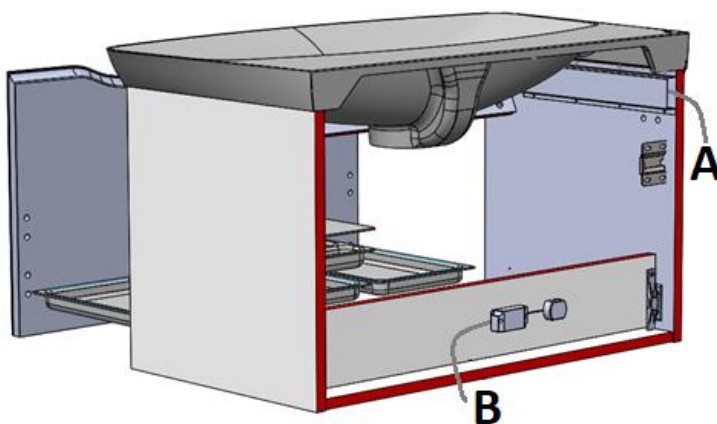

**Important Information**

- Read the instructions carefully.
- Check the product for any signs of damage and remove any protective film.
- It is recommended that a technically competent installer undertakes installation. The electrical connections should be made by a suitably qualified Part P registered electrician in accordance with current IEE & Building Regulations.
- It is the installer's responsibility to carry out a thorough assessment of wall type and the weight of the cabinet and use appropriate fixings.
- Care should be taken when drilling walls to avoid any hidden wires or pipes.
- The terminal block (not supplied, see fig. 1) used to connect the leads to the electrical supply can be of either the screw- or screw-less type and should be rated at 240V 6A with 4 terminals. The cable tails do not need to be crimped when connected to the terminal block.
- This product should be used only with a mains supply that is protected by a Residual Current Device.
- This product is IP20 Rated and is only suitable for installation outside zones 0, 1 and 2 in a bathroom.

**Connection to Mains Electrics**

1. Turn off the electrical supply. Connect the cables from the under-cabinet light and the internal light (A) to the driver connector block (B).
2. Connect the driver cable (B) to the electrical supply in the bathroom using a terminal block (not supplied). It is recommended that this is connected to a switched electrical feed or to a room motion sensor.
3. Turn the electrical supply back on and check that the lights function as required.

**WARNING  
RISK OF ELECTRIC SHOCK**

Turn off Mains Electric prior to commencing work.

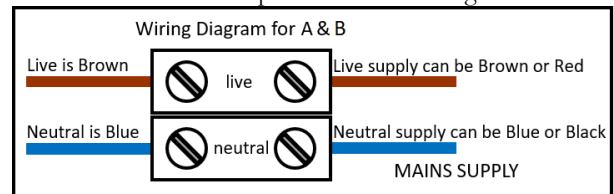

**Fig 1. Diagram showing terminal block connections**

**Light Operation**

The under-cabinet light and the internal light will switch on when activated by the external switch or the room motion sensor. The internal drawer light will stay on for approximately 20 seconds, then switch off. The internal light will switch on again when the drawer is opened or closed. It will stay lit for approximately 20 seconds regardless of drawer movement in this time.

### Installation

Mark a horizontal line on the wall at the required height **X---X**.  
Ensure that the wall brackets will fit inside the width of the cabinet and are equally spaced to ensure even distribution of weight. Secure the wall brackets to the wall using correct fixing for the wall type.

Hook the unit onto the wall brackets ensuring that the spring locks the arm into place.

To alter the position of the cabinet on the wall, adjust the two screws in each hanging bracket. Adjusting screws A will move the cabinet up and down. When the cabinet is level on the wall, screws B will tighten the cabinet to the wall.

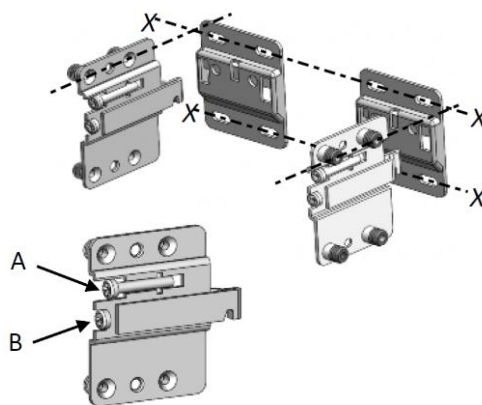

### Drawer Box Removal and Replacement

To remove the drawer box, pull the drawer fully out and lift it upwards. To re-fit the drawer box, pull the runners fully out, place the drawer box on the runners and push it rearwards until it clicks into place.

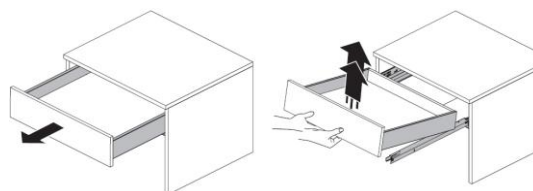

### Drawer Front Removal

Slide the drawer side covers rearwards to expose the screws. Using a crosshead screwdriver, turn the screws shown to release the drawer front.



Where there are two screws on each drawer side, turn the top screw first followed by the bottom one.



### Drawer Front Adjustment - Up and Down

Slide the drawer side covers rearwards to expose the adjustment screws. To raise or lower the drawer front, turn the larger screws with a crosshead screwdriver until adjusted as required. Turning the screws clockwise will move the drawer front upwards.

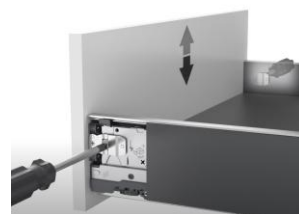

### Drawer Front Adjustment – Left to Right

Slide the drawer side covers rearwards to expose the adjustment screws. To move the drawer front from side to side, turn the smaller screws with a crosshead screwdriver until adjusted as required. Turning the screw in the right-hand side clockwise and the screw in the left-hand side anti-clockwise will move the drawer front to the right.



### **Drawer Front Adjustment - Tilt**

Slide the drawer side covers rearwards to expose the adjustment screws. Remove the caps from the tops of the drawer sides. Turning the screws clockwise with a cross-head screwdriver will tilt the drawer front backwards.



### **Care & Maintenance**

Furniture should be regularly dusted with a soft cotton or micro-fibre cloth. For more thorough cleaning, occasionally wipe your furniture with a soft cloth dampened with a mild detergent solution. Surfaces should be thoroughly dried with a lint free cloth to prevent watermarks. Under no circumstances should solvent cleaning agents, bleach or abrasive cleaning agents or cloths be used. Spills should be removed immediately using a clean cloth. All bathroom furniture will deteriorate through prolonged periods of exposure to high levels of condensation so bathrooms must be adequately ventilated using suitable extraction. Failure to ensure adequate ventilation may invalidate your guarantee.

# Installation Guide

## Lustre Toilet Unit

### Important Information

- Read the instructions carefully.
- Check the product for any signs of damage and remove any protective film.
- It is recommended that a technically competent installer undertakes installation.
- It is the installer's responsibility to carry out a thorough assessment of the wall type and the weight of the cabinet and use appropriate fixings.
- Care should be taken when drilling walls to avoid any hidden wires or pipes.

### Installation

Remove the top fascia panel first by pulling it away from the cabinet with equal force on both sides.

Remove the lower fascia by lifting it upwards.

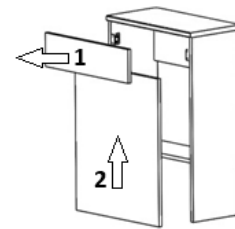

To secure the toilet unit against the wall, screw the stretcher plates to the gables of the cabinet. Ensure that the screws used are suitable for the thickness of the cabinet.

Mark the position of the holes in the stretcher plates on the wall. Drill the positions marked with a suitable drill bit. Fasten the unit in position through the stretcher plates using fixings suitable for the wall type.

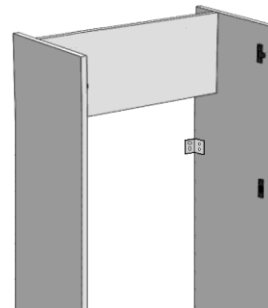

To cut the lower front panel to accommodate the toilet soil pipe and cistern flush pipe, use a jigsaw with a fine-toothed blade suitable for timber. Ensure that the room is well ventilated when cutting the material.

All cut edges must be sealed with paint, PVA glue or good quality sanitary grade silicone sealant to prevent the ingress of moisture.

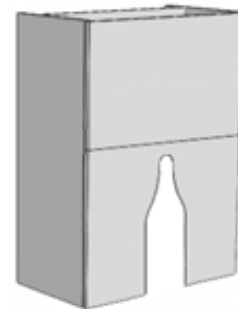

Replace the panels on the toilet unit, fitting the lower fascia first. It is good practise to run a bead of silicone where the furniture meets the floor and walls.

**Care & Maintenance**

Furniture should be regularly dusted with a soft cotton or micro-fibre cloth. For more thorough cleaning, occasionally wipe your furniture with a soft cloth dampened with a mild detergent solution. Surfaces should be thoroughly dried with a lint free cloth to prevent watermarks. Under no circumstances should solvent cleaning agents, bleach or abrasive cleaning agents or cloths be used. Spills should be removed immediately using a clean cloth. All bathroom furniture will deteriorate through prolonged periods of exposure to high levels of condensation so bathrooms must be adequately ventilated using suitable extraction. Failure to ensure adequate ventilation may invalidate your guarantee.

### Important Information

- Read the instructions carefully.
- Check the product for any signs of damage and remove any protective film.
- It is recommended that a technically competent installer undertakes installation. The electrical connections should be made by a suitably qualified Part P registered electrician in accordance with current IEE & Building Regulations.
- It is the installer's responsibility to carry out a thorough assessment of wall type and the weight of the cabinet and use appropriate fixings.
- Care should be taken when drilling walls to avoid any hidden wires or pipes.
- The terminal block (not supplied, see fig. 1) used to connect the leads to the electrical supply can be of either the screw- or screw-less type and should be rated at 240V 6A with 4 terminals. The cable tails do not need to be crimped when connected to the terminal block.
- This product should be used only with a mains supply that is protected by a Residual Current Device.
- This product is IP20 Rated and is only suitable for installation outside zones 0, 1 and 2 in a bathroom.

### Connection to Mains Electrics

1. Turn off the electrical supply.
2. The driver and leads to connect the cabinet lighting to the electrical supply in the bathroom are in the side section at the rear of the unit. Connect the mains lead from the driver for the internal light and the under-cabinet light to the electrical supply in the bathroom. It is recommended that this lead is connected to a fixed supply or a room motion sensor.
3. Turn the electrical supply back on and check that the lights function as required.

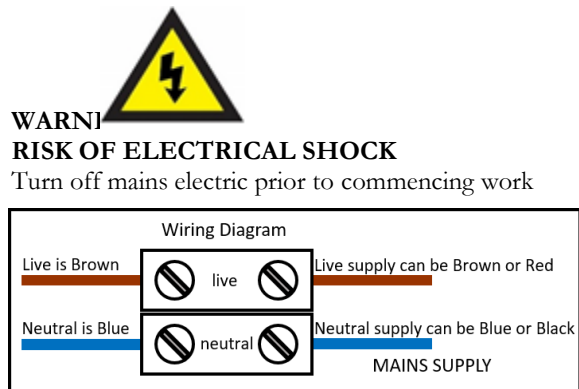
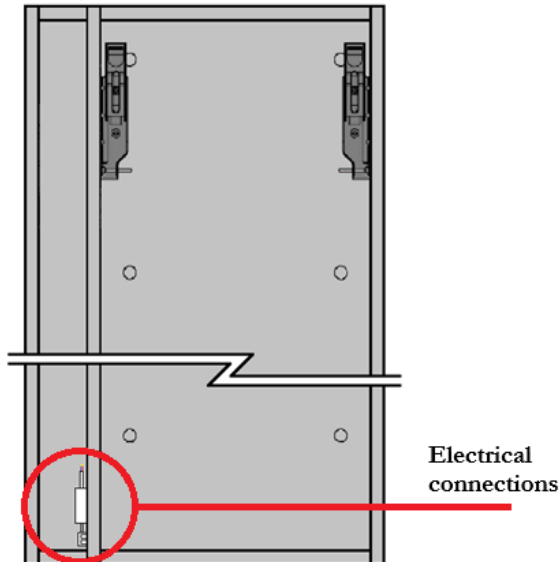

Fig 1. Diagram showing terminal block connections

### Light Operation

The under-cabinet light and the internal light will switch on when activated by the external switch or the room motion sensor. The lights will stay on for approximately 20 seconds, then switch off. The lights will switch on again when the door is opened or closed. They will stay lit for approximately 20 seconds regardless of door movement in this time.

Remove the door from the cabinet (the diagram lower down shows how to release the hinges).

It may be necessary to snap the wall plate in half at the marked line to create two wall brackets.



Mark a horizontal line on the wall at the required height X---X. Ensure that the wall brackets will fit inside the width of the cabinet and are equally spaced to ensure even distribution of weight. Secure the wall brackets to the wall using suitable fixings.

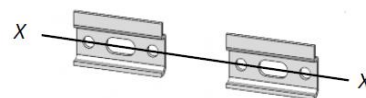

Hook the unit onto the wall brackets ensuring that the brackets are securely located.

To adjust the position of the cabinet on the wall, use the two screws in each hanging bracket. Adjusting screws B will move the cabinet up and down. When the cabinet is level on the wall, screws A will tighten the cabinet to the wall.

A further fixing should be fitted through the back of the unit into the wall. This will help to stabilise the unit.

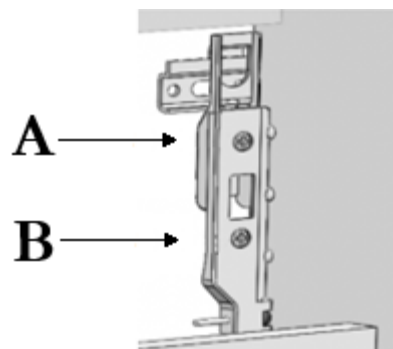

Remove the door hinges from the cabinet by pulling lever C (see the labelled diagram below).

Place the doors on a soft surface. Hook the door hinges onto the rear of the plates on the mirror glass. Push the hinge down onto the plate until you hear a click. Ensure the hinge is securely located on the plate (see diagram to the right) before fitting the doors to the cabinet.



To fit the door hinges onto the cabinet, push the hinge arm onto the mounting plate in the cabinet from the front. Push the rear of the hinge arm firmly onto the back of the plate until a click is heard. Ensure the hinges are securely fitted before use.



### Door hinge adjustment

To square the door against the cabinet, turn screws A until adjusted as required.

To adjust the door closer to or further away from the cabinet, turn screws B.

To remove the door hinges from the cabinet, pull lever C.

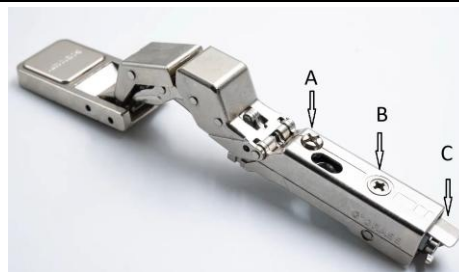

### Care & Maintenance

Furniture should be regularly dusted with a soft cotton or micro-fibre cloth. For more thorough cleaning, occasionally wipe your furniture with a soft cloth dampened with a mild detergent solution. Surfaces should be thoroughly dried with a lint free cloth to prevent watermarks. Under no circumstances should solvent cleaning agents, bleach or abrasive cleaning agents or cloths be used. Spills should be removed immediately using a clean cloth. All bathroom furniture will deteriorate through prolonged periods of exposure to high levels of condensation so bathrooms must be adequately ventilated using suitable extraction. Failure to ensure adequate ventilation may invalidate your guarantee.

Scan the QR code to  
view the installation video



## Important Information

- Read the instructions carefully.
- Check the product for any signs of damage and remove any protective film.
- It is recommended that a technically competent installer undertakes installation. The electrical connections should be made by a suitably qualified Part P registered electrician in accordance with current IEE & Building Regulations.
- It is the installer's responsibility to carry out a thorough assessment of wall type and the weight of the cabinet and use appropriate fixings.
- Care should be taken when drilling walls to avoid any hidden wires or pipes.
- The terminal block (not supplied, see fig. 1) used to connect the leads to the electrical supply can be of either the screw- or screw-less type and should be rated at 240V 6A with 4 terminals. The cable tails do not need to be crimped when connected to the terminal block.
- This product should be used only with a mains supply that is protected by a Residual Current Device.
- This product is IP20 Rated and is only suitable for installation outside zones 0, 1 and 2 in a bathroom.

### Connection to Mains Electrics

1. Turn off the electrical supply. Connect the push-fit cable from the shaver socket transformer to the cable from the rear of the shaver socket.
2. Connect the shaver socket transformer to the electrical supply in the bathroom.
3. Plug the connectors from the top light and under-cabinet light into the driver.
4. Connect the electrical supply in the bathroom to the touch switch control box. Turn the electrical supply back on and check that the lights and shaver socket function as required. A touch switch is located on the underside of the base panel to operate the lights. The sensitivity of the touch switch can be adjusted by the dial on the control box.

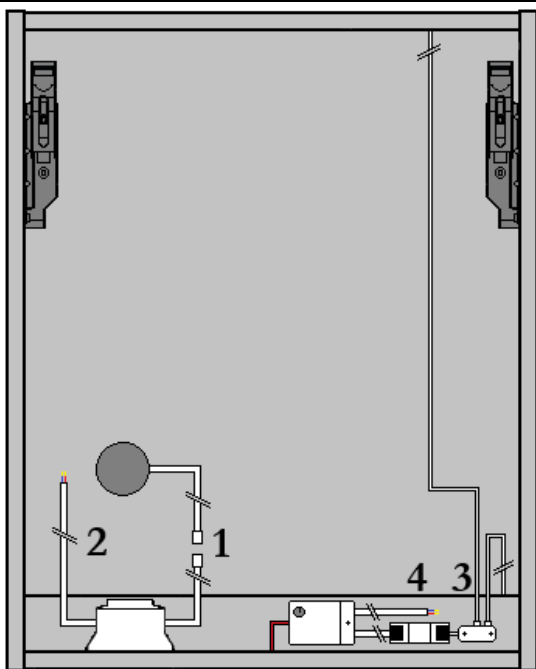

### WARNING RISK OF ELECTRIC SHOCK

Turn off mains electric prior to commencing work.

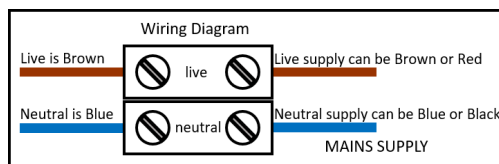

## Detail of Wiring Connections to Touch Sensor

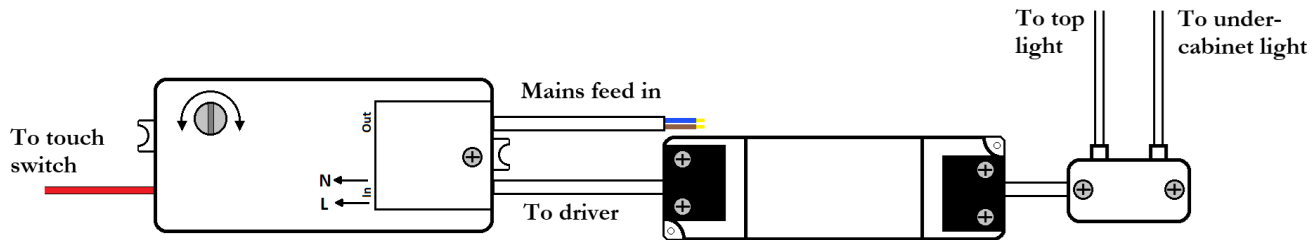

## Fitting Cabinet to Wall

Remove the door from the cabinet (the diagram lower down shows how to release the hinges).

It may be necessary to snap the wall plate in half at the marked line to create two wall brackets.



Mark a horizontal line on the wall at the required height X---X. Ensure that the wall brackets will fit inside the width of the cabinet and are equally spaced to ensure even distribution of weight. Secure the wall brackets to the wall using suitable fixings.

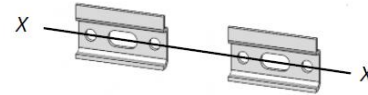

Hook the unit onto the wall brackets ensuring that the brackets are securely located.

To adjust the position of the cabinet on the wall, use the two screws in each hanging bracket. Adjusting screws B will move the cabinet up and down. When the cabinet is level on the wall, screws A will tighten the cabinet to the wall.

A further fixing should be fitted through the back of the unit into the wall. This will help to stabilise the unit.

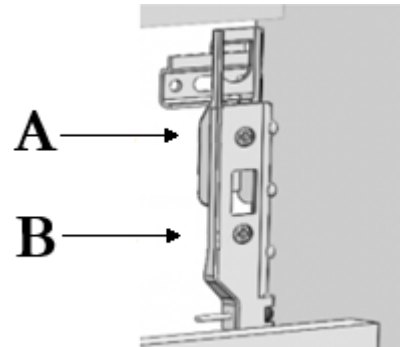

Remove the door hinges from the cabinet by pulling lever C (see the labelled diagram below).

Place the doors on a soft surface. Hook the door hinges onto the rear of the plates on the mirror glass. Push the hinge down onto the plate until you hear a click. Ensure the hinge is securely located on the plate (see diagram to the right) before fitting the doors to the cabinet.



To fit the door hinges onto the cabinet, push the hinge arm onto the mounting plate in the cabinet from the front. Push the rear of the hinge arm firmly onto the back of the plate until a click is heard. Ensure the hinges are securely fitted before use.



### Door hinge adjustment

- To square the door against the cabinet, turn screws A until adjusted as required.
- To adjust the door closer to or further away from the cabinet, turn screws B.
- To remove the door hinges from the cabinet, pull lever C.

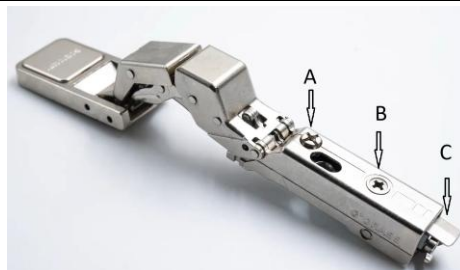

### Access to Electrical Connections

If you need to access the electrical connections, use a cross-headed screwdriver to turn the Rafix connectors in the bottom panel. Use a quarter turn anti-clockwise to release the bottom panel and pull it away from the cabinet.

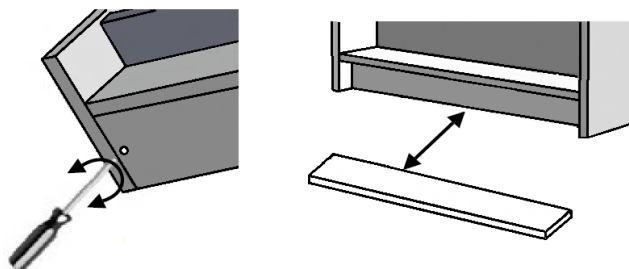

### Care & Maintenance

Furniture should be regularly dusted with a soft cotton or micro-fibre cloth. For more thorough cleaning, occasionally wipe your furniture with a soft cloth dampened with a mild detergent solution. Surfaces should be thoroughly dried with a lint free cloth to prevent watermarks. Under no circumstances should solvent cleaning agents, bleach or abrasive cleaning agents or cloths be used. Spills should be removed immediately using a clean cloth. All bathroom furniture will deteriorate through prolonged periods of exposure to high levels of condensation so bathrooms must be adequately ventilated using suitable extraction. Failure to ensure adequate ventilation may invalidate your guarantee.

Scan the QR code to  
view the installation video



## Important Information

- Read the instructions carefully.
- Check the product for any signs of damage and remove any protective film.
- It is recommended that a technically competent installer undertakes installation. The electrical connections should be made by a suitably qualified Part P registered electrician in accordance with current IEE & Building Regulations.
- It is the installer's responsibility to carry out a thorough assessment of wall type and the weight of the cabinet and use appropriate fixings.
- Care should be taken when drilling walls to avoid any hidden wires or pipes.
- The terminal block (not supplied, see fig. 1) used to connect the leads to the electrical supply can be of either the screw- or screw-less type and should be rated at 240V 6A with 4 terminals. The cable tails do not need to be crimped when connected to the terminal block.
- This product should be used only with a mains supply that is protected by a Residual Current Device.
- This product is IP20 Rated and is only suitable for installation outside zones 0, 1 and 2 in a bathroom.

## Connection to Mains Electrics

1. Turn off the electrical supply.
2. Connect the shaver socket transformer to the electrical supply in the bathroom. Connect the push-fit cable from the shaver socket transformer to the cable from the rear of the shaver socket.
3. Plug the connectors from the top light, under-cabinet light and Bluetooth speakers into the driver.
4. Connect the electrical supply in the bathroom to the touch switch control box.
5. Turn the electrical supply back on and check that the lights and shaver socket function as required. A touch switch is located on the underside of the base panel to operate the lights and Bluetooth. The sensitivity of the touch switch can be adjusted by the dial on the control box.

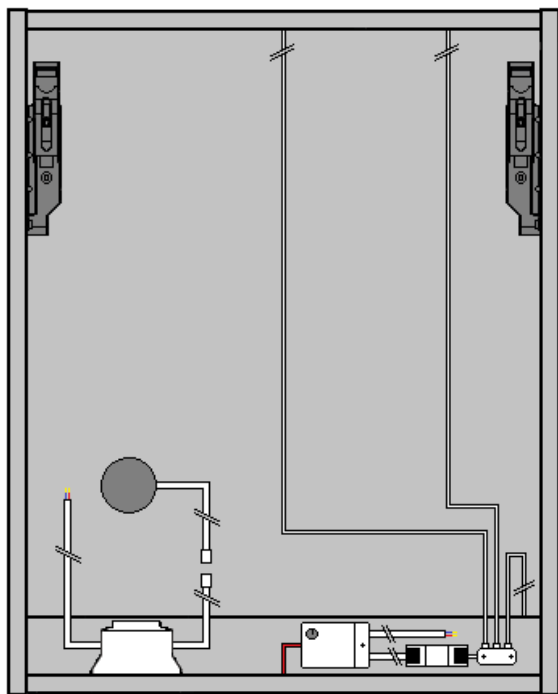

### WARNING RISK OF ELECTRIC SHOCK

Turn off mains electric prior to commencing work.

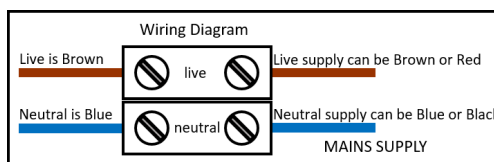

## Detail of Wiring Connections to Touch Sensor

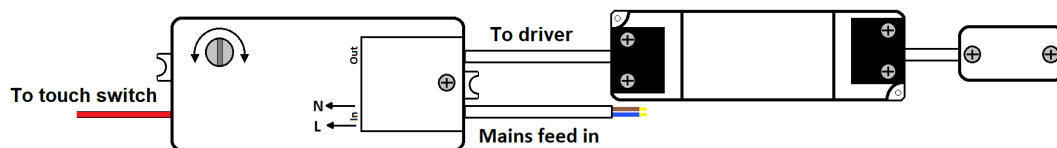

## Fitting Cabinet to Wall

Remove the door from the cabinet (the diagram lower down shows how to release the hinges).

It may be necessary to snap the wall plate in half at the marked line to create two wall brackets.



Mark a horizontal line on the wall at the required height X---X. Ensure that the wall brackets will fit inside the width of the cabinet and are equally spaced to ensure even distribution of weight. Secure the wall brackets to the wall using suitable fixings.

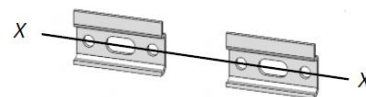

Hook the unit onto the wall brackets ensuring that the brackets are securely located.

To adjust the position of the cabinet on the wall, use the two screws in each hanging bracket. Adjusting screws B will move the cabinet up and down. When the cabinet is level on the wall, screws A will tighten the cabinet to the wall.

A further fixing should be fitted through the back of the unit into the wall. This will help to stabilise the unit.

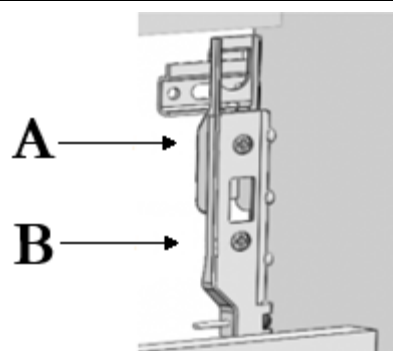

Remove the door hinges from the cabinet by pulling lever C (see the labelled diagram below).

Place the doors on a soft surface. Hook the door hinges onto the rear of the plates on the mirror glass. Push the hinge down onto the plate until you hear a click. Ensure the hinge is securely located on the plate (see diagram to the right) before fitting the doors to the cabinet.



To fit the door hinges onto the cabinet, push the hinge arm onto the mounting plate in the cabinet from the front. Push the rear of the hinge arm firmly onto the back of the plate until a click is heard. Ensure the hinges are securely fitted before use.

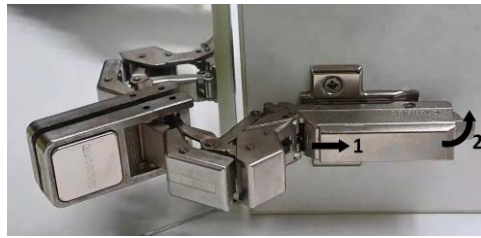

### Door hinge adjustment

To square the door against the cabinet, turn screws A until adjusted as required.

To adjust the door closer to or further away from the cabinet, turn screws B.

To remove the door hinges from the cabinet, pull lever C.



### Access to Electrical Connections

If you need to access the electrical connections, use a cross-headed screwdriver to turn the Rafx connectors in the bottom panel. Use a quarter turn anti-clockwise to release the bottom panel and pull it away from the cabinet.

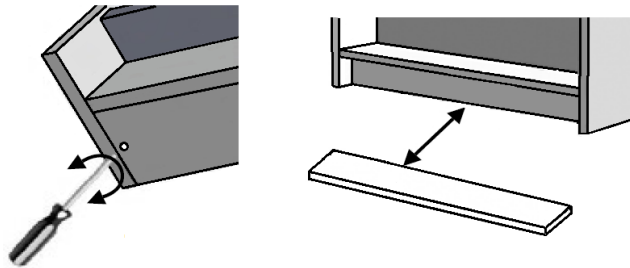

### Care & Maintenance

Furniture should be regularly dusted with a soft cotton or micro-fibre cloth. For more thorough cleaning, occasionally wipe your furniture with a soft cloth dampened with a mild detergent solution. Surfaces should be thoroughly dried with a lint free cloth to prevent watermarks. Under no circumstances should solvent cleaning agents, bleach or abrasive cleaning agents or cloths be used. Spills should be removed immediately using a clean cloth. All bathroom furniture will deteriorate through prolonged periods of exposure to high levels of condensation so bathrooms must be adequately ventilated using suitable extraction. Failure to ensure adequate ventilation may invalidate your guarantee.

Scan the QR code to  
view the installation video



### Important Information

- Read the instructions carefully.
- Ensure product contents are complete.
- Check the product for any signs of damage and remove all protective film.
- It is recommended that a technically competent installer undertakes installation.
- Care should be taken when drilling to avoid any hidden wires or pipes.
- If the panel is required to be trimmed, a fine-toothed saw should be used. Ensure that the room is well ventilated and that any cut edges are sealed with PVA glue or silicone sealant to prevent water ingression.

### Installation

Set the height of the bath to suit the height of the bath panel according to the instructions supplied with the bath. If you are installing this side panel in conjunction with an end panel, fit the end panel first according to the instructions supplied with it.

Screw three black Keku clips to the underside of the wooden batten underneath the bath rim using the screws provided. The three clips should be equally spaced along the length of the bath. Use the diagram as a guide to how the Keku clips are fitted.

The matching Keku clips should be screwed to the rear of the bath panel using the screws supplied. Measure carefully to ensure that the clips on the rear of the bath panel will engage with the clips screwed to the bath.

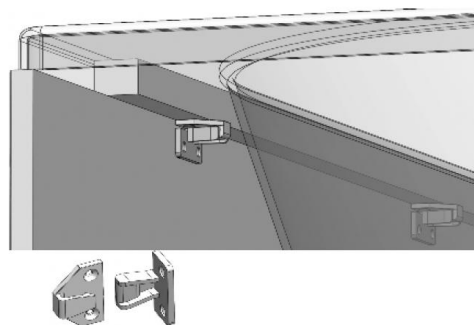

If the bath panel is being fitted between two walls, the two “L” brackets should be secured to the walls to prevent the panel from being pushed inwards. Ensure suitable fixings are used.

Once fully installed, seal around the bath panel on all joints using a good quality, sanitary-grade silicone sealant.

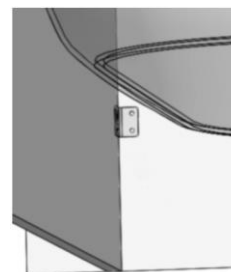

### Care & Maintenance

Furniture should be regularly dusted with a soft cotton or micro-fibre cloth. For more thorough cleaning, occasionally wipe your furniture with a soft cloth dampened with a mild detergent solution. Surfaces should be thoroughly dried with a lint free cloth to prevent watermarks. Under no circumstances should solvent cleaning agents, bleach or abrasive cleaning agents or cloths be used. Glass or mirrored panels should be cleaned using a non-solvent based glass cleaner and a soft cloth. Spills should be removed immediately using a clean cloth. All bathroom furniture will deteriorate through prolonged periods of exposure to high levels of condensation so bathrooms must be adequately ventilated using suitable extraction. Failure to ensure adequate ventilation may invalidate your guarantee.

### Important Information

- Read the instructions carefully.
- Ensure product contents are complete.
- Check the product for any signs of damage and remove all protective film.
- It is recommended that a technically competent installer undertakes installation.
- Care should be taken when drilling to avoid any hidden wires or pipes.
- If the panel is required to be trimmed, a fine-toothed saw should be used. Ensure that the room is well ventilated and that any cut edges are sealed with PVA glue or silicone sealant to prevent water ingress.

### Installation

Set the height of the bath to suit the height of the bath panel according to the instructions supplied with the bath

Fit the end panel before installing the side panel.

Secure one “L” bracket to the wall using suitable fixings. It is recommended that the bracket is fitted 300mm vertically from the underside of the bath.

Secure the second “L” bracket to the underside of the wooden batten under the bath rim using the screws provided.

Screw one of the black Keku clips to the opposite side of the end panel to the wall. The matching Keku clip should be screwed to the back of the front panel. Use the diagram as a guide to how these are fitted.

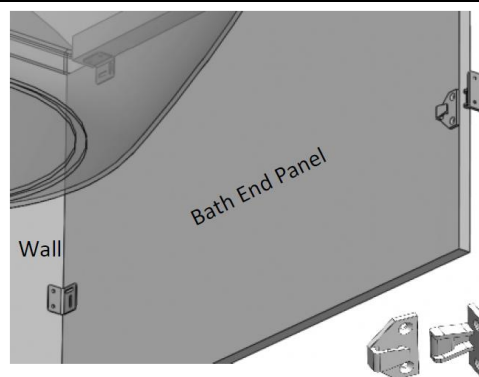

Once fully installed, seal around the bath panel on all joints using a good quality, sanitary-grade silicone sealant.

### Care & Maintenance

Furniture should be regularly dusted with a soft cotton or micro-fibre cloth. For more thorough cleaning, occasionally wipe your furniture with a soft cloth dampened with a mild detergent solution. Surfaces should be thoroughly dried with a lint free cloth to prevent watermarks. Under no circumstances should solvent cleaning agents, bleach or abrasive cleaning agents or cloths be used. Glass or mirrored panels should be cleaned using a non-solvent based glass cleaner and a soft cloth. Spills should be removed immediately using a clean cloth. All bathroom furniture will deteriorate through prolonged periods of exposure to high levels of condensation so bathrooms must be adequately ventilated using suitable extraction. Failure to ensure adequate ventilation may invalidate your guarantee.